

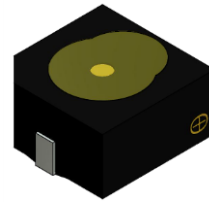

PUIaudio



Data Sheet

SMI-1027-TW-5V-R

Features:

- 5Vdc, 2700Hz magnetic indicator

Specifications

Parameters	Values	Units
Rated Voltage	5	VDC
Operating Voltage Range	4 ~ 7	VDC
Current Draw at Rated Voltage (Max)	30	mA
Minimum SPL @ 10cm	80 (typical 85)	dBA
Resonant Frequency	2700 ±300	Hz
Tone or Pulse Rate	Continuous Tone	-
Housing Material	PPS	-
Terminal Material	Tin Plated Brass	-
Weight	1.5	Grams
Acceptable Soldering Methods	Reflow Solder	See page 2 for details
Environmental Compliances	RoHS/REACH	-
Storage Temperature	-40~+85	°C
Operating Temperature	-40~+85	°C

Typical SPL and Current Draw Based on VDC Input

VOLTAGE-SOUND PRESSURE LEVEL

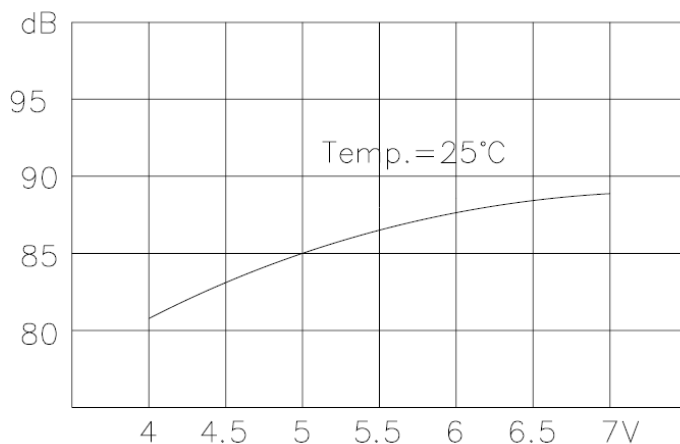

VOLTAGE-CURRENT CONSUMPTION

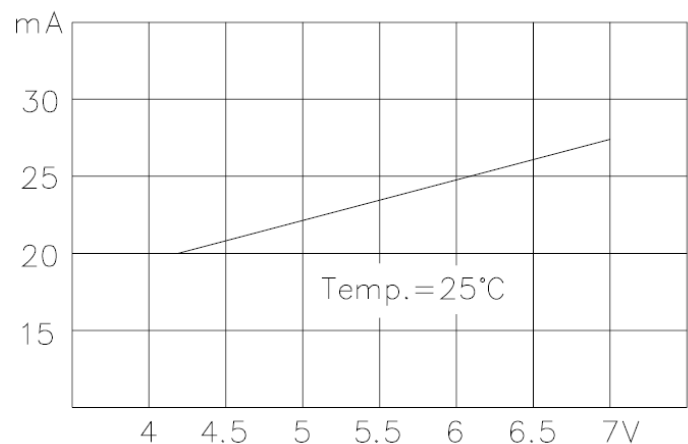

Recommended Soldering Procedure

One Reflow Cycle Only

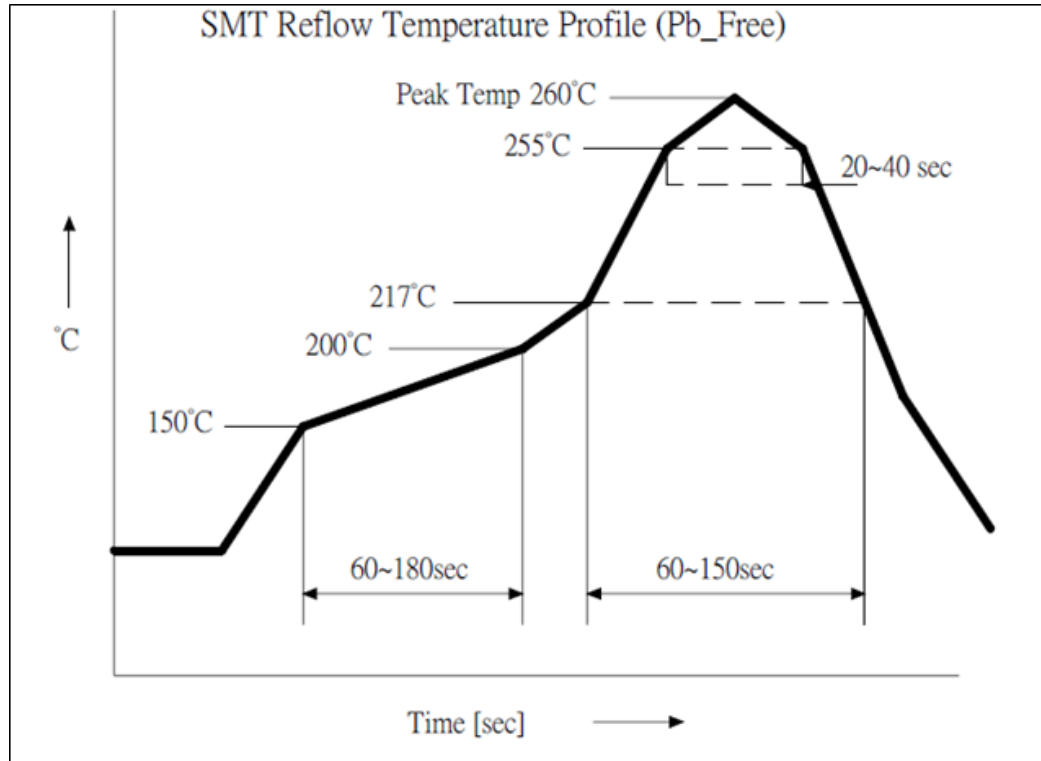

Reliability Testing

Type of Test	Test Specifications
High Temperature Test	96 hours at +85°C
Low Temperature Test	96 hours at -40°C
Temperature Cycle and Humidity Test	<p>Ten 24-hour cycles consisting of the following:</p> <p> +85°C +25°C a: 3hrs b: 12±0.5hrs c: 3hrs 24hours a,b : 90~98%RH c : 80~98%RH </p>
Operating Life Test	<p>1. Continuous life test - The part shall be subjected to 72 hours at +70°C with 12VDC applied.</p> <p>2. Intermittent life test - A duty cycle of 1 minute on, 1 minute off, a minimum of 10000 times at room temp. (25±10°C) with 12.0VDC applied.</p>

After testing, the part shall be without any degradation in appearance or performance except SPL. After 4 hours at +25°C, the SPL shall measure ±10 dBA compared to initial measurement.

Dimensions

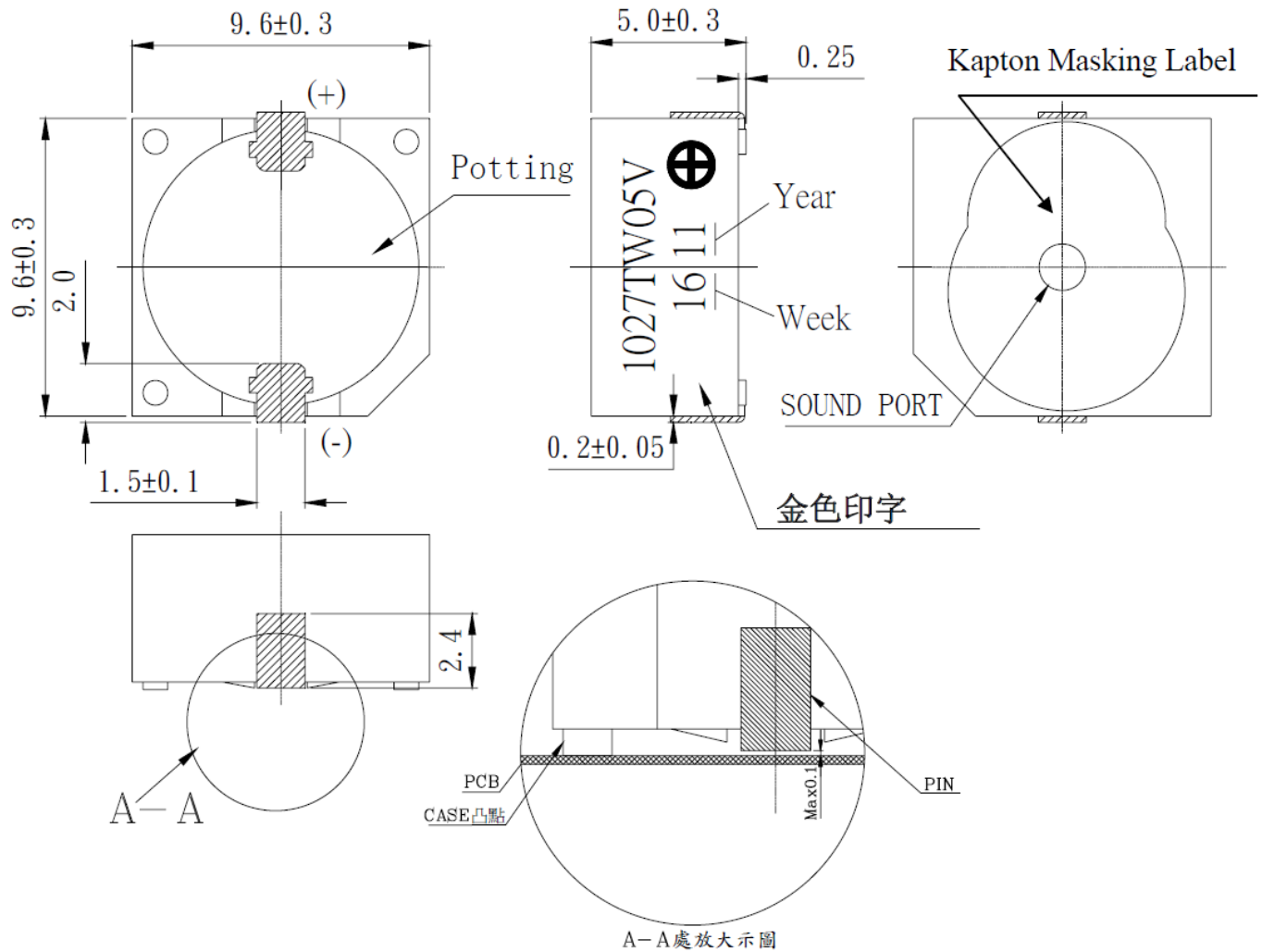

Suggested Land Pattern*

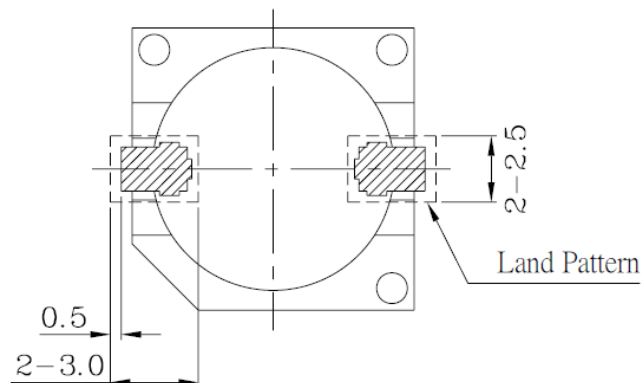

*This land pattern is advisory only and its use or adaptation is entirely voluntary. PUI Audio disclaims all liability of any kind associated with the use, application, or adaptation of this land pattern.

Packaging

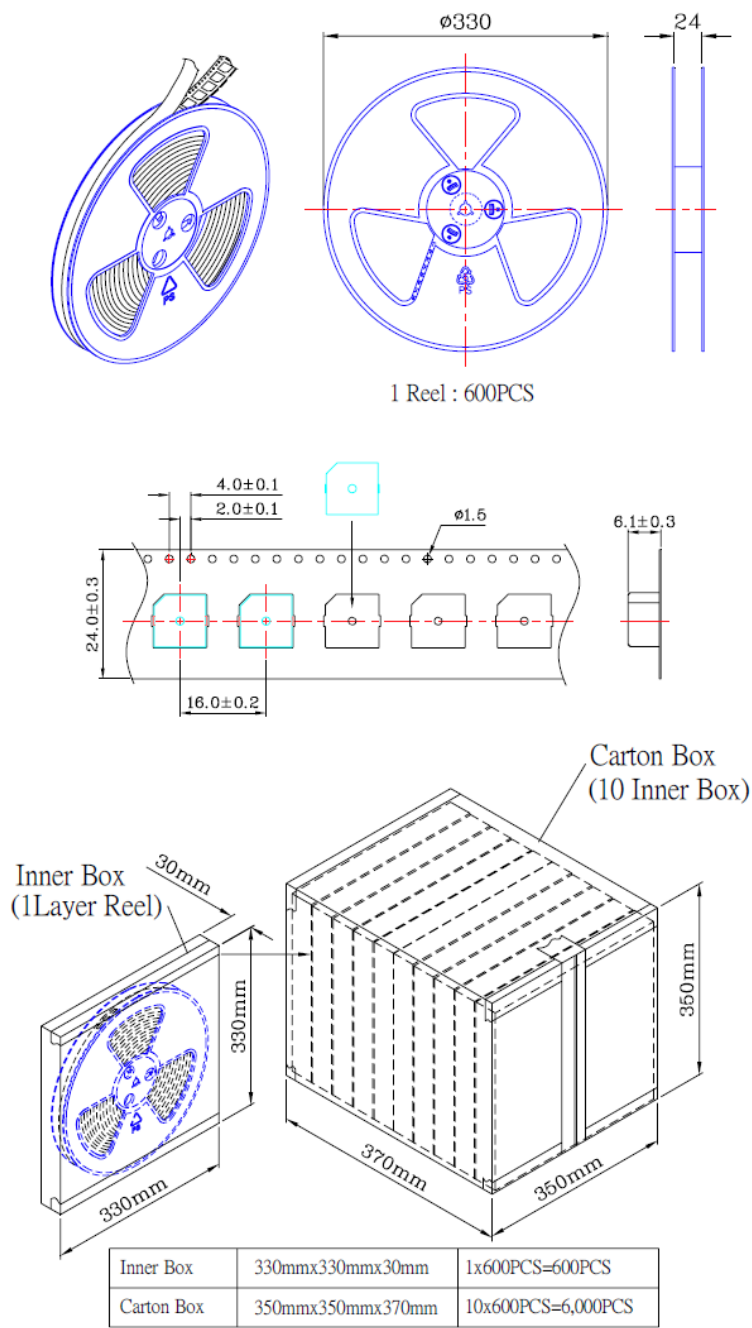

Specifications Revisions

Revision	Description	Date
A	Released from Engineering	11/11/2014

Note:

1. Unless otherwise specified:
 - A. All dimensions are in millimeters.
 - B. Default tolerances are $\pm 0.5\text{mm}$ and angles are $\pm 3^\circ$.
2. Specifications subject to change or withdrawal without notice.