

- NOTES:**
- ELECTRICAL:**
- VOLTAGE RATING : 125 VAC RMS.
 - CURRENT RATING : 1.5 AMP.
 - CONTACT RESISTANCE : 30 MILLIOHMS MAX.
 - INSULATION RESISTANCE: 1000 MEGOHMS MIN @ 500 VDC.
 - DIELECTRIC STRENGTH : 1000 VAC RMS 60Hz, 1MIN.
 - LED RATINGS: FORWARD VOLTAGE: 2.2 VOLTS TYPICAL.
REVERSE VOLTAGE: 5 VOLTS MINIMUM.
 - OPERATING: 750 CYCLES MIN.
- MECHANICAL:**
- HOUSING MATERIAL : GLASS FILLED NYLON UL94-0 COLOR-BLACK
 - INSERT MATERIAL : GLASS FILLED NYLON UL94-0 COLOR-BLACK
 - BACK PLATE MATERIAL : GLASS FILLED NYLON UL94-0 COLOR-BLACK
 - LED SIZE : 3.2*2.0*7.0*P=2.54mm.
 - SHIELD MATERIAL : GOLD PLATING OVER NICKEL.
 - CONTACT MATERIAL : COPPER ALLOY 0.25mm THICKNESS PLATING NI.
 - PLATING : PHOSPHOR BRONZE 0.35mm THICKNESS OR Ø0.46mm.
 - PCB RETENTION PRE-SOLDER : 1 LB MIN.
 - PCB RETENTION POST-SOLDER: 10 LBS MIN.
- ENVIRONMENTAL:**
- STORAGE TEMPERATURE : -40°C TO +85°C.
 - OPERATION TEMPERATURE: -40°C TO +85°C.
 - WAVE SOLDERING TEMPERATURE: 255~265° (5~10 SECONDS)
 - RoHS COMPLIANT.
- MATES WITH MODULAR PLUG CONFORMING TO FCC PART 68, SUBPART F.
 CUL FILE No:E163191

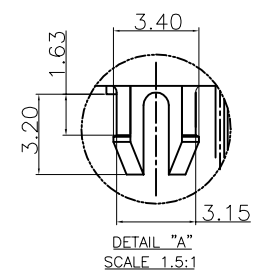
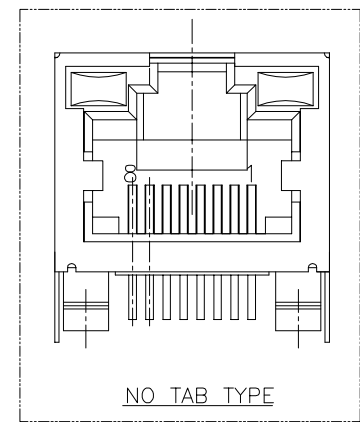

PART NUMBER	LED COLOR		TAB	GOLD PLATING
	LED 1	LED 2		
E5J88-11LJ22-L	GREEN	YELLOW	NO TAB	6u"
E5J88-14LJ22-L	GREEN	YELLOW	TOP TABS & SIDE TABS	6u"
E5J88-14LJ23-L	GREEN	YELLOW	TOP TABS & SIDE TABS	15u"
E5J88-21LJ22-L	GREEN	GREEN	NO TAB	6u"
E5J88-31LJ22-L	YELLOW	GREEN	NO TAB	6u"
E5J88-31LJ23-L	YELLOW	GREEN	NO TAB	15u"
E5J88-34LJ22-L	YELLOW	GREEN	TOP TABS & SIDE TABS	6u"
E5J88-34LJ23-L	YELLOW	GREEN	TOP TABS & SIDE TABS	15u"
E5J88-54LJ22-L	RED	GREEN	TOP TABS & SIDE TABS	6u"

DETACHED LISTS	← MM (INCH) →	RoHS Compliant		
	TOLERANCES EXCEPT AS NOTED	TITLE		
	.0 ± 0.2 .00 ± 0.15 .000 ± 0.075 ANGLES ± 0.5	RJ45 SIDE ENTRY LED JACK	DFTO Cathy DATE 2006/09/20 SCALE : 3:1	DRAWING NO. CE5J3015-LA /PART NO. SEE TABLE DO NOT SCALE DRAWING

SHEET 1 OF 1

Mouser Electronics

Authorized Distributor

Click to View Pricing, Inventory, Delivery & Lifecycle Information:

Pulse:

[E5J88-34LJ23-L](#) [E5J88-14LJ22-L](#)