

Illuminated pushbutton Ø 22 mm stainless steel 304, with
symbol

82-6151.1A34.B002



<https://eao.com/p/82-6151.1A34.B002>

Your product:



82-6151.1A34.B002

Illuminated pushbutton Ø 22 mm
stainless steel 304, with symbol

FRONT

Front bezel material:	Stainless steel
Front form:	round
Front bezel shape:	flush
Front dimension:	Ø 25 mm

MOUNTING

Mounting type:	Panel mounting
Mounting cut-out:	Ø 22 mm

OPERATING-/INDICATION PART

Lens material:	Plastic metalised
Symbol:	Standby
Lens shape:	flush
Lens colour:	Silver
Shape of illumination:	Symbol
Lens illumination:	illuminative
Illumination colour:	Green
Lens optics:	opaque

ELECTRICAL CHARACTERISTICS

Rated Operational Voltage Ue:	250 VAC
Rated insulation voltage Ui:	250 V

Operating voltage:	24 V DC																						
Contacts:	1 C																						
Thermal current I_{th}:	5 A																						
Electric strength:	1500 VAC, 50 Hz 1 minute between life terminals and ground																						
Switching voltage and switching current:	<div>according to IEC 60947-5-1 (Silver contacts)</div> <div>Service categorie AC-15</div> <table><tr><td>Voltage</td><td>Current</td></tr><tr><td>24 VAC</td><td>1 A</td></tr><tr><td>35 VAC</td><td>1 A (M12 versio</td></tr><tr><td>110 VAC</td><td>1 A</td></tr><tr><td>220 VAC</td><td>0.5 A</td></tr></table> <div>Switch rating DC service categorie DC-13 (Silver contacts)</div> <table><tr><td>Voltage</td><td>Current</td></tr><tr><td>24 VDC</td><td>0.7 A</td></tr><tr><td>35 VDC</td><td>0.5 A (M12 vers</td></tr><tr><td>110 VDC</td><td>0.2 A</td></tr><tr><td>220 VDC</td><td>0.1 A</td></tr></table>			Voltage	Current	24 VAC	1 A	35 VAC	1 A (M12 versio	110 VAC	1 A	220 VAC	0.5 A	Voltage	Current	24 VDC	0.7 A	35 VDC	0.5 A (M12 vers	110 VDC	0.2 A	220 VDC	0.1 A
Voltage	Current																						
24 VAC	1 A																						
35 VAC	1 A (M12 versio																						
110 VAC	1 A																						
220 VAC	0.5 A																						
Voltage	Current																						
24 VDC	0.7 A																						
35 VDC	0.5 A (M12 vers																						
110 VDC	0.2 A																						
220 VDC	0.1 A																						
	<div>according to UL 508 (Silver contacts)</div> <div>cosφ 0,75 ... 0,8</div> <table><tr><td>Voltage</td><td>Current</td></tr><tr><td>120 VAC</td><td>5 A</td></tr><tr><td>240 VAC</td><td>3 A</td></tr><tr><td>24 VAC</td><td>1 A</td></tr></table>			Voltage	Current	120 VAC	5 A	240 VAC	3 A	24 VAC	1 A												
Voltage	Current																						
120 VAC	5 A																						
240 VAC	3 A																						
24 VAC	1 A																						
Electrical lifetime:	50 000 cycles of operation																						
Pollution degree:	2, according to EN IEC 60947-1																						
Operation current:	7 mA																						

MECHANICAL CHARACTERISTIC

Terminal:	Soldering terminal, 2.8 x 0.5 mm
Switching action:	Momentary
Operating force:	4 N ... 7 N
Mechanical lifetime:	1 Mio. cycles of operation
Operating Travel:	ca. 3 mm
Switching system:	Snap-action switching element
Weight:	0.025 kg
Tightening torque:	0.5 ... 0.6 Nm
Contact material:	Silver

AMBIENT CONDITION

Vibration resistance:	10 ... 500 Hz, amplitude 1.5 mm p-p according to IEC 60068-2-6
Shock resistance:	

Max. 500 m / s² as per IEC 60068-2-27

IP front protection: IP65, IP67

Storage temperature: – 40 °C ... + 80 °C

Operating temperature: – 30 °C ... + 70 °C

Climate resistance: Damp heat, 21 days according to IEC 60512-11

CERTIFICATE

REACH: REACH compliant

Approbations: CB, CCC, C UL, UL

RoHS: RoHS compliant

Conformities: CE, 2011 / 65 / EC (RoHS), 2014 / 35 / EU (LVD)

OTHER

Kind of illumination: Single-LED

Short Description: Illuminated pushbutton Ø 22 mm stainless steel 304, with symbol, Momentary, 24 V DC, 1 C, Soldering terminal, 2.8 x 0.5 mm, round, Stainless steel, Green, Standby, Silver

Wiring diagrams:

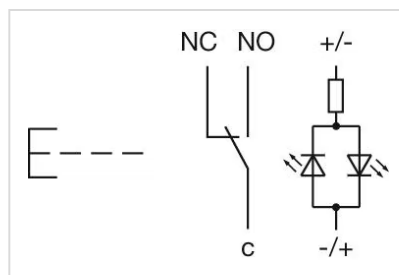

Dimension drawings:

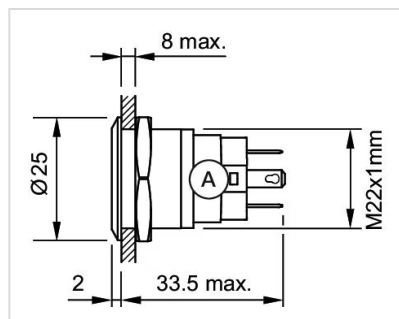

Component layouts:



Mounting cut-outs:

