

Illuminated pushbutton Ø 22 mm silver contact

82-6152.2114.B001



<https://eao.com/p/82-6152.2114.B001>

Your product:



82-6152.2114.B001

Illuminated pushbutton Ø 22 mm silver contact

FRONT

Front form:	round
Front dimension:	Ø 25 mm
Front bezel shape:	flush
Front bezel material:	Stainless steel

MOUNTING

Mounting type:	Panel mounting
Mounting cut-out:	Ø 22 mm

OPERATING-/INDICATION PART

Illumination colour:	Red
Lens shape:	flush
Lens illumination:	illuminative
Lens optics:	opaque
Shape of illumination:	Ring
Symbol:	ON/OFF
Lens colour:	Silver
Lens material:	Stainless steel

ELECTRICAL CHARACTERISTICS

Pollution degree:	2, according to EN IEC 60947-1
Operation current:	7 mA

Electric strength:	1500 VAC, 50 Hz 1 minute between life terminals and ground		
Rated Operational Voltage Ue:	250 VAC		
Contacts:	1 C		
Switching voltage and switching current:	according to IEC 60947-5-1 (Silver contacts) Service categorie AC-15 Voltage 24 VAC 35 VAC 110 VAC 220 VAC Switch rating DC service categorie DC-13 (Silver contacts) Voltage 24 VDC 35 VDC 110 VDC 220 VDC		
			Current 1 A 1 A (M12 versio 1 A 0.5 A Current 0.7 A 0.5 A (M12 vers 0.2 A 0.1 A
	according to UL 508 (Silver contacts) cosφ 0,75 ... 0,8 Voltage 120 VAC 240 VAC 24 VAC		
		Current	5 A 3 A 1 A
Thermal current Ith:	5 A		
Operating voltage:	24 V AC/DC		
Electrical lifetime:	50 000 cycles of operation		
Rated insulation voltage Ui:	250 V		

MECHANICAL CHARATERISTIC

Mechanical lifetime:	500 000 cycles of operation
Operating force:	4 N ... 7 N
Tightening torque:	0.5 ... 0.6 Nm, Screw terminal 0.1 Nm
Contact material:	Silver
Weight:	0.018 kg
Switching action:	Maintained
Terminal:	Screw terminal
Operating Travel:	ca. 3 mm
Switching system:	Snap-action switching element

AMBIENT CONDITION

Shock resistance:	Max. 500 m / s ² as per IEC 60068-2-27
Climate resistance:	

Damp heat, 21 days according to IEC 60512-11

IP front protection: IP65, IP67

Operating temperature: – 30 °C ... + 70 °C

Vibration resistance: 10 ... 500 Hz, amplitude 1.5 mm p-p according to IEC 60068-2-6

Storage temperature: – 40 °C ... + 80 °C

CERTIFICATE

Approbations: CB, CCC, C UL, UL

Conformities: CE, 2011 / 65 / EC (RoHS), 2014 / 35 / EU (LVD)

REACH: REACH compliant

RoHS: RoHS compliant

OTHER

Short Description: Illuminated pushbutton Ø 22 mm silver contact, Maintained, 24 V AC/DC, 1 C, Screw terminal, round, Stainless steel, Red, ON/OFF, Silver

Kind of illumination: Single-LED

Mounting cut-outs:

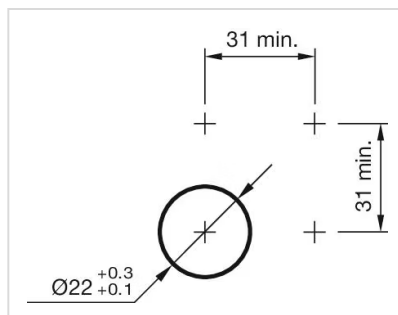

Wiring diagrams:

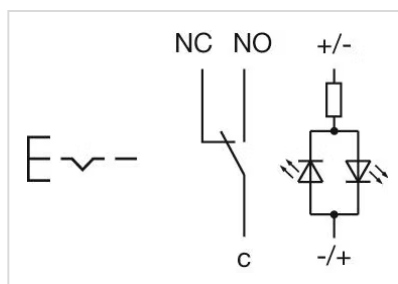

Dimension drawings:

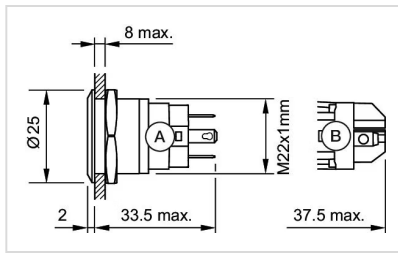

A = Solder terminal
B = Screw terminal

Component layouts:

