

Illuminated pushbutton Ø 22 mm stainless steel 316L

82-6651.2114



<https://eao.com/p/82-6651.2114>

Your product:



82-6651.2114

Illuminated pushbutton Ø 22 mm stainless steel 316L

FRONT

Front form:	round
Front bezel shape:	flush
Front bezel material:	Stainless steel 316L
Front dimension:	Ø 25 mm

MOUNTING

Mounting type:	Panel mounting
Mounting cut-out:	Ø 22 mm

OPERATING-/INDICATION PART

Illumination colour:	Red
Lens colour:	Silver
Lens illumination:	illuminative
Lens material:	Stainless steel 316L
Lens optics:	opaque
Lens shape:	flush
Shape of illumination:	Ring (Tritan)

ELECTRICAL CHARACTERISTICS

Switching rating:	36 V AC/DC @ 0,6 A
Contacts:	1 C
Electric strength:	1500 VAC, 50 Hz 1 minute between life terminals and ground

Thermal current I_{th}:	5 A
Pollution degree:	2, according to EN IEC 60947-1
Operating voltage:	24 V DC (LED)
Electrical lifetime:	50 000 cycles of operation
Rated Operational Voltage U_e:	250 VAC
Rated insulation voltage U_i:	250 V
Operation current:	7 mA

MECHANICAL CHARACTERISTIC

Tightening torque:	0.5 ... 0.6 Nm
Switching system:	Snap-action switching element
Mechanical lifetime:	500 000 cycles of operation
Contact material:	Silver
Weight:	0.016 kg
Operating Travel:	ca. 3 mm
Operating force:	4 N ... 7 N
Terminal:	Plug-in terminal, 2.8 x 0.5 mm
Switching action:	Maintained

AMBIENT CONDITION

Vibration resistance:	10 ... 500 Hz, amplitude 1.5 mm p-p according to IEC 60068-2-6
Storage temperature:	– 40 °C ... + 80 °C
Shock resistance:	Max. 500 m / s ² as per IEC 60068-2-27
IP front protection:	IP65, IP67
Operating temperature:	– 30 °C ... + 70 °C
Climate resistance:	Damp heat, 21 days according to IEC 60512-11

CERTIFICATE

Approbations:	CB, CCC, C UL, UL
Conformities:	CE, 2011 / 65 / EC (RoHS), 2014 / 35 / EU (LVD)
RoHS:	RoHS compliant
REACH:	REACH compliant

OTHER

Short Description: Illuminated pushbutton Ø 22 mm stainless steel 316L, Maintained, 36 V AC/DC @ 0,6 A, 24 V DC (LED), 1 C, Plug-in terminal, 2.8 x 0.5 mm, round, Stainless steel 316L, Red, Silver

Kind of illumination: Single-LED

Hints: Switching voltage: max. 36 V AC/1A, max. 36 V DC/0.6

Component layouts:

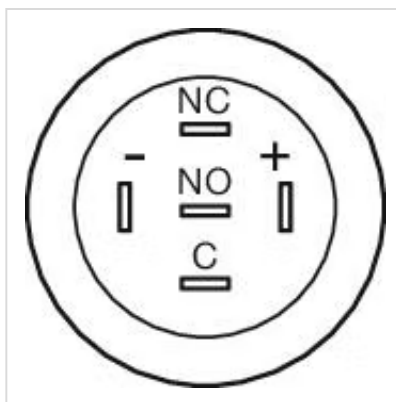

Dimension drawings:

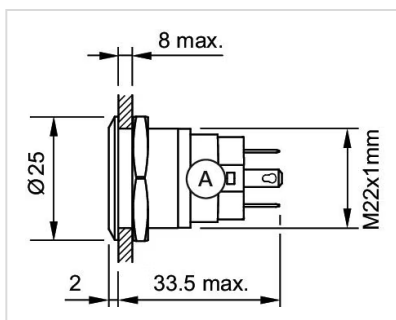

Wiring diagrams:

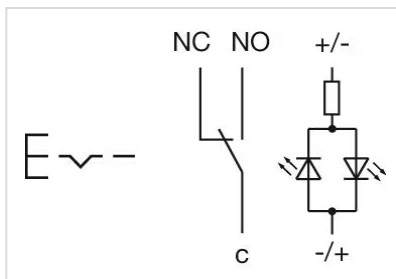

Mounting cut-outs:

