

Pushbutton Ø 22 mm silver contact

82-6571.2000



<https://eao.com/p/82-6571.2000>

Your product:



82-6571.2000

Pushbutton Ø 22 mm silver contact

FRONT

Front form:	round
Front dimension:	Ø 25 mm
Front bezel material:	Aluminium
Front bezel shape:	flush

MOUNTING

Mounting type:	Panel mounting
Mounting cut-out:	Ø 22 mm

OPERATING-/INDICATION PART

Lens optics:	opaque
Lens illumination:	non illuminative
Lens shape:	convex
Lens material:	Aluminium
Lens colour:	Nature

ELECTRICAL CHARACTERISTICS

Pollution degree:	2, according to EN IEC 60947-1
Rated insulation voltage U_i :	250 V
Electric strength:	1500 VAC, 50 Hz 1 minute between life terminals and ground
Switching voltage and switching current:	

according to IEC 60947-5-1 (Silver contacts)

Service categorie AC-15

Voltage

24 VAC

35 VAC

110 VAC

220 VAC

Current

1 A

1 A (M12 version)

1 A

0.5 A

Switch rating DC service categorie DC-13 (Silver contacts)

Voltage

24 VDC

35 VDC

110 VDC

220 VDC

Current

0.7 A

0.5 A (M12 version)

0.2 A

0.1 A

according to UL 508 (Silver contacts)

$\cos\phi$ 0,75 ... 0,8

Voltage

120 VAC

240 VAC

24 VAC

Current

5 A

3 A

1 A

Electrical lifetime: 50 000 cycles of operation

Thermal current I_{th}: 5 A

Contacts: 1 C

Rated Operational Voltage U_e: 250 VAC

MECHANICAL CHARATERISTIC

Switching action: Maintained

Terminal: Soldering terminal, 2.8 x 0.5 mm

Operating Travel: ca. 3 mm

Contact material: Silver

Operating force: 4 N ... 7 N

Switching system: Snap-action switching element

Tightening torque: 0.5 ... 0.6 Nm

Mechanical lifetime: 500 000 cycles of operation

Weight: 0.019 kg

AMBIENT CONDITION

Climate resistance: Damp heat, 21 days according to IEC 60512-11

Operating temperature: – 30 °C ... + 70 °C

Vibration resistance: 10 ... 500 Hz, amplitude 1.5 mm p-p according to IEC 60068-2-6

Shock resistance: Max. 500 m / s² as per IEC 60068-2-27

Storage temperature:

– 40 °C ... + 80 °C

IP front protection:

IP65, IP67

CERTIFICATE

Conformities:

CE, 2011 / 65 / EC (RoHS), 2014 / 35 / EU (LVD)

Approbations:

CB, CCC, C UL, UL

REACH:

REACH compliant

RoHS:

RoHS compliant

OTHER

Short Description:

Pushbutton Ø 22 mm silver contact, Maintained, 1 C, Soldering terminal, 2.8 x 0.5 mm, round, Aluminium, Nature

Mounting cut-outs:

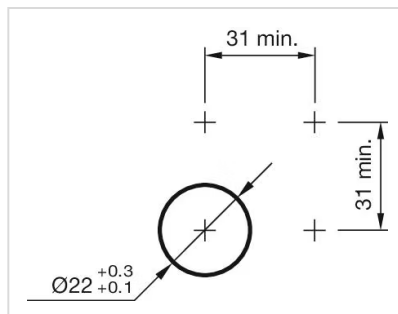

Dimension drawings:

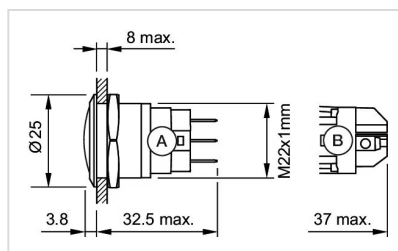

A = Solder terminal
B = Screw terminal

Wiring diagrams:

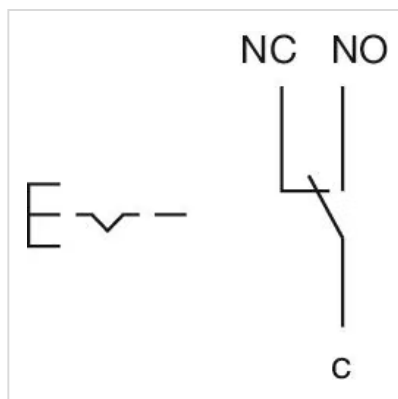

Component layouts:

