

# Illuminated pushbutton Ø 16 mm silver contact

82-4152.1124



<https://eao.com/p/82-4152.1124>

Your product:

---



82-4152.1124

Illuminated pushbutton Ø  
16 mm silver contact

#### FRONT

Front bezel shape:	flush
Front form:	round
Front bezel material:	Stainless steel
Front dimension:	Ø 18 mm

#### MOUNTING

Mounting cut-out:	Ø 16 mm
Mounting type:	Panel mounting

#### OPERATING-/INDICATION PART

Lens material:	Stainless steel
Lens optics:	opaque
Lens illumination:	illuminative
Lens colour:	Silver
Illumination colour:	Blue
Shape of illumination:	Ring
Lens shape:	flush

#### ELECTRICAL CHARACTERISTICS

Operation current:	7 mA
Rated Operational Voltage U <sub>e</sub> :	250 VAC
Operating voltage:	24 V AC/DC

<b>Contacts:</b>	1 C		
<b>Thermal current I<sub>th</sub>:</b>	5 A		
<b>Rated insulation voltage U<sub>i</sub>:</b>	250 V		
<b>Electric strength:</b>	1500 VAC, 50 Hz 1 minute between life terminals and ground		
<b>Switching voltage and switching current:</b>	according to IEC 60947-5-1 (Silver contacts) Service categorie AC-15 Voltage 24 VAC 35 VAC 110 VAC 220 VAC Switch rating DC service categorie DC-13 (Silver contacts) Voltage 24 VDC 35 VDC 110 VDC 220 VDC		
			Current 1 A 1 A (M12 versio 1 A 0.5 A
			Current 0.7 A 0.5 A (M12 vers 0.2 A 0.1 A
	according to UL 508 (Silver contacts) cosφ 0,75 ... 0,8 Voltage 120 VAC 240 VAC 24 VAC	Current 5 A 3 A 1 A	
<b>Electrical lifetime:</b>	50 000 cycles of operation		
<b>Pollution degree:</b>	2, according to EN IEC 60947-1		

## MECHANICAL CHARACTERISTIC

<b>Tightening torque:</b>	0.5 ... 0.6 Nm, Screw terminal 0.1 Nm
<b>Weight:</b>	0.018 kg
<b>Operating force:</b>	4 N ... 7 N
<b>Operating Travel:</b>	ca. 3 mm
<b>Mechanical lifetime:</b>	1 Mio. cycles of operation
<b>Terminal:</b>	Screw terminal
<b>Switching system:</b>	Snap-action switching element
<b>Switching action:</b>	Momentary
<b>Contact material:</b>	Silver

## AMBIENT CONDITION

<b>Vibration resistance:</b>	10 ... 500 Hz, amplitude 1.5 mm p-p according to IEC 60068-2-6
<b>Climate resistance:</b>	Damp heat, 21 days according to IEC 60512-11
<b>Operating temperature:</b>	

– 30 °C ... + 70 °C

**IP front protection:**

IP65, IP67

**Storage temperature:**

– 40 °C ... + 80 °C

**Shock resistance:**

Max. 500 m / s<sup>2</sup> as per IEC 60068-2-27

## CERTIFICATE

**Conformities:**

CE, 2011 / 65 / EC (RoHS), 2014 / 35 / EU (LVD)

**REACH:**

REACH compliant

**RoHS:**

RoHS compliant

**Approbations:**

CB, CCC, C UL, UL

## OTHER

**Short Description:**

Illuminated pushbutton Ø 16 mm silver contact, Momentary, 24 V AC/DC, 1 C, Screw terminal, round, Stainless steel, Blue, Silver

**Kind of illumination:**

Single-LED

**Component layouts:**

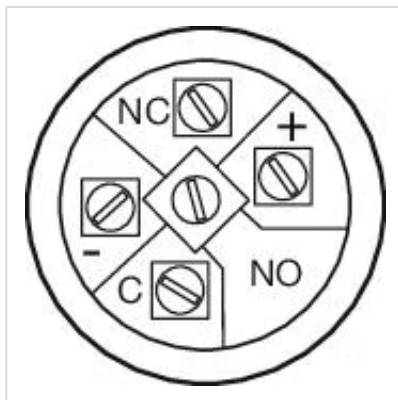

**Wiring diagrams:**

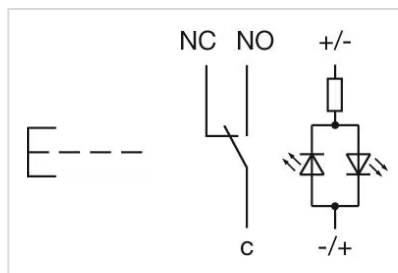

**Mounting cut-outs:**

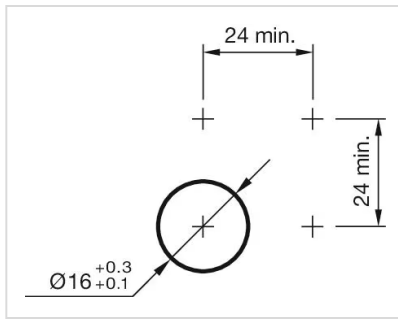

**Dimension drawings:**

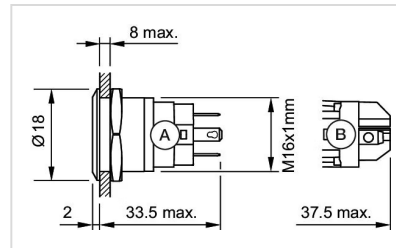

A = Solder terminal  
B = Screw terminal