

Illuminated pushbutton Ø 19 mm silver contact

82-5151.2114.B002



<https://eao.com/p/82-5151.2114.B002>

Your product:



82-5151.2114.B002 Illuminated pushbutton Ø 19 mm silver contact

FRONT

Front form:	round
Front bezel shape:	flush
Front dimension:	Ø 22 mm
Front bezel material:	Stainless steel

MOUNTING

Mounting type:	Panel mounting
Mounting cut-out:	Ø 19 mm

OPERATING-/INDICATION PART

Lens shape:	flush
Symbol:	Standby
Lens optics:	opaque
Lens colour:	Silver
Lens illumination:	illuminative
Illumination colour:	Red
Lens material:	Stainless steel
Shape of illumination:	Ring

ELECTRICAL CHARACTERISTICS

Operating voltage:	24 V DC
Electric strength:	1500 VAC, 50 Hz 1 minute between life terminals and ground

Contacts:	1 C	
Pollution degree:	2, according to EN IEC 60947-1	
Electrical lifetime:	50 000 cycles of operation	
Thermal current I_{th}:	5 A	
Rated insulation voltage U_i:	250 V	
Operation current:	7 mA	
Rated Operational Voltage U_e:	250 VAC	
Switching voltage and switching current:	according to IEC 60947-5-1 (Silver contacts) Service categorie AC-15	
	Voltage	Current
	24 VAC	1 A
	35 VAC	1 A (M12 versio
	110 VAC	1 A
	220 VAC	0.5 A
	Switch rating DC service categorie DC-13 (Silver contacts)	
	Voltage	Current
	24 VDC	0.7 A
	35 VDC	0.5 A (M12 vers
	110 VDC	0.2 A
	220 VDC	0.1 A
	according to UL 508 (Silver contacts)	
	cosφ 0,75 ... 0,8	
	Voltage	Current
	120 VAC	5 A
	240 VAC	3 A
	24 VAC	1 A

MECHANICAL CHARACTERISTIC

Mechanical lifetime:	500 000 cycles of operation
Tightening torque:	0.5 ... 0.6 Nm
Operating force:	4 N ... 7 N
Switching system:	Snap-action switching element
Switching action:	Maintained
Terminal:	Soldering terminal, 2.8 x 0.5 mm
Operating Travel:	ca. 3 mm
Contact material:	Silver
Weight:	0.018 kg

AMBIENT CONDITION

Storage temperature:	- 40 °C ... + 80 °C
Vibration resistance:	

10 ... 500 Hz, amplitude 1.5 mm p-p according to IEC 60068-2-6

Climate resistance: Damp heat, 21 days according to IEC 60512-11

IP front protection: IP65, IP67

Shock resistance: Max. 500 m / s² as per IEC 60068-2-27

Operating temperature: - 30 °C ... + 70 °C

CERTIFICATE

REACH: REACH compliant

RoHS: RoHS compliant

Conformities: CE, 2011 / 65 / EC (RoHS), 2014 / 35 / EU (LVD)

Approbations: CB, CCC, C UL, UL

OTHER

Kind of illumination: Single-LED

Short Description: Illuminated pushbutton Ø 19 mm silver contact, Maintained, 24 V DC, 1 C, Soldering terminal, 2.8 x 0.5 mm, round, Stainless steel, Red, Standby, Silver

Mounting cut-outs:

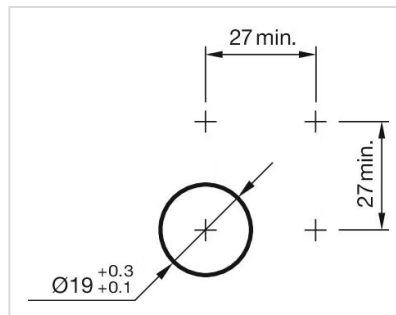

Component layouts:

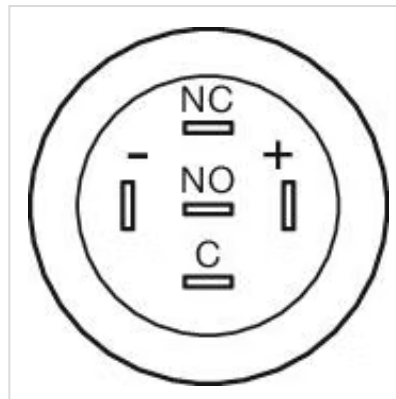

Wiring diagrams:

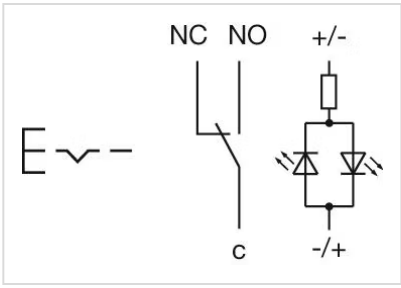

Dimension drawings:

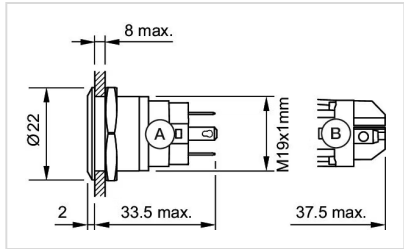

A = Solder terminal
B = Screw terminal