

## Illuminated pushbutton Ø 19 mm silver contact

82-5151.1133.B001



<https://eao.com/p/82-5151.1133.B001>

Your product:

---



## 82-5151.1133.B001

### Illuminated pushbutton Ø 19 mm silver contact

#### FRONT

Front bezel shape:	flush
Front bezel material:	Stainless steel
Front dimension:	Ø 22 mm
Front form:	round

#### MOUNTING

Mounting cut-out:	Ø 19 mm
Mounting type:	Panel mounting

#### OPERATING-/INDICATION PART

Shape of illumination:	Ring
Lens optics:	opaque
Lens shape:	flush
Symbol:	ON/OFF
Lens colour:	Silver
Lens illumination:	illuminative
Illumination colour:	Green
Lens material:	Stainless steel

#### ELECTRICAL CHARACTERISTICS

Operation current:	7 mA
Electrical lifetime:	50 000 cycles of operation

<b>Rated Operational Voltage Ue:</b>	250 VAC																						
<b>Pollution degree:</b>	2, according to EN IEC 60947-1																						
<b>Contacts:</b>	1 C																						
<b>Operating voltage:</b>	12 V AC/DC																						
<b>Rated insulation voltage Ui:</b>	250 V																						
<b>Switching voltage and switching current:</b>	<p>according to IEC 60947-5-1 (Silver contacts)</p> <table> <tr> <td>Service categorie AC-15</td><td></td></tr> <tr> <td>Voltage</td><td>Current</td></tr> <tr> <td>24 VAC</td><td>1 A</td></tr> <tr> <td>35 VAC</td><td>1 A (M12 versio</td></tr> <tr> <td>110 VAC</td><td>1 A</td></tr> <tr> <td>220 VAC</td><td>0.5 A</td></tr> </table> <p>Switch rating DC service categorie DC-13 (Silver contacts)</p> <table> <tr> <td>Voltage</td><td>Current</td></tr> <tr> <td>24 VDC</td><td>0.7 A</td></tr> <tr> <td>35 VDC</td><td>0.5 A (M12 vers</td></tr> <tr> <td>110 VDC</td><td>0.2 A</td></tr> <tr> <td>220 VDC</td><td>0.1 A</td></tr> </table>	Service categorie AC-15		Voltage	Current	24 VAC	1 A	35 VAC	1 A (M12 versio	110 VAC	1 A	220 VAC	0.5 A	Voltage	Current	24 VDC	0.7 A	35 VDC	0.5 A (M12 vers	110 VDC	0.2 A	220 VDC	0.1 A
Service categorie AC-15																							
Voltage	Current																						
24 VAC	1 A																						
35 VAC	1 A (M12 versio																						
110 VAC	1 A																						
220 VAC	0.5 A																						
Voltage	Current																						
24 VDC	0.7 A																						
35 VDC	0.5 A (M12 vers																						
110 VDC	0.2 A																						
220 VDC	0.1 A																						
	<p>according to UL 508 (Silver contacts)</p> <table> <tr> <td>cosφ 0,75 ... 0,8</td><td></td></tr> <tr> <td>Voltage</td><td>Current</td></tr> <tr> <td>120 VAC</td><td>5 A</td></tr> <tr> <td>240 VAC</td><td>3 A</td></tr> <tr> <td>24 VAC</td><td>1 A</td></tr> </table>	cosφ 0,75 ... 0,8		Voltage	Current	120 VAC	5 A	240 VAC	3 A	24 VAC	1 A												
cosφ 0,75 ... 0,8																							
Voltage	Current																						
120 VAC	5 A																						
240 VAC	3 A																						
24 VAC	1 A																						
<b>Electric strength:</b>	1500 VAC, 50 Hz 1 minute between life terminals and ground																						
<b>Thermal current Ith:</b>	5 A																						

## MECHANICAL CHARACTERISTIC

<b>Terminal:</b>	Soldering terminal, 2.8 x 0.5 mm
<b>Switching action:</b>	Momentary
<b>Mechanical lifetime:</b>	1 Mio. cycles of operation
<b>Weight:</b>	0.018 kg
<b>Contact material:</b>	Silver
<b>Operating force:</b>	4 N ... 7 N
<b>Tightening torque:</b>	0.5 ... 0.6 Nm
<b>Switching system:</b>	Snap-action switching element
<b>Operating Travel:</b>	ca. 3 mm

## AMBIENT CONDITION

<b>Vibration resistance:</b>	10 ... 500 Hz, amplitude 1.5 mm p-p according to IEC 60068-2-6
<b>Operating temperature:</b>	

– 30 °C ... + 70 °C

**Storage temperature:**

– 40 °C ... + 80 °C

**IP front protection:**

IP65, IP67

**Climate resistance:**

Damp heat, 21 days according to IEC 60512-11

**Shock resistance:**

Max. 500 m / s<sup>2</sup> as per IEC 60068-2-27

## CERTIFICATE

**REACH:**

REACH compliant

**RoHS:**

RoHS compliant

**Conformities:**

CE, 2011 / 65 / EC (RoHS), 2014 / 35 / EU (LVD)

**Approbations:**

CB, CCC, C UL, UL

## OTHER

**Short Description:**

Illuminated pushbutton Ø 19 mm silver contact, Momentary, 12 V AC/DC, 1 C, Soldering terminal, 2.8 x 0.5 mm, round, Stainless steel, Green, ON/OFF, Silver

**Kind of illumination:**

Single-LED

**Wiring diagrams:**

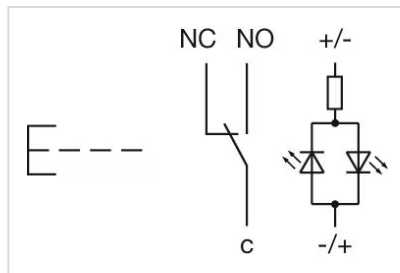

**Mounting cut-outs:**

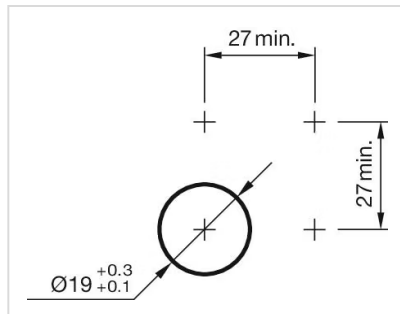

**Dimension drawings:**

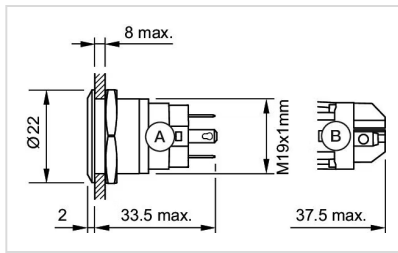

A = Solder terminal  
B = Screw terminal

# **Component layouts:**

