

Illuminated pushbutton Ø 19 mm silver contact

82-5152.2113



<https://eao.com/p/82-5152.2113>

Your product:



82-5152.2113

Illuminated pushbutton Ø
19 mm silver contact

FRONT

Front bezel shape:	flush
Front form:	round
Front bezel material:	Stainless steel
Front dimension:	Ø 22 mm

MOUNTING

Mounting type:	Panel mounting
Mounting cut-out:	Ø 19 mm

OPERATING-/INDICATION PART

Illumination colour:	Red
Shape of illumination:	Ring
Lens optics:	opaque
Lens colour:	Silver
Lens shape:	flush
Lens material:	Stainless steel
Lens illumination:	illuminative

ELECTRICAL CHARACTERISTICS

Operating voltage:	12 V AC/DC
Thermal current I _{th} :	5 A
Rated insulation voltage U _i :	250 V

Rated Operational Voltage Ue:	250 VAC		
Switching voltage and switching current:	according to IEC 60947-5-1 (Silver contacts) Service categorie AC-15 Voltage 24 VAC 35 VAC 110 VAC 220 VAC Switch rating DC service categorie DC-13 (Silver contacts) Voltage 24 VDC 35 VDC 110 VDC 220 VDC		
		Current	1 A
			1 A (M12 versio
			1 A
			0.5 A
		Current	0.7 A
			0.5 A (M12 vers
			0.2 A
			0.1 A
	according to UL 508 (Silver contacts) cosφ 0,75 ... 0,8 Voltage 120 VAC 240 VAC 24 VAC		
		Current	5 A
			3 A
			1 A
Operation current:	7 mA		
Contacts:	1 C		
Electric strength:	1500 VAC, 50 Hz 1 minute between life terminals and ground		
Electrical lifetime:	50 000 cycles of operation		
Pollution degree:	2, according to EN IEC 60947-1		

MECHANICAL CHARACTERISTIC

Switching system:	Snap-action switching element
Operating Travel:	ca. 3 mm
Tightening torque:	0.5 ... 0.6 Nm, Screw terminal 0.1 Nm
Contact material:	Silver
Operating force:	4 N ... 7 N
Mechanical lifetime:	500 000 cycles of operation
Weight:	0.018 kg
Switching action:	Maintained
Terminal:	Screw terminal

AMBIENT CONDITION

IP front protection:	IP65, IP67
Vibration resistance:	10 ... 500 Hz, amplitude 1.5 mm p-p according to IEC 60068-2-6
Shock resistance:	

Max. 500 m / s² as per IEC 60068-2-27

Operating temperature: – 30 °C ... + 70 °C

Storage temperature: – 40 °C ... + 80 °C

Climate resistance: Damp heat, 21 days according to IEC 60512-11

CERTIFICATE

RoHS: RoHS compliant

REACH: REACH compliant

Conformities: CE, 2011 / 65 / EC (RoHS), 2014 / 35 / EU (LVD)

Approbations: CB, CCC, C UL, UL

OTHER

Short Description: Illuminated pushbutton Ø 19 mm silver contact, Maintained, 12 V AC/DC, 1 C, Screw terminal, round, Stainless steel, Red, Silver

Kind of illumination: Single-LED

Component layouts:

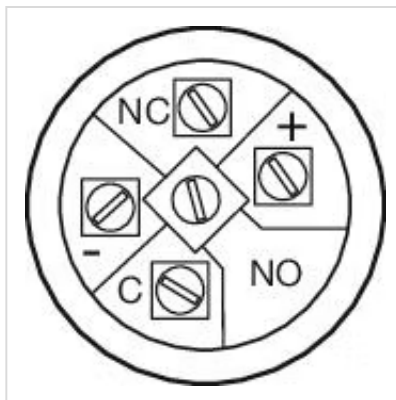

Wiring diagrams:

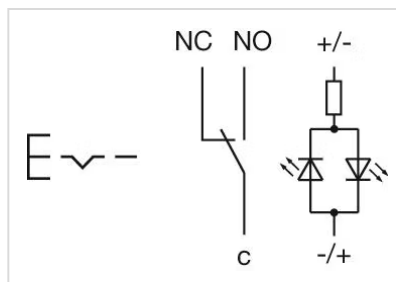

Dimension drawings:

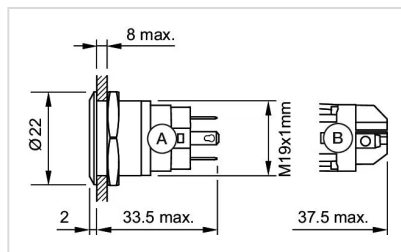

A = Solder terminal
B = Screw terminal

Mounting cut-outs:

