

Illuminated pushbutton Ø 19 mm silver contact

82-5152.2124.B001



<https://eao.com/p/82-5152.2124.B001>

Your product:



82-5152.2124.B001

Illuminated pushbutton Ø 19 mm silver contact

FRONT

Front bezel shape:	flush
Front dimension:	Ø 22 mm
Front bezel material:	Stainless steel
Front form:	round

MOUNTING

Mounting type:	Panel mounting
Mounting cut-out:	Ø 19 mm

OPERATING-/INDICATION PART

Lens material:	Stainless steel
Symbol:	ON/OFF
Illumination colour:	Blue
Lens colour:	Silver
Lens illumination:	illuminative
Lens shape:	flush
Shape of illumination:	Ring
Lens optics:	opaque

ELECTRICAL CHARACTERISTICS

Operating voltage:	24 V DC
Operation current:	7 mA

Pollution degree:	2, according to EN IEC 60947-1		
Contacts:	1 C		
Rated Operational Voltage Ue:	250 VAC		
Electric strength:	1500 VAC, 50 Hz 1 minute between life terminals and ground		
Electrical lifetime:	50 000 cycles of operation		
Rated insulation voltage Ui:	250 V		
Switching voltage and switching current:	according to IEC 60947-5-1 (Silver contacts) Service categorie AC-15 Voltage 24 VAC 35 VAC 110 VAC 220 VAC Switch rating DC service categorie DC-13 (Silver contacts) Voltage 24 VDC 35 VDC 110 VDC 220 VDC		
			Current
			1 A
			1 A (M12 versio
			1 A
			0.5 A
			Current
			0.7 A
			0.5 A (M12 vers
			0.2 A
			0.1 A
	according to UL 508 (Silver contacts) cosφ 0,75 ... 0,8 Voltage 120 VAC 240 VAC 24 VAC		
		Current	
		5 A	
		3 A	
		1 A	
Thermal current Ith:	5 A		

MECHANICAL CHARATERISTIC

Switching system:	Snap-action switching element
Switching action:	Maintained
Tightening torque:	0.5 ... 0.6 Nm, Screw terminal 0.1 Nm
Terminal:	Screw terminal
Weight:	0.018 kg
Mechanical lifetime:	500 000 cycles of operation
Operating force:	4 N ... 7 N
Contact material:	Silver
Operating Travel:	ca. 3 mm

AMBIENT CONDITION

Operating temperature:	– 30 °C ... + 70 °C
Shock resistance:	

Max. 500 m / s² as per IEC 60068-2-27

Storage temperature: - 40 °C ... + 80 °C

Vibration resistance: 10 ... 500 Hz, amplitude 1.5 mm p-p according to IEC 60068-2-6

Climate resistance: Damp heat, 21 days according to IEC 60512-11

IP front protection: IP65, IP67

CERTIFICATE

REACH: REACH compliant

RoHS: RoHS compliant

Conformities: CE, 2011 / 65 / EC (RoHS), 2014 / 35 / EU (LVD)

Approbations: CB, CCC, C UL, UL

OTHER

Short Description: Illuminated pushbutton Ø 19 mm silver contact, Maintained, 24 V DC, 1 C, Screw terminal, round, Stainless steel, Blue, ON/OFF, Silver

Kind of illumination: Single-LED

Component layouts:

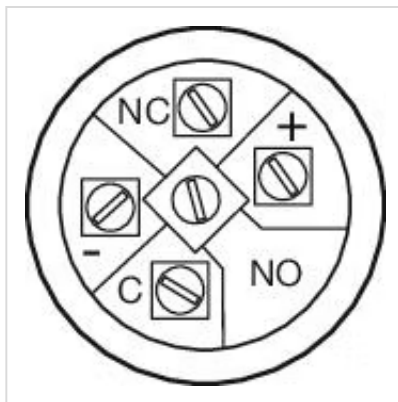

Wiring diagrams:

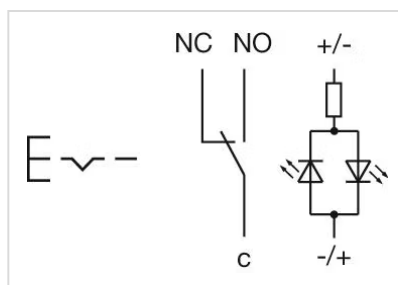

Mounting cut-outs:

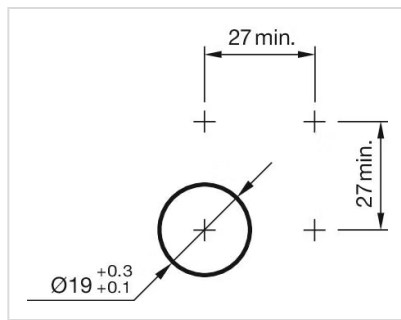

Dimension drawings:

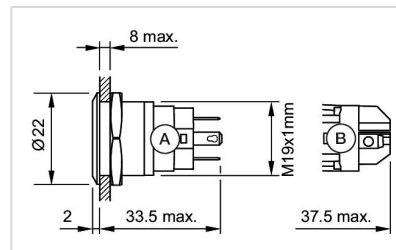

A = Solder terminal
B = Screw terminal