

# Illuminated pushbutton Ø 22 mm silver contact

82-6152.2124.B002



<https://eao.com/p/82-6152.2124.B002>

Your product:

---



## 82-6152.2124.B002

### Illuminated pushbutton Ø 22 mm silver contact

#### FRONT

Front dimension:	Ø 25 mm
Front bezel material:	Stainless steel
Front form:	round
Front bezel shape:	flush

#### MOUNTING

Mounting type:	Panel mounting
Mounting cut-out:	Ø 22 mm

#### OPERATING-/INDICATION PART

Symbol:	Standby
Lens material:	Stainless steel
Shape of illumination:	Ring
Lens optics:	opaque
Lens illumination:	illuminative
Lens colour:	Silver
Illumination colour:	Blue
Lens shape:	flush

#### ELECTRICAL CHARACTERISTICS

Rated insulation voltage Ui:	250 V
Contacts:	1 C

<b>Thermal current I<sub>th</sub>:</b>	5 A	
<b>Electric strength:</b>	1500 VAC, 50 Hz 1 minute between life terminals and ground	
<b>Rated Operational Voltage U<sub>e</sub>:</b>	250 VAC	
<b>Operating voltage:</b>	24 V AC/DC	
<b>Switching voltage and switching current:</b>	according to IEC 60947-5-1 (Silver contacts) Service categorie AC-15 Voltage 24 VAC 35 VAC 110 VAC 220 VAC Switch rating DC service categorie DC-13 (Silver contacts) Voltage 24 VDC 35 VDC 110 VDC 220 VDC	Current 1 A 1 A (M12 versio 1 A 0.5 A  Current 0.7 A 0.5 A (M12 vers 0.2 A 0.1 A
	according to UL 508 (Silver contacts) cosφ 0,75 ... 0,8 Voltage 120 VAC 240 VAC 24 VAC	Current 5 A 3 A 1 A
<b>Pollution degree:</b>	2, according to EN IEC 60947-1	
<b>Operation current:</b>	7 mA	
<b>Electrical lifetime:</b>	50 000 cycles of operation	

## MECHANICAL CHARATERISTIC

<b>Contact material:</b>	Silver
<b>Mechanical lifetime:</b>	500 000 cycles of operation
<b>Switching action:</b>	Maintained
<b>Operating force:</b>	4 N ... 7 N
<b>Operating Travel:</b>	ca. 3 mm
<b>Switching system:</b>	Snap-action switching element
<b>Weight:</b>	0.018 kg
<b>Tightening torque:</b>	0.5 ... 0.6 Nm, Screw terminal 0.1 Nm
<b>Terminal:</b>	Screw terminal

## AMBIENT CONDITION

<b>Shock resistance:</b>	Max. 500 m / s <sup>2</sup> as per IEC 60068-2-27
<b>Climate resistance:</b>	

Damp heat, 21 days according to IEC 60512-11

**IP front protection:** IP65, IP67

**Operating temperature:** – 30 °C ... + 70 °C

**Storage temperature:** – 40 °C ... + 80 °C

**Vibration resistance:** 10 ... 500 Hz, amplitude 1.5 mm p-p according to IEC 60068-2-6

## CERTIFICATE

**REACH:** REACH compliant

**Approbations:** CB, CCC, C UL, UL

**Conformities:** CE, 2011 / 65 / EC (RoHS), 2014 / 35 / EU (LVD)

**RoHS:** RoHS compliant

## OTHER

**Short Description:** Illuminated pushbutton Ø 22 mm silver contact, Maintained, 24 V AC/DC, 1 C, Screw terminal, round, Stainless steel, Blue, Standby, Silver

**Kind of illumination:** Single-LED

**Dimension drawings:**

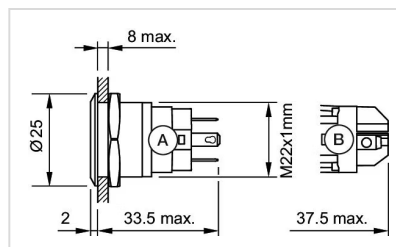

A = Solder terminal  
B = Screw terminal

**Component layouts:**

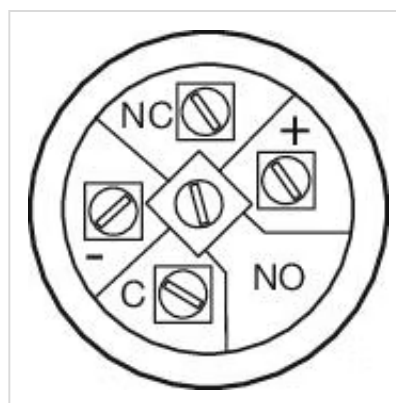

**Mounting cut-outs:**

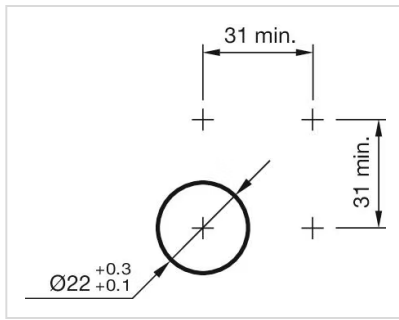

**Wiring diagrams:**

