

Illuminated pushbutton Ø 22 mm silver contact

82-6152.2123.B002



<https://eao.com/p/82-6152.2123.B002>

Your product:



82-6152.2123.B002

Illuminated pushbutton Ø 22 mm silver contact

FRONT

Front bezel shape:	flush
Front dimension:	Ø 25 mm
Front form:	round
Front bezel material:	Stainless steel

MOUNTING

Mounting cut-out:	Ø 22 mm
Mounting type:	Panel mounting

OPERATING-/INDICATION PART

Illumination colour:	Blue
Lens colour:	Silver
Lens illumination:	illuminative
Symbol:	Standby
Lens optics:	opaque
Lens material:	Stainless steel
Lens shape:	flush
Shape of illumination:	Ring

ELECTRICAL CHARACTERISTICS

Electric strength:	1500 VAC, 50 Hz 1 minute between life terminals and ground
Contacts:	1 C

Thermal current I_{th}:	5 A	
Rated insulation voltage U_i:	250 V	
Operating voltage:	12 V AC/DC	
Pollution degree:	2, according to EN IEC 60947-1	
Operation current:	7 mA	
Switching voltage and switching current:	according to IEC 60947-5-1 (Silver contacts) Service categorie AC-15 Voltage 24 VAC 35 VAC 110 VAC 220 VAC Switch rating DC service categorie DC-13 (Silver contacts) Voltage 24 VDC 35 VDC 110 VDC 220 VDC	Current 1 A 1 A (M12 versio 1 A 0.5 A Current 0.7 A 0.5 A (M12 vers 0.2 A 0.1 A
	according to UL 508 (Silver contacts) cosφ 0,75 ... 0,8 Voltage 120 VAC 240 VAC 24 VAC	Current 5 A 3 A 1 A
Rated Operational Voltage U_e:	250 VAC	
Electrical lifetime:	50 000 cycles of operation	

MECHANICAL CHARATERISTIC

Contact material:	Silver
Operating force:	4 N ... 7 N
Mechanical lifetime:	500 000 cycles of operation
Operating Travel:	ca. 3 mm
Switching system:	Snap-action switching element
Tightening torque:	0.5 ... 0.6 Nm, Screw terminal 0.1 Nm
Switching action:	Maintained
Weight:	0.018 kg
Terminal:	Screw terminal

AMBIENT CONDITION

Climate resistance:	Damp heat, 21 days according to IEC 60512-11
Vibration resistance:	

10 ... 500 Hz, amplitude 1.5 mm p-p according to IEC 60068-2-6

Storage temperature: - 40 °C ... + 80 °C

Operating temperature: - 30 °C ... + 70 °C

Shock resistance: Max. 500 m / s² as per IEC 60068-2-27

IP front protection: IP65, IP67

CERTIFICATE

Approbations: CB, CCC, C UL, UL

Conformities: CE, 2011 / 65 / EC (RoHS), 2014 / 35 / EU (LVD)

REACH: REACH compliant

RoHS: RoHS compliant

OTHER

Short Description: Illuminated pushbutton Ø 22 mm silver contact, Maintained, 12 V AC/DC, 1 C, Screw terminal, round, Stainless steel, Blue, Standby, Silver

Kind of illumination: Single-LED

Component layouts:

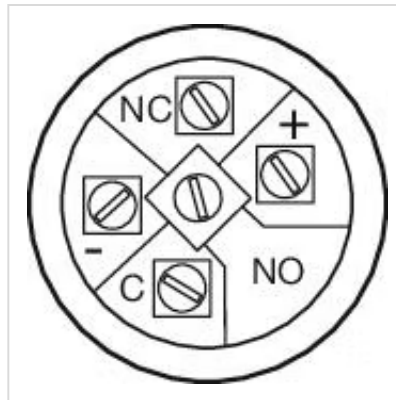

Dimension drawings:

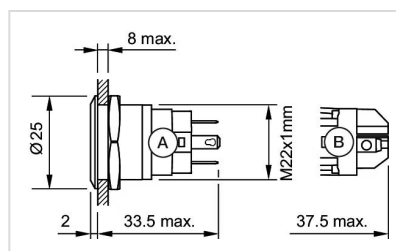

A = Solder terminal
B = Screw terminal

Mounting cut-outs:

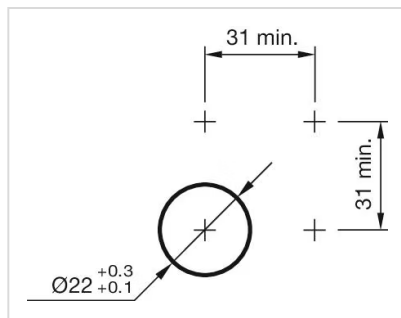

Wiring diagrams:

