

Illuminated pushbutton Ø 19 mm silver contact

82-5152.2114.B002



<https://eao.com/p/82-5152.2114.B002>

Your product:



82-5152.2114.B002

Illuminated pushbutton Ø 19 mm silver contact

FRONT

Front bezel material:	Stainless steel
Front form:	round
Front dimension:	Ø 22 mm
Front bezel shape:	flush

MOUNTING

Mounting cut-out:	Ø 19 mm
Mounting type:	Panel mounting

OPERATING-/INDICATION PART

Lens shape:	flush
Shape of illumination:	Ring
Lens colour:	Silver
Lens illumination:	illuminative
Lens material:	Stainless steel
Symbol:	Standby
Illumination colour:	Red
Lens optics:	opaque

ELECTRICAL CHARACTERISTICS

Operating voltage:	24 V DC
Pollution degree:	2, according to EN IEC 60947-1

Contacts:	1 C		
Operation current:	7 mA		
Thermal current I_{th}:	5 A		
Rated Operational Voltage U_e:	250 VAC		
Rated insulation voltage U_i:	250 V		
Electric strength:	1500 VAC, 50 Hz 1 minute between life terminals and ground		
Switching voltage and switching current:	according to IEC 60947-5-1 (Silver contacts) Service categorie AC-15 Voltage 24 VAC 35 VAC 110 VAC 220 VAC Switch rating DC service categorie DC-13 (Silver contacts) Voltage 24 VDC 35 VDC 110 VDC 220 VDC	Current 1 A 1 A (M12 versio 1 A 0.5 A Current 0.7 A 0.5 A (M12 vers 0.2 A 0.1 A	
	according to UL 508 (Silver contacts) cosφ 0,75 ... 0,8 Voltage 120 VAC 240 VAC 24 VAC	Current 5 A 3 A 1 A	
Electrical lifetime:	50 000 cycles of operation		

MECHANICAL CHARATERISTIC

Switching action:	Maintained
Operating Travel:	ca. 3 mm
Mechanical lifetime:	500 000 cycles of operation
Tightening torque:	0.5 ... 0.6 Nm, Screw terminal 0.1 Nm
Weight:	0.018 kg
Operating force:	4 N ... 7 N
Contact material:	Silver
Terminal:	Screw terminal
Switching system:	Snap-action switching element

AMBIENT CONDITION

Operating temperature:	– 30 °C ... + 70 °C
IP front protection:	

IP65, IP67

Shock resistance:

Max. 500 m / s² as per IEC 60068-2-27

Climate resistance:

Damp heat, 21 days according to IEC 60512-11

Storage temperature:

– 40 °C ... + 80 °C

Vibration resistance:

10 ... 500 Hz, amplitude 1.5 mm p-p according to IEC 60068-2-6

CERTIFICATE

Conformities:

CE, 2011 / 65 / EC (RoHS), 2014 / 35 / EU (LVD)

Approbations:

CB, CCC, C UL, UL

RoHS:

RoHS compliant

REACH:

REACH compliant

OTHER

Kind of illumination:

Single-LED

Short Description:

Illuminated pushbutton Ø 19 mm silver contact, Maintained, 24 V DC, 1 C, Screw terminal, round, Stainless steel, Red, Standby, Silver

Mounting cut-outs:

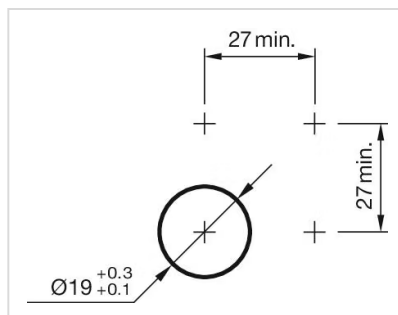

Wiring diagrams:

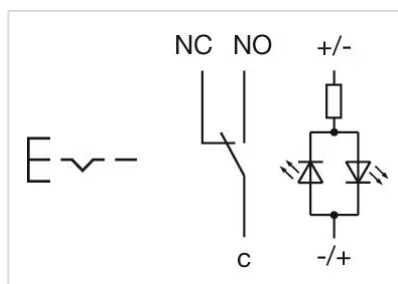

Dimension drawings:

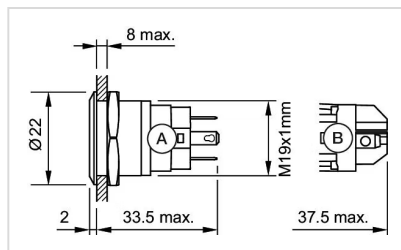

A = Solder terminal
B = Screw terminal

Component layouts:

