

## Illuminated pushbutton Ø 19 mm silver contact

82-5152.2124.B002



<https://eao.com/p/82-5152.2124.B002>

Your product:

---



## 82-5152.2124.B002

### Illuminated pushbutton Ø 19 mm silver contact

#### FRONT

Front form:	round
Front bezel shape:	flush
Front bezel material:	Stainless steel
Front dimension:	Ø 22 mm

#### MOUNTING

Mounting type:	Panel mounting
Mounting cut-out:	Ø 19 mm

#### OPERATING-/INDICATION PART

Lens shape:	flush
Lens optics:	opaque
Shape of illumination:	Ring
Symbol:	Standby
Lens colour:	Silver
Lens illumination:	illuminative
Illumination colour:	Blue
Lens material:	Stainless steel

#### ELECTRICAL CHARACTERISTICS

Pollution degree:	2, according to EN IEC 60947-1
Operation current:	7 mA

<b>Rated insulation voltage Ui:</b>	250 V		
<b>Electrical lifetime:</b>	50 000 cycles of operation		
<b>Contacts:</b>	1 C		
<b>Rated Operational Voltage Ue:</b>	250 VAC		
<b>Operating voltage:</b>	24 V DC		
<b>Thermal current Ith:</b>	5 A		
<b>Switching voltage and switching current:</b>	according to IEC 60947-5-1 (Silver contacts) Service categorie AC-15 Voltage 24 VAC 35 VAC 110 VAC 220 VAC Switch rating DC service categorie DC-13 (Silver contacts) Voltage 24 VDC 35 VDC 110 VDC 220 VDC		
			Current 1 A 1 A (M12 versio 1 A 0.5 A
			Current 0.7 A 0.5 A (M12 vers 0.2 A 0.1 A
	according to UL 508 (Silver contacts) cosφ 0,75 ... 0,8 Voltage 120 VAC 240 VAC 24 VAC		
		Current	5 A 3 A 1 A
<b>Electric strength:</b>	1500 VAC, 50 Hz 1 minute between life terminals and ground		

## MECHANICAL CHARACTERISTIC

<b>Mechanical lifetime:</b>	500 000 cycles of operation
<b>Terminal:</b>	Screw terminal
<b>Weight:</b>	0.018 kg
<b>Tightening torque:</b>	0.5 ... 0.6 Nm, Screw terminal 0.1 Nm
<b>Contact material:</b>	Silver
<b>Switching action:</b>	Maintained
<b>Operating Travel:</b>	ca. 3 mm
<b>Operating force:</b>	4 N ... 7 N
<b>Switching system:</b>	Snap-action switching element

## AMBIENT CONDITION

<b>Storage temperature:</b>	– 40 °C ... + 80 °C
<b>IP front protection:</b>	

IP65, IP67

<b>Vibration resistance:</b>	10 ... 500 Hz, amplitude 1.5 mm p-p according to IEC 60068-2-6
<b>Climate resistance:</b>	Damp heat, 21 days according to IEC 60512-11
<b>Shock resistance:</b>	Max. 500 m / s <sup>2</sup> as per IEC 60068-2-27
<b>Operating temperature:</b>	- 30 °C ... + 70 °C

## CERTIFICATE

<b>Conformities:</b>	CE, 2011 / 65 / EC (RoHS), 2014 / 35 / EU (LVD)
<b>RoHS:</b>	RoHS compliant
<b>REACH:</b>	REACH compliant
<b>Approbations:</b>	CB, CCC, C UL, UL

## OTHER

<b>Short Description:</b>	Illuminated pushbutton Ø 19 mm silver contact, Maintained, 24 V DC, 1 C, Screw terminal, round, Stainless steel, Blue, Standby, Silver
---------------------------	--

<b>Kind of illumination:</b>	Single-LED
------------------------------	------------

### Wiring diagrams:

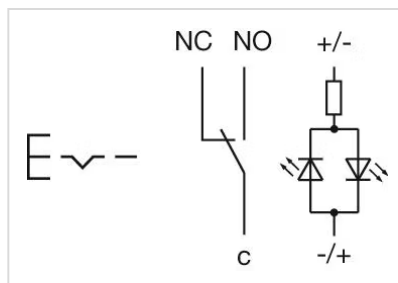

### Component layouts:

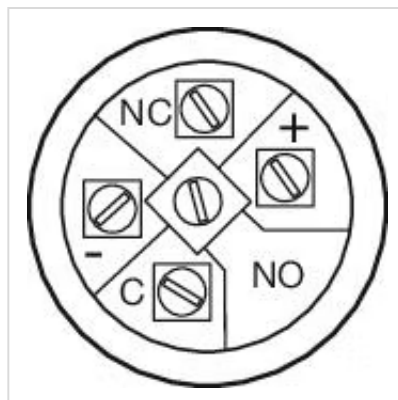

### Mounting cut-outs:

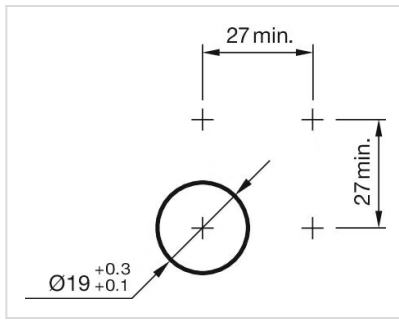

**Dimension drawings:**



A = Solder terminal  
B = Screw terminal