

Illuminated pushbutton Ø 16 mm silver contact

82-4551.1113



<https://eao.com/p/82-4551.1113>

Your product:



82-4551.1113

Illuminated pushbutton Ø
16 mm silver contact

FRONT

Front dimension:	Ø 18 mm
Front form:	round
Front bezel shape:	flush
Front bezel material:	Aluminium

MOUNTING

Mounting cut-out:	Ø 16 mm
Mounting type:	Panel mounting

OPERATING-/INDICATION PART

Lens material:	Aluminium
Lens illumination:	illuminative
Lens optics:	opaque
Lens shape:	flush
Lens colour:	Nature
Illumination colour:	Red
Shape of illumination:	Ring

ELECTRICAL CHARACTERISTICS

Contacts:	1 C
Electric strength:	1500 VAC, 50 Hz 1 minute between life terminals and ground
Rated insulation voltage Ui:	250 V

Thermal current I_{th}:	5 A		
Operation current:	7 mA		
Operating voltage:	12 V AC/DC		
Pollution degree:	2, according to EN IEC 60947-1		
Switching voltage and switching current:	according to IEC 60947-5-1 (Silver contacts) Service categorie AC-15 Voltage 24 VAC 35 VAC 110 VAC 220 VAC Switch rating DC service categorie DC-13 (Silver contacts) Voltage 24 VDC 35 VDC 110 VDC 220 VDC		Current 1 A 1 A (M12 versio 1 A 0.5 A Current 0.7 A 0.5 A (M12 vers 0.2 A 0.1 A
	according to UL 508 (Silver contacts) cos φ 0,75 ... 0,8 Voltage 120 VAC 240 VAC 24 VAC	Current 5 A 3 A 1 A	
Electrical lifetime:	50 000 cycles of operation		
Rated Operational Voltage U_e:	250 VAC		

MECHANICAL CHARACTERISTIC

Switching action:	Momentary
Contact material:	Silver
Operating Travel:	ca. 3 mm
Switching system:	Snap-action switching element
Mechanical lifetime:	1 Mio. cycles of operation
Tightening torque:	0.5 ... 0.6 Nm
Terminal:	Soldering terminal, 2.8 x 0.5 mm
Weight:	0.018 kg
Operating force:	4 N ... 7 N

AMBIENT CONDITION

Shock resistance:	Max. 500 m / s ² as per IEC 60068-2-27
Operating temperature:	– 30 °C ... + 70 °C
Climate resistance:	

Damp heat, 21 days according to IEC 60512-11

Storage temperature: - 40 °C ... + 80 °C

Vibration resistance: 10 ... 500 Hz, amplitude 1.5 mm p-p according to IEC 60068-2-6

IP front protection: IP65, IP67

CERTIFICATE

REACH: REACH compliant

Conformities: CE, 2011 / 65 / EC (RoHS), 2014 / 35 / EU (LVD)

Approbations: CB, CCC, C UL, UL

RoHS: RoHS compliant

OTHER

Kind of illumination: Single-LED

Short Description: Illuminated pushbutton Ø 16 mm silver contact, Momentary, 12 V AC/DC, 1 C, Soldering terminal, 2.8 x 0.5 mm, round, Aluminium, Red, Nature

Mounting cut-outs:

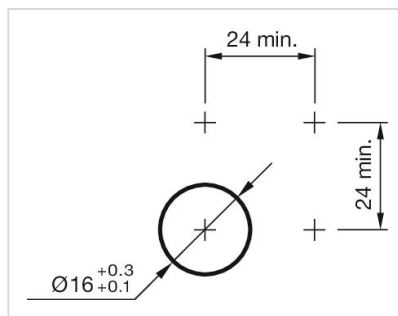

Wiring diagrams:

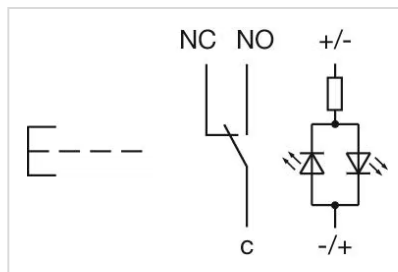

Component layouts:

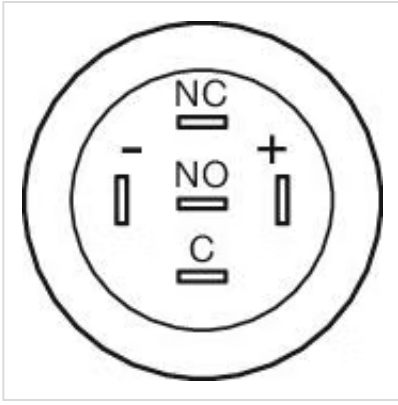

Dimension drawings:

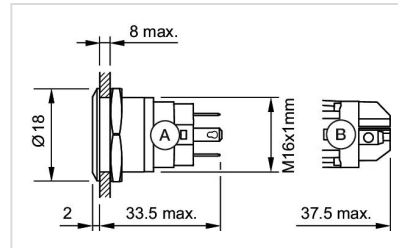

A = Solder terminal
B = Screw terminal