

Illuminated pushbutton Ø 19 mm silver contact

82-5552.1134



<https://eao.com/p/82-5552.1134>

Your product:



82-5552.1134

Illuminated pushbutton Ø
19 mm silver contact

FRONT

Front bezel shape:	flush
Front form:	round
Front dimension:	Ø 22 mm
Front bezel material:	Aluminium

MOUNTING

Mounting cut-out:	Ø 19 mm
Mounting type:	Panel mounting

OPERATING-/INDICATION PART

Lens illumination:	illuminative
Lens material:	Aluminium
Illumination colour:	Green
Shape of illumination:	Ring
Lens colour:	Nature
Lens optics:	opaque
Lens shape:	flush

ELECTRICAL CHARACTERISTICS

Rated insulation voltage Ui:	250 V
Rated Operational Voltage Ue:	250 VAC
Switching voltage and switching current:	

according to IEC 60947-5-1 (Silver contacts)

Service categorie AC-15

Voltage

24 VAC

35 VAC

110 VAC

220 VAC

Current

1 A

1 A (M12 version)

1 A

0.5 A

Switch rating DC service categorie DC-13 (Silver contacts)

Voltage

24 VDC

35 VDC

110 VDC

220 VDC

Current

0.7 A

0.5 A (M12 version)

0.2 A

0.1 A

according to UL 508 (Silver contacts)

$\cos\phi$ 0,75 ... 0,8

Voltage

120 VAC

240 VAC

24 VAC

Current

5 A

3 A

1 A

Electrical lifetime:	50 000 cycles of operation
Thermal current I_{th}:	5 A
Electric strength:	1500 VAC, 50 Hz 1 minute between life terminals and ground
Pollution degree:	2, according to EN IEC 60947-1
Operating voltage:	24 V DC
Operation current:	7 mA
Contacts:	1 C

MECHANICAL CHARACTERISTIC

Operating Travel:	ca. 3 mm
Operating force:	4 N ... 7 N
Mechanical lifetime:	1 Mio. cycles of operation
Switching action:	Momentary
Weight:	0.018 kg
Switching system:	Snap-action switching element
Contact material:	Silver
Terminal:	Screw terminal
Tightening torque:	0.5 ... 0.6 Nm, Screw terminal 0.1 Nm

AMBIENT CONDITION

Vibration resistance:	10 ... 500 Hz, amplitude 1.5 mm p-p according to IEC 60068-2-6
Shock resistance:	

Max. 500 m / s² as per IEC 60068-2-27

Storage temperature: – 40 °C ... + 80 °C

Climate resistance: Damp heat, 21 days according to IEC 60512-11

Operating temperature: – 30 °C ... + 70 °C

IP front protection: IP65, IP67

CERTIFICATE

Approbations: CB, CCC, C UL, UL

Conformities: CE, 2011 / 65 / EC (RoHS), 2014 / 35 / EU (LVD)

REACH: REACH compliant

RoHS: RoHS compliant

OTHER

Kind of illumination: Single-LED

Short Description: Illuminated pushbutton Ø 19 mm silver contact, Momentary, 24 V DC, 1 C, Screw terminal, round, Aluminium, Green, Nature

Component layouts:

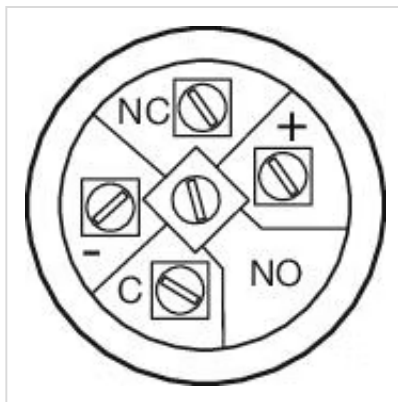

Dimension drawings:

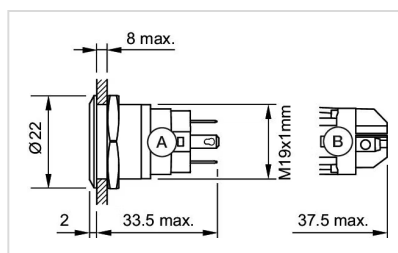

A = Solder terminal
B = Screw terminal

Mounting cut-outs:

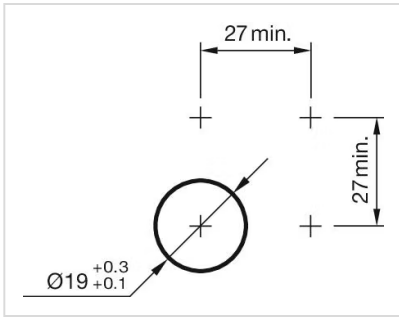

Wiring diagrams:

