

Illuminated pushbutton Ø 22 mm silver contact

82-6152.2133.B002



<https://eao.com/p/82-6152.2133.B002>

Your product:



82-6152.2133.B002

Illuminated pushbutton Ø 22 mm silver contact

FRONT

| | |
|-----------------------|-----------------|
| Front dimension: | Ø 25 mm |
| Front bezel material: | Stainless steel |
| Front bezel shape: | flush |
| Front form: | round |

MOUNTING

| | |
|-------------------|----------------|
| Mounting type: | Panel mounting |
| Mounting cut-out: | Ø 22 mm |

OPERATING-/INDICATION PART

| | |
|------------------------|-----------------|
| Lens illumination: | illuminative |
| Lens colour: | Silver |
| Symbol: | Standby |
| Lens optics: | opaque |
| Illumination colour: | Green |
| Shape of illumination: | Ring |
| Lens shape: | flush |
| Lens material: | Stainless steel |

ELECTRICAL CHARACTERISTICS

| | |
|-------------------------------|---------|
| Rated Operational Voltage Ue: | 250 VAC |
| Rated insulation voltage Ui: | 250 V |

| | | | |
|---|---|--|--|
| Contacts: | 1 C | | |
| Thermal current I_{th}: | 5 A | | |
| Operating voltage: | 12 V AC/DC | | |
| Electrical lifetime: | 50 000 cycles of operation | | |
| Operation current: | 7 mA | | |
| Pollution degree: | 2, according to EN IEC 60947-1 | | |
| Electric strength: | 1500 VAC, 50 Hz 1 minute between life terminals and ground | | |
| Switching voltage and switching current: | according to IEC 60947-5-1 (Silver contacts) Service categorie AC-15 Voltage 24 VAC 35 VAC 110 VAC 220 VAC Switch rating DC service categorie DC-13 (Silver contacts) Voltage 24 VDC 35 VDC 110 VDC 220 VDC | Current 1 A 1 A (M12 versio 1 A 0.5 A Current 0.7 A 0.5 A (M12 vers 0.2 A 0.1 A | |
| | according to UL 508 (Silver contacts) cosφ 0,75 ... 0,8 Voltage 120 VAC 240 VAC 24 VAC | Current 5 A 3 A 1 A | |

MECHANICAL CHARATERISTIC

| | |
|-----------------------------|---------------------------------------|
| Contact material: | Silver |
| Operating force: | 4 N ... 7 N |
| Mechanical lifetime: | 500 000 cycles of operation |
| Switching action: | Maintained |
| Operating Travel: | ca. 3 mm |
| Tightening torque: | 0.5 ... 0.6 Nm, Screw terminal 0.1 Nm |
| Switching system: | Snap-action switching element |
| Terminal: | Screw terminal |
| Weight: | 0.018 kg |

AMBIENT CONDITION

| | |
|------------------------------|--|
| Climate resistance: | Damp heat, 21 days according to IEC 60512-11 |
| Vibration resistance: | |

10 ... 500 Hz, amplitude 1.5 mm p-p according to IEC 60068-2-6

Operating temperature: - 30 °C ... + 70 °C

Shock resistance: Max. 500 m / s² as per IEC 60068-2-27

Storage temperature: - 40 °C ... + 80 °C

IP front protection: IP65, IP67

CERTIFICATE

RoHS: RoHS compliant

REACH: REACH compliant

Conformities: CE, 2011 / 65 / EC (RoHS), 2014 / 35 / EU (LVD)

Approbations: CB, CCC, C UL, UL

OTHER

Short Description: Illuminated pushbutton Ø 22 mm silver contact, Maintained, 12 V AC/DC, 1 C, Screw terminal, round, Stainless steel, Green, Standby, Silver

Kind of illumination: Single-LED

Component layouts:

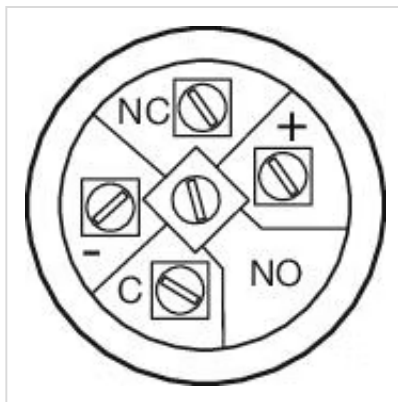

Mounting cut-outs:

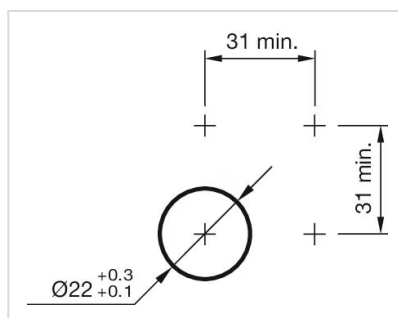

Wiring diagrams:

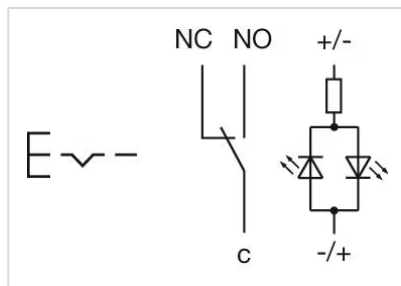

Dimension drawings:

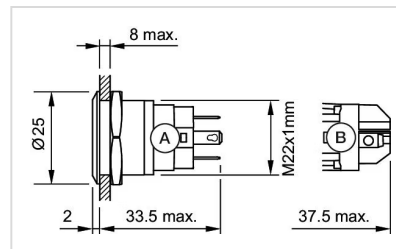

A = Solder terminal
B = Screw terminal