

Illuminated pushbutton Ø 19 mm silver contact

82-5152.1124.B002



<https://eao.com/p/82-5152.1124.B002>

Your product:



82-5152.1124.B002

Illuminated pushbutton Ø 19 mm silver contact

FRONT

Front bezel shape:	flush
Front bezel material:	Stainless steel
Front dimension:	Ø 22 mm
Front form:	round

MOUNTING

Mounting cut-out:	Ø 19 mm
Mounting type:	Panel mounting

OPERATING-/INDICATION PART

Lens material:	Stainless steel
Lens illumination:	illuminative
Symbol:	Standby
Shape of illumination:	Ring
Lens shape:	flush
Illumination colour:	Blue
Lens colour:	Silver
Lens optics:	opaque

ELECTRICAL CHARACTERISTICS

Electric strength:	1500 VAC, 50 Hz 1 minute between life terminals and ground
Operating voltage:	24 V DC

Rated insulation voltage Ui:	250 V		
Electrical lifetime:	50 000 cycles of operation		
Operation current:	7 mA		
Rated Operational Voltage Ue:	250 VAC		
Contacts:	1 C		
Pollution degree:	2, according to EN IEC 60947-1		
Switching voltage and switching current:	according to IEC 60947-5-1 (Silver contacts) Service categorie AC-15 Voltage 24 VAC 35 VAC 110 VAC 220 VAC Switch rating DC service categorie DC-13 (Silver contacts) Voltage 24 VDC 35 VDC 110 VDC 220 VDC	Current 1 A 1 A (M12 versio 1 A 0.5 A Current 0.7 A 0.5 A (M12 vers 0.2 A 0.1 A	
	according to UL 508 (Silver contacts) $\cos \phi$ 0,75 ... 0,8 Voltage 120 VAC 240 VAC 24 VAC	Current 5 A 3 A 1 A	
Thermal current Ith:	5 A		

MECHANICAL CHARACTERISTIC

Contact material:	Silver
Switching action:	Momentary
Switching system:	Snap-action switching element
Tightening torque:	0.5 ... 0.6 Nm, Screw terminal 0.1 Nm
Operating Travel:	ca. 3 mm
Mechanical lifetime:	1 Mio. cycles of operation
Terminal:	Screw terminal
Operating force:	4 N ... 7 N
Weight:	0.018 kg

AMBIENT CONDITION

Climate resistance:	Damp heat, 21 days according to IEC 60512-11
Storage temperature:	

– 40 °C ... + 80 °C

IP front protection:

IP65, IP67

Vibration resistance:

10 ... 500 Hz, amplitude 1.5 mm p-p according to IEC 60068-2-6

Operating temperature:

– 30 °C ... + 70 °C

Shock resistance:

Max. 500 m / s² as per IEC 60068-2-27

CERTIFICATE

Approbations:

CB, CCC, C UL, UL

Conformities:

CE, 2011 / 65 / EC (RoHS), 2014 / 35 / EU (LVD)

REACH:

REACH compliant

RoHS:

RoHS compliant

OTHER

Kind of illumination:

Single-LED

Short Description:

Illuminated pushbutton Ø 19 mm silver contact, Momentary, 24 V DC, 1 C, Screw terminal, round, Stainless steel, Blue, Standby, Silver

Wiring diagrams:

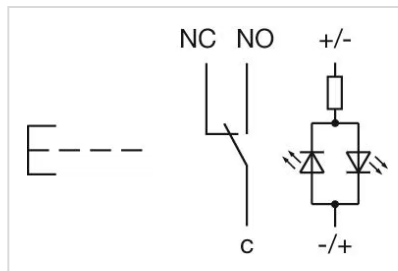

Mounting cut-outs:

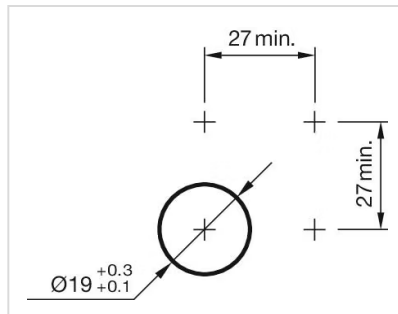

Dimension drawings:

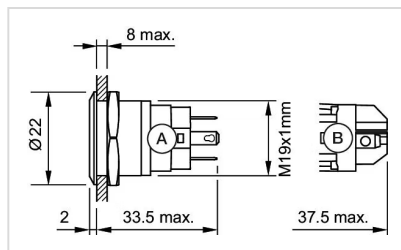

A = Solder terminal
B = Screw terminal

Component layouts:

