

Illuminated pushbutton Ø 19 mm silver contact

82-5551.2113



<https://eao.com/p/82-5551.2113>

Your product:



82-5551.2113

Illuminated pushbutton Ø
19 mm silver contact

FRONT

Front bezel shape:	flush
Front bezel material:	Aluminium
Front form:	round
Front dimension:	Ø 22 mm

MOUNTING

Mounting type:	Panel mounting
Mounting cut-out:	Ø 19 mm

OPERATING-/INDICATION PART

Lens colour:	Nature
Lens illumination:	illuminative
Lens optics:	opaque
Lens material:	Aluminium
Illumination colour:	Red
Shape of illumination:	Ring
Lens shape:	flush

ELECTRICAL CHARACTERISTICS

Rated Operational Voltage U _e :	250 VAC
Operating voltage:	12 V AC/DC
Contacts:	1 C

Electric strength:	1500 VAC, 50 Hz 1 minute between life terminals and ground	
Electrical lifetime:	50 000 cycles of operation	
Pollution degree:	2, according to EN IEC 60947-1	
Operation current:	7 mA	
Rated insulation voltage Ui:	250 V	
Thermal current Ith:	5 A	
Switching voltage and switching current:	according to IEC 60947-5-1 (Silver contacts) Service categorie AC-15 Voltage 24 VAC 35 VAC 110 VAC 220 VAC Switch rating DC service categorie DC-13 (Silver contacts) Voltage 24 VDC 35 VDC 110 VDC 220 VDC	Current 1 A 1 A (M12 versio 1 A 0.5 A Current 0.7 A 0.5 A (M12 vers 0.2 A 0.1 A
	according to UL 508 (Silver contacts) cosφ 0,75 ... 0,8 Voltage 120 VAC 240 VAC 24 VAC	Current 5 A 3 A 1 A

MECHANICAL CHARATERISTIC

Terminal:	Soldering terminal, 2.8 x 0.5 mm
Tightening torque:	0.5 ... 0.6 Nm
Operating Travel:	ca. 3 mm
Weight:	0.018 kg
Operating force:	4 N ... 7 N
Switching system:	Snap-action switching element
Contact material:	Silver
Switching action:	Maintained
Mechanical lifetime:	500 000 cycles of operation

AMBIENT CONDITION

Storage temperature:	– 40 °C ... + 80 °C
Shock resistance:	Max. 500 m / s ² as per IEC 60068-2-27
Vibration resistance:	

10 ... 500 Hz, amplitude 1.5 mm p-p according to IEC 60068-2-6

Operating temperature: - 30 °C ... + 70 °C

Climate resistance: Damp heat, 21 days according to IEC 60512-11

IP front protection: IP65, IP67

CERTIFICATE

RoHS: RoHS compliant

Conformities: CE, 2011 / 65 / EC (RoHS), 2014 / 35 / EU (LVD)

Approbations: CB, CCC, C UL, UL

REACH: REACH compliant

OTHER

Kind of illumination: Single-LED

Short Description: Illuminated pushbutton Ø 19 mm silver contact, Maintained, 12 V AC/DC, 1 C, Soldering terminal, 2.8 x 0.5 mm, round, Aluminium, Red, Nature

Component layouts:

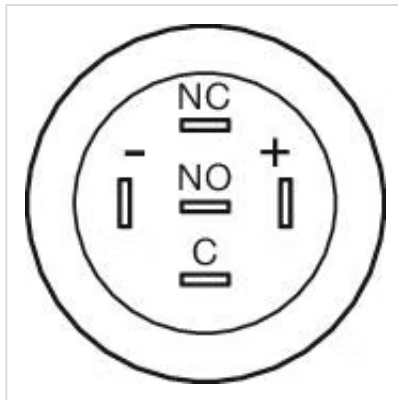

Mounting cut-outs:

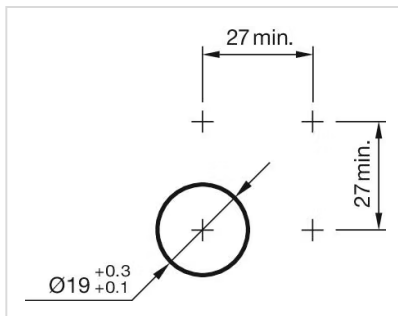

Dimension drawings:

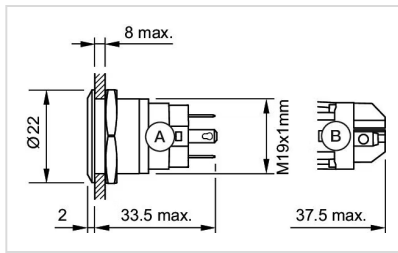

A = Solder terminal
B = Screw terminal

Wiring diagrams:

