

Pushbutton Ø 16 mm silver contact

82-4572.2000



<https://eao.com/p/82-4572.2000>

Your product:



82-4572.2000

Pushbutton Ø 16 mm silver contact

FRONT

Front bezel material:	Aluminium
Front bezel shape:	flush
Front form:	round
Front dimension:	Ø 18 mm

MOUNTING

Mounting cut-out:	Ø 16 mm
Mounting type:	Panel mounting

OPERATING-/INDICATION PART

Lens shape:	convex
Lens colour:	Nature
Lens optics:	opaque
Lens material:	Aluminium
Lens illumination:	non illuminative

ELECTRICAL CHARACTERISTICS

Switching voltage and switching current:

according to IEC 60947-5-1 (Silver contacts)	
Service categorie AC-15	
Voltage	Current
24 VAC	1 A
35 VAC	1 A (M12 version)
110 VAC	1 A
220 VAC	0.5 A
Switch rating DC service categorie DC-13 (Silver contacts)	
Voltage	Current
24 VDC	0.7 A
35 VDC	0.5 A (M12 version)
110 VDC	0.2 A
220 VDC	0.1 A

according to UL 508 (Silver contacts)	
cosφ 0,75 ... 0,8	
Voltage	Current
120 VAC	5 A
240 VAC	3 A
24 VAC	1 A

Electrical lifetime:	50 000 cycles of operation
Pollution degree:	2, according to EN IEC 60947-1
Rated Operational Voltage Ue:	250 VAC
Contacts:	1 C
Electric strength:	1500 VAC, 50 Hz 1 minute between life terminals and ground
Rated insulation voltage Ui:	250 V
Thermal current Ith:	5 A

MECHANICAL CHARATERISTIC

Switching action:	Maintained
Contact material:	Silver
Mechanical lifetime:	500 000 cycles of operation
Operating force:	4 N ... 7 N
Tightening torque:	0.5 ... 0.6 Nm, Screw terminal 0.1 Nm
Operating Travel:	ca. 3 mm
Switching system:	Snap-action switching element
Terminal:	Screw terminal
Weight:	0.019 kg

AMBIENT CONDITION

Climate resistance:	Damp heat, 21 days according to IEC 60512-11
Storage temperature:	

– 40 °C ... + 80 °C

Operating temperature:

– 30 °C ... + 70 °C

IP front protection:

IP65, IP67

Shock resistance:

Max. 500 m / s² as per IEC 60068-2-27

Vibration resistance:

10 ... 500 Hz, amplitude 1.5 mm p-p according to IEC 60068-2-6

CERTIFICATE

Conformities:

CE, 2011 / 65 / EC (RoHS), 2014 / 35 / EU (LVD)

RoHS:

RoHS compliant

REACH:

REACH compliant

Approbations:

CB, CCC, C UL, UL

OTHER

Short Description:

Pushbutton Ø 16 mm silver contact, Maintained, 1 C, Screw terminal, round, Aluminium, Nature

Dimension drawings:

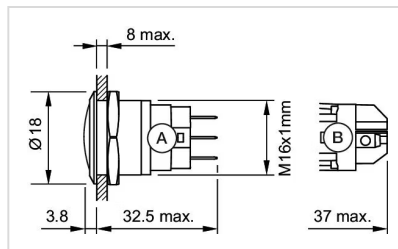

A = Solder terminal
B = Screw terminal

Wiring diagrams:

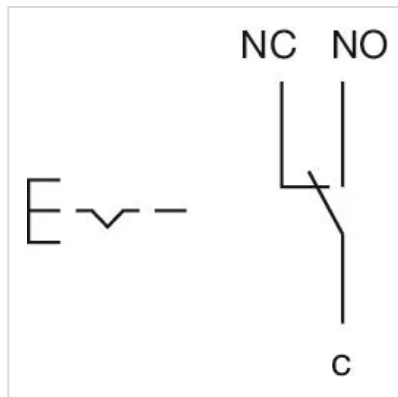

Component layouts:

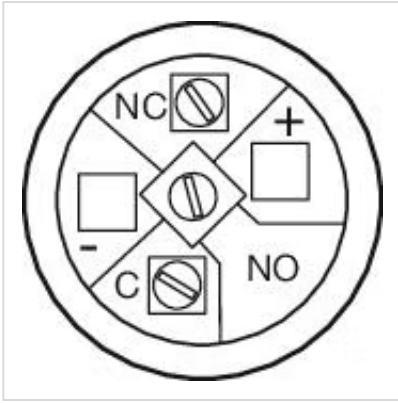

Mounting cut-outs:

