

Pushbutton Ø 19 mm silver contact

82-5161.1000



<https://eao.com/p/82-5161.1000>

Your product:



82-5161.1000

Pushbutton Ø 19 mm silver contact

FRONT

| | |
|-----------------------|-----------------|
| Front dimension: | Ø 22 mm |
| Front form: | round |
| Front bezel material: | Stainless steel |
| Front bezel shape: | flush |

MOUNTING

| | |
|-------------------|----------------|
| Mounting cut-out: | Ø 19 mm |
| Mounting type: | Panel mounting |

OPERATING-/INDICATION PART

| | |
|--------------------|------------------|
| Lens shape: | raised |
| Lens colour: | Silver |
| Lens optics: | opaque |
| Lens illumination: | non illuminative |
| Lens material: | Stainless steel |

ELECTRICAL CHARACTERISTICS

| | |
|-----------------------------------|------------------------------------------------------------|
| Contacts: | 1 C |
| Rated insulation voltage U_i : | 250 V |
| Electrical lifetime: | 50 000 cycles of operation |
| Rated Operational Voltage U_e : | 250 VAC |
| Electric strength: | 1500 VAC, 50 Hz 1 minute between life terminals and ground |

| | | | |
|-------------------------------------------------|-------------------------------------------------------------------------------------------------------------------------------------------------------------------------------------------------------------------------------------------------|----------------------------------------------------------------------------------------------------------------|--|
| Thermal current I_{th}: | 5 A | | |
| Switching voltage and switching current: | according to IEC 60947-5-1 (Silver contacts) Service categorie AC-15 Voltage 24 VAC 35 VAC 110 VAC 220 VAC Switch rating DC service categorie DC-13 (Silver contacts) Voltage 24 VDC 35 VDC 110 VDC 220 VDC | Current 1 A 1 A (M12 versio 1 A 0.5 A Current 0.7 A 0.5 A (M12 vers 0.2 A 0.1 A | |
| | according to UL 508 (Silver contacts) cosφ 0,75 ... 0,8 Voltage 120 VAC 240 VAC 24 VAC | Current 5 A 3 A 1 A | |
| Pollution degree: | 2, according to EN IEC 60947-1 | | |

MECHANICAL CHARACTERISTIC

| | |
|-----------------------------|----------------------------------|
| Operating Travel: | ca. 3 mm |
| Tightening torque: | 0.5 ... 0.6 Nm |
| Switching action: | Momentary |
| Terminal: | Soldering terminal, 2.8 x 0.5 mm |
| Mechanical lifetime: | 1 Mio. cycles of operation |
| Switching system: | Snap-action switching element |
| Contact material: | Silver |
| Weight: | 0.02 kg |
| Operating force: | 4 N ... 7 N |

AMBIENT CONDITION

| | |
|-------------------------------|----------------------------------------------------------------|
| Climate resistance: | Damp heat, 21 days according to IEC 60512-11 |
| Operating temperature: | – 30 °C ... + 70 °C |
| Vibration resistance: | 10 ... 500 Hz, amplitude 1.5 mm p-p according to IEC 60068-2-6 |
| IP front protection: | IP65, IP67 |
| Shock resistance: | Max. 500 m / s ² as per IEC 60068-2-27 |
| Storage temperature: | – 40 °C ... + 80 °C |

CERTIFICATE

| | |
|----------------------|-------------------------------------------------|
| RoHS: | RoHS compliant |
| Conformities: | CE, 2011 / 65 / EC (RoHS), 2014 / 35 / EU (LVD) |
| Approbations: | CB, CCC, C UL, UL |
| REACH: | REACH compliant |

OTHER

Short Description: Pushbutton Ø 19 mm silver contact, Momentary, 1 C, Soldering terminal, 2.8 x 0.5 mm, round, Stainless steel, Silver

Mounting cut-outs:

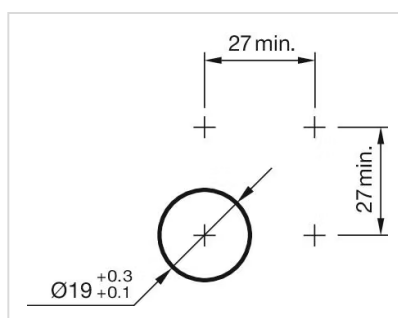

Wiring diagrams:

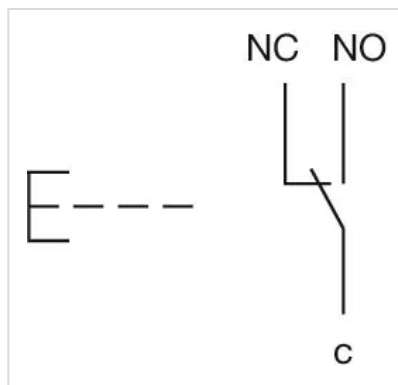

Component layouts:

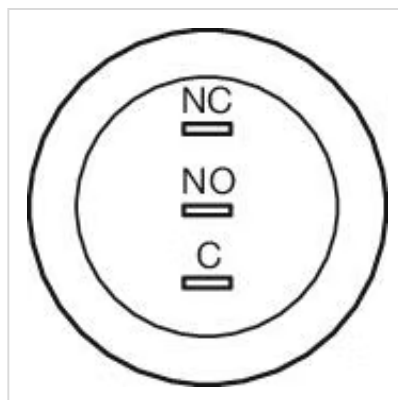

Dimension drawings:

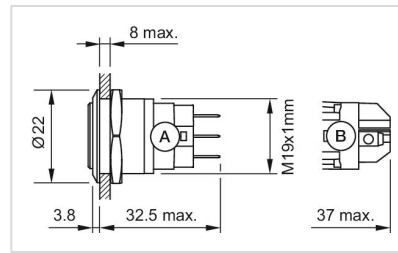

A = Solder terminal
B = Screw terminal