

Illuminated pushbutton Ø 22 mm silver contact

82-6152.1123



<https://eao.com/p/82-6152.1123>

Your product:



82-6152.1123

Illuminated pushbutton Ø
22 mm silver contact

FRONT

Front bezel material:	Stainless steel
Front form:	round
Front dimension:	Ø 25 mm
Front bezel shape:	flush

MOUNTING

Mounting type:	Panel mounting
Mounting cut-out:	Ø 22 mm

OPERATING-/INDICATION PART

Lens illumination:	illuminative
Lens shape:	flush
Illumination colour:	Blue
Lens optics:	opaque
Lens material:	Stainless steel
Shape of illumination:	Ring
Lens colour:	Silver

ELECTRICAL CHARACTERISTICS

Operating voltage:	12 V AC/DC
Thermal current I _{th} :	5 A
Electrical lifetime:	50 000 cycles of operation

Switching voltage and switching current:	according to IEC 60947-5-1 (Silver contacts)	
	Service categorie AC-15	
	Voltage	Current
	24 VAC	1 A
	35 VAC	1 A (M12 versio
	110 VAC	1 A
	220 VAC	0.5 A
	Switch rating DC service categorie DC-13 (Silver contacts)	
	Voltage	Current
	24 VDC	0.7 A
	35 VDC	0.5 A (M12 vers
	110 VDC	0.2 A
	220 VDC	0.1 A

according to UL 508 (Silver contacts)	
$\cos\phi$ 0,75 ... 0,8	
Voltage	Current
120 VAC	5 A
240 VAC	3 A
24 VAC	1 A

Rated Operational Voltage Ue:	250 VAC
Pollution degree:	2, according to EN IEC 60947-1
Rated insulation voltage Ui:	250 V
Electric strength:	1500 VAC, 50 Hz 1 minute between life terminals and ground
Contacts:	1 C
Operation current:	7 mA

MECHANICAL CHARACTERISTIC

Operating Travel:	ca. 3 mm
Operating force:	4 N ... 7 N
Switching action:	Momentary
Tightening torque:	0.5 ... 0.6 Nm
Mechanical lifetime:	500 000 cycles of operation
Weight:	0.018 kg
Terminal:	Screw terminal
Contact material:	Silver
Switching system:	Snap-action switching element

AMBIENT CONDITION

IP front protection:	IP65, IP67
Storage temperature:	– 40 °C ... + 80 °C
Operating temperature:	

– 30 °C ... + 70 °C

Climate resistance:

Damp heat, 21 days according to IEC 60512-11

Shock resistance:

Max. 500 m / s² as per IEC 60068-2-27

Vibration resistance:

10 ... 500 Hz, amplitude 1.5 mm p-p according to IEC 60068-2-6

CERTIFICATE

Approbations:

CB, CCC, C UL, UL

Conformities:

CE, 2011 / 65 / EC (RoHS), 2014 / 35 / EU (LVD)

REACH:

REACH compliant

RoHS:

RoHS compliant

OTHER

Short Description:

Illuminated pushbutton Ø 22 mm silver contact, Momentary, 12 V AC/DC, 1 C, Screw terminal, round, Stainless steel, Blue, Silver

Kind of illumination:

Single-LED

Wiring diagrams:

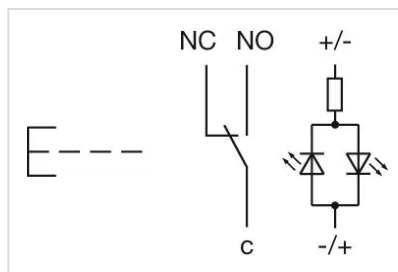

Component layouts:

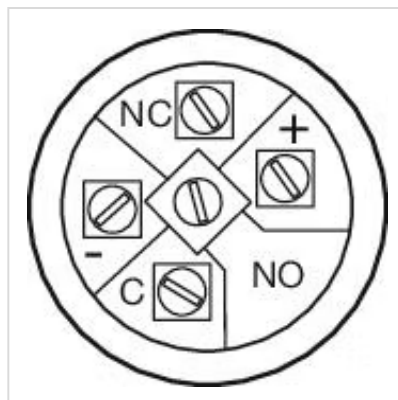

Dimension drawings:

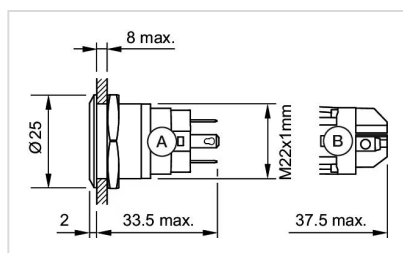

A = Solder terminal
B = Screw terminal

Mounting cut-outs:

