

## Pushbutton Ø 22 mm silver contact

82-6551.2000



<https://eao.com/p/82-6551.2000>

Your product:

---



82-6551.2000

Pushbutton Ø 22 mm silver contact

#### FRONT

Front bezel material:	Aluminium
Front dimension:	Ø 25 mm
Front bezel shape:	flush
Front form:	round

#### MOUNTING

Mounting cut-out:	Ø 22 mm
Mounting type:	Panel mounting

#### OPERATING-/INDICATION PART

Lens material:	Aluminium
Lens illumination:	non illuminative
Lens shape:	flush
Lens colour:	Nature
Lens optics:	opaque

#### ELECTRICAL CHARACTERISTICS

Contacts:	1 C
-----------	-----

Switching voltage and switching current:

according to IEC 60947-5-1 (Silver contacts)

Service categorie AC-15

Voltage

24 VAC

35 VAC

110 VAC

220 VAC

Current

1 A

1 A (M12 version)

1 A

0.5 A

Switch rating DC service categorie DC-13 (Silver contacts)

Voltage

24 VDC

35 VDC

110 VDC

220 VDC

Current

0.7 A

0.5 A (M12 version)

0.2 A

0.1 A

according to UL 508 (Silver contacts)

$\cos\phi$  0,75 ... 0,8

Voltage

120 VAC

240 VAC

24 VAC

Current

5 A

3 A

1 A

<b>Electrical lifetime:</b>	50 000 cycles of operation
<b>Thermal current I<sub>th</sub>:</b>	5 A
<b>Pollution degree:</b>	2, according to EN IEC 60947-1
<b>Electric strength:</b>	1500 VAC, 50 Hz 1 minute between life terminals and ground
<b>Rated insulation voltage U<sub>i</sub>:</b>	250 V
<b>Rated Operational Voltage U<sub>e</sub>:</b>	250 VAC

## MECHANICAL CHARACTERISTIC

<b>Tightening torque:</b>	0.5 ... 0.6 Nm
<b>Mechanical lifetime:</b>	500 000 cycles of operation
<b>Switching action:</b>	Maintained
<b>Switching system:</b>	Snap-action switching element
<b>Contact material:</b>	Silver
<b>Terminal:</b>	Soldering terminal, 2.8 x 0.5 mm
<b>Operating Travel:</b>	ca. 3 mm
<b>Weight:</b>	0.018 kg
<b>Operating force:</b>	4 N ... 7 N

## AMBIENT CONDITION

<b>Climate resistance:</b>	Damp heat, 21 days according to IEC 60512-11
<b>Storage temperature:</b>	– 40 °C ... + 80 °C
<b>Vibration resistance:</b>	

10 ... 500 Hz, amplitude 1.5 mm p-p according to IEC 60068-2-6

<b>Operating temperature:</b>	– 30 °C ... + 70 °C
<b>IP front protection:</b>	IP65, IP67
<b>Shock resistance:</b>	Max. 500 m / s <sup>2</sup> as per IEC 60068-2-27

## CERTIFICATE

<b>RoHS:</b>	RoHS compliant
<b>Approbations:</b>	CB, CCC, C UL, UL
<b>REACH:</b>	REACH compliant
<b>Conformities:</b>	CE, 2011 / 65 / EC (RoHS), 2014 / 35 / EU (LVD)

## OTHER

<b>Short Description:</b>	Pushbutton Ø 22 mm silver contact, Maintained, 1 C, Soldering terminal, 2.8 x 0.5 mm, round, Aluminium, Nature
---------------------------	--

### Mounting cut-outs:

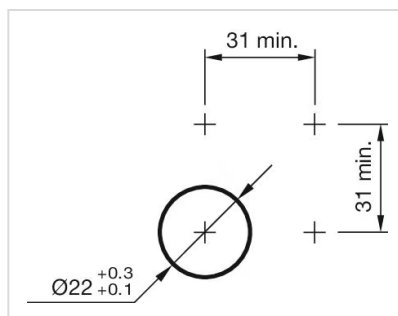

### Component layouts:

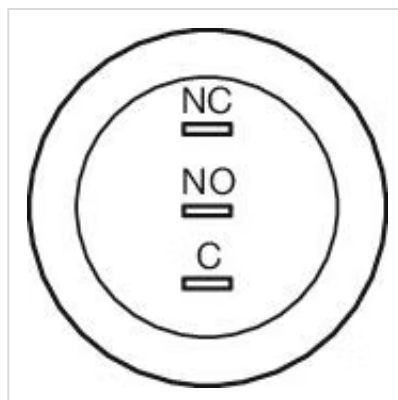

### Dimension drawings:

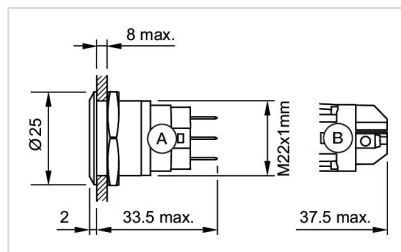

A = Solder terminal  
B = Screw terminal

#### Wiring diagrams:

