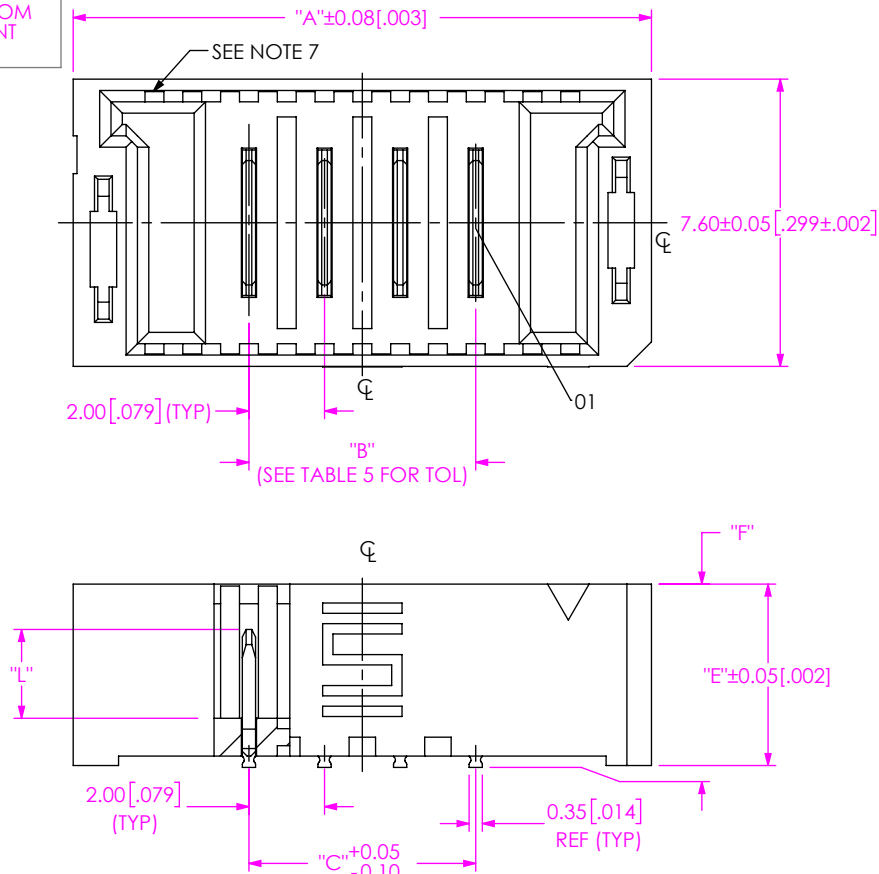

DO NOT
SCALE FROM
THIS PRINT

No OF POSITIONS	"A"	"B"	"C"	"D"	"J"
-02	11.30 [0.445]	2.00 [0.079]	2.00 [0.079]	9.70 [0.382]	1.59 [0.062]
-03	13.30 [0.524]	4.00 [0.157]	4.00 [0.157]	11.70 [0.461]	2.59 [0.102]
-04	15.30 [0.602]	6.00 [0.236]	6.00 [0.236]	13.70 [0.539]	3.59 [0.141]
-05	17.30 [0.681]	8.00 [0.315]	8.00 [0.315]	15.70 [0.618]	4.59 [0.181]
-06	19.30 [0.760]	10.00 [0.394]	10.00 [0.394]	17.70 [0.697]	5.59 [0.220]
-07	21.30 [0.839]	12.00 [0.472]	12.00 [0.472]	19.70 [0.776]	6.59 [0.259]
-08	23.30 [0.917]	14.00 [0.551]	14.00 [0.551]	21.70 [0.854]	7.59 [0.299]
-09	25.30 [0.996]	16.00 [0.630]	16.00 [0.630]	23.70 [0.933]	8.59 [0.338]
-10	27.30 [1.075]	18.00 [0.709]	18.00 [0.709]	25.70 [1.012]	9.59 [0.377]

NOTES:

- NOTE DELETED.
- NOTE DELETED.
- ORDERS WILL BE PACKAGED ACCORDING TO THE SAMTEC PACKAGING EFFICIENCY STANDARDS (SPES) FOUND ON WWW.SAMTEC.COM
- ATTACH LABEL -4X2 TO EACH REEL.
- PREVIOUS CALLOUTS -VT, -SM, -WT, AVAILABLE TO EXISTING CUSTOMERS ONLY.
- K-DOT SUPPLIED AS STANDARD, -K PART NUMBER OPTION AVAILABLE TO EXISTING CUSTOMER ONLY. IF THE S-UMPT THAT HAS K ON END OF CALLOUT HAS KAPTON, THE S-UMPT THAT HAS NO K THEN NO KAPTON.
- SLOTS ONLY AVAILABLE FOR -01.5 LEAD STYLE.

UMPT-XX-XX.X-XX-V-X-X-X-X-R

NO. OF POSITIONS

-02, -03, -04, -05,
-06, 07, -08, -09, -10

LEAD STYLE

-01.5: 1.5 mm
-02.5: 2.5mm
-06.5: 6.5 mm
-07.5: 7.5mm
-12.5: 12.5mm
(WELD TAB REQUIRED
FOR 12.5 LEAD STYLE)

PLATING

-T: MATTE TIN
-G: 10 μ " SELECTIVE GOLD IN CONTACT
AREA, 3 μ " GOLD ON TAIL,
MATTE TIN ON THE WELD TAB
-L: 10 μ " SELECTIVE GOLD IN CONTACT
AREA, MATTE TIN ON TAIL,
MATTE TIN ON THE WELD TAB
-S: 30 μ " SELECTIVE GOLD IN CONTACT
AREA, MATTE TIN ON TAIL,
MATTE TIN ON THE WELD TAB
-SL: 30 μ " SELECTIVE GOLD IN CONTACT
AREA, TIN-LEAD ON TAIL,
TIN-LEAD ON THE WELD TAB

TAPE & REEL (SEE NOTES 3 & 4)

-TR: TAPE & REEL
-FR: FULL REEL QTY TAPE & REEL

LATCH OPTIONS

(LEAVE BLANK FOR NO LATCH)
(ONLY AVAILABLE ON -02.5 LEAD STYLE)
(MUST CHOOSE WELD TAB OPTION)
-P: PLASTIC TOP LATCH
-M: METAL SIDE LATCHES

WELD TAB OPTIONS

(LEAVE BLANK FOR NO WELD TAB)
†-W: WELD TAB THROUGH HOLE
(REQUIRED FOR 12.5 LEAD STYLE)

HOT PLUG

(LEAVE BLANK FOR NO HOT PLUG)
(UNAVAILABLE FOR PLASTIC TOP LATCH)
*-H: HOT PLUG PIN 1

TAIL

†-S: SURFACE MOUNT

*-1: THROUGH HOLE FOR 1.57 [0.062] PCB
*-2: THROUGH HOLE FOR 2.36 [0.093] PCB

ORIENTATION

†-V: VERTICAL

(* = NOT TOOLED)
(† = SEE NOTE 5)

FIG 1

UMPT-04-01.5-XX-V-S-XR SHOWN

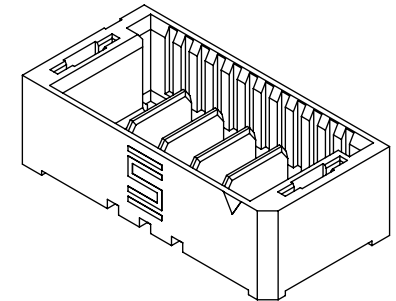
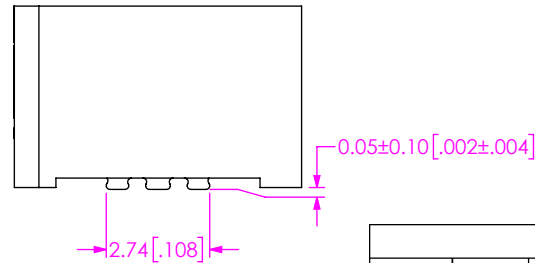

TABLE 3

LEAD STYLE	HOT PLUG OPTION	"E"	"F"	"G"	"K"	"L"
-01.5	BLANK	4.80 [0.189]	4.85 [0.191]	4.93 [0.194]	N/A	2.35 [0.093]
	-H	4.80 [0.189]	4.85 [0.191]	4.93 [0.194]	1.50 [0.059]	2.35 [0.093]
-02.5	BLANK	5.80 [0.228]	5.85 [0.230]	5.93 [0.233]	N/A	2.60 [0.102]
	-H	5.80 [0.228]	5.85 [0.230]	5.93 [0.233]	1.75 [0.069]	2.60 [0.102]
-06.5	BLANK	9.55 [0.376]	9.60 [0.378]	9.68 [0.381]	N/A	2.60 [0.102]
	-H	9.55 [0.376]	9.60 [0.378]	9.68 [0.381]	1.75 [0.069]	2.60 [0.102]
-07.5	BLANK	10.80 [0.425]	10.85 [0.427]	10.93 [0.430]	N/A	2.60 [0.102]
	-H	10.80 [0.425]	10.85 [0.427]	10.93 [0.430]	1.75 [0.069]	2.60 [0.102]
-12.5	BLANK	15.80 [0.622]	15.85 [0.624]	15.93 [0.627]	N/A	2.60 [0.102]
	-H	15.80 [0.622]	15.85 [0.624]	15.93 [0.627]	1.75 [0.069]	2.60 [0.102]

TABLE 2

UMPT LEAD STYLE	STACK HEIGHT		
	UMPS LEAD STYLE		
	-03.5	-05.5	-07.5
-01.5	5.00 [0.197]	7.00 [0.276]	9.00 [0.354]
-02.5	6.00 [0.236]	8.00 [0.315]	10.00 [0.394]
-06.5	10.00 [0.394]	12.00 [0.472]	14.00 [0.551]
-07.5	11.00 [0.433]	13.00 [0.512]	15.00 [0.591]
-12.5	16.00 [0.630]	18.00 [0.709]	20.00 [0.787]

TABLE 5

LEAD STYLE	"B" TOL.
-01.5	+0.08/-0.05
-02.5	+0.08/-0.05
-06.5	+0.05/-0.05
-07.5	+0.05/-0.05
-12.5	+0.05/-0.10

* PROPRIETARY NOTE *

THIS DOCUMENT CONTAINS CONFIDENTIAL AND PROPRIETARY INFORMATION AND ALL DESIGN, MANUFACTURING, REPRODUCTION, USE, PATENT RIGHTS AND SALES RIGHTS ARE EXPRESSLY RESERVED BY SAMTEC, INC. THIS DOCUMENT SHALL NOT BE DISCLOSED, IN WHOLE OR PART, TO ANY UNAUTHORIZED PERSON OR ENTITY NOR REPRODUCED, TRANSFERRED OR INCORPORATED IN ANY OTHER PROJECT IN ANY MANNER WITHOUT THE EXPRESS WRITTEN CONSENT OF SAMTEC, INC.

DO NOT SCALE DRAWING
SHEET SCALE: 5:1

MATERIAL:
INSULATOR: LCP
CONTACT: COPPER ALLOY
WELD TAB: COPPER ALLOY

samtec

520 PARK EAST BLVD, NEW ALBANY, IN 47150
PHONE: 812-944-6733 FAX: 812-948-5047
e-Mail: info@SAMTEC.com code 55322

DESCRIPTION:

ULTRA MICRO POWER TERMINAL

DWG. NO.

UMPT-XX-XX.X-XX-V-X-X-X-X-R

BY: JOE Z

03/22/2017

SHEET 1 OF 4

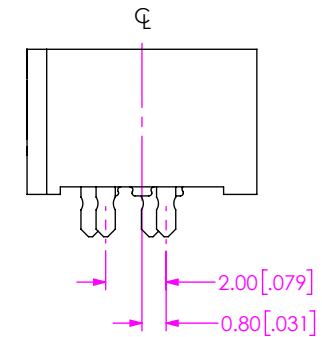
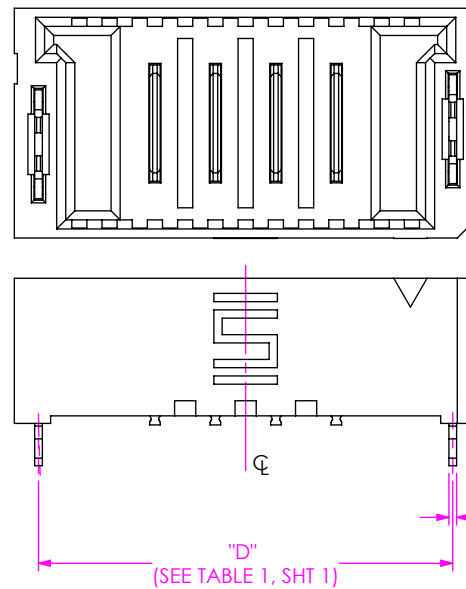
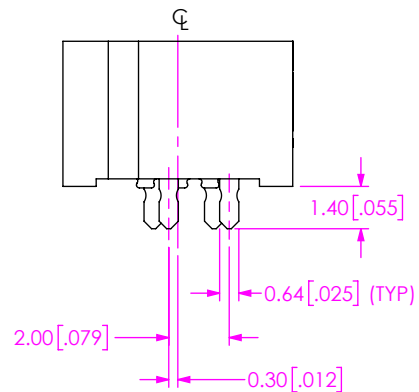
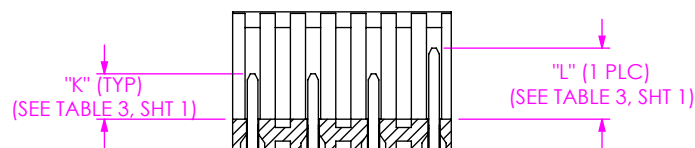
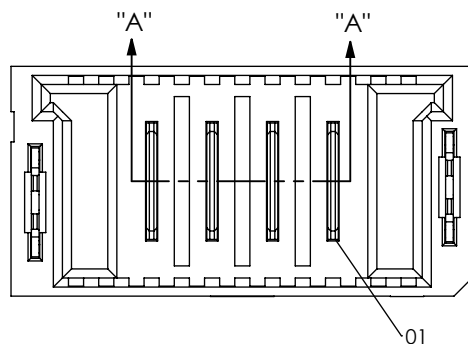

FIG 2
UMPT-04-01.5-XX-V-S-W-XR SHOWN
(DIFFERENT AS SHOWN, OTHERWISE SAME AS FIG 1)



SECTION "A"-A"
SCALE 4 : 1

FIG 4
UMPT-04-01.5-XX-V-S-H-W-XR SHOWN
(DIFFERENT AS SHOWN, OTHERWISE SAME AS FIG 1 & 2)

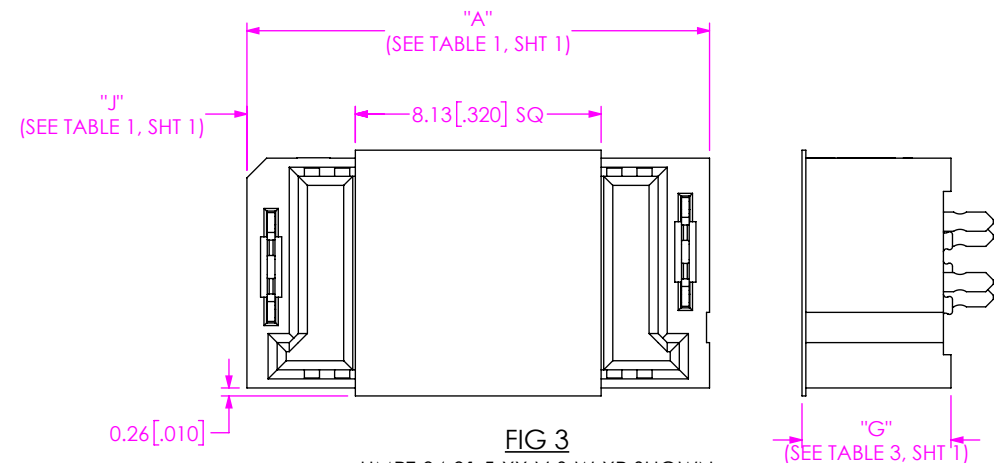

FIG 3
UMPT-04-01.5-XX-V-S-W-XR SHOWN
(DIFFERENT AS SHOWN, OTHERWISE SAME AS FIG 2)

PROPRIETARY NOTE
THIS DOCUMENT CONTAINS CONFIDENTIAL AND PROPRIETARY INFORMATION AND ALL DESIGN, MANUFACTURING, REPRODUCTION, USE, PATENT RIGHTS AND SALES RIGHTS ARE EXPRESSLY RESERVED BY SAMTEC, INC. THIS DOCUMENT SHALL NOT BE DISCLOSED, IN WHOLE OR PART, TO ANY UNAUTHORIZED PERSON OR ENTITY NOR REPRODUCED, TRANSFERRED OR INCORPORATED IN ANY OTHER PROJECT IN ANY MANNER WITHOUT THE EXPRESS WRITTEN CONSENT OF SAMTEC, INC.

SHEET SCALE: 2:1

samtec

520 PARK EAST BLVD, NEW ALBANY, IN 47150
PHONE: 812-944-6733 FAX: 812-948-5047
e-Mail: info@SAMTEC.com code 55322

DESCRIPTION:
ULTRA MICRO POWER TERMINAL

DWG. NO.
UMPT-XX-XX.X-XX-V-X-X-X-X-XR

BY: JOE Z 03/22/2017 SHEET 2 OF 4

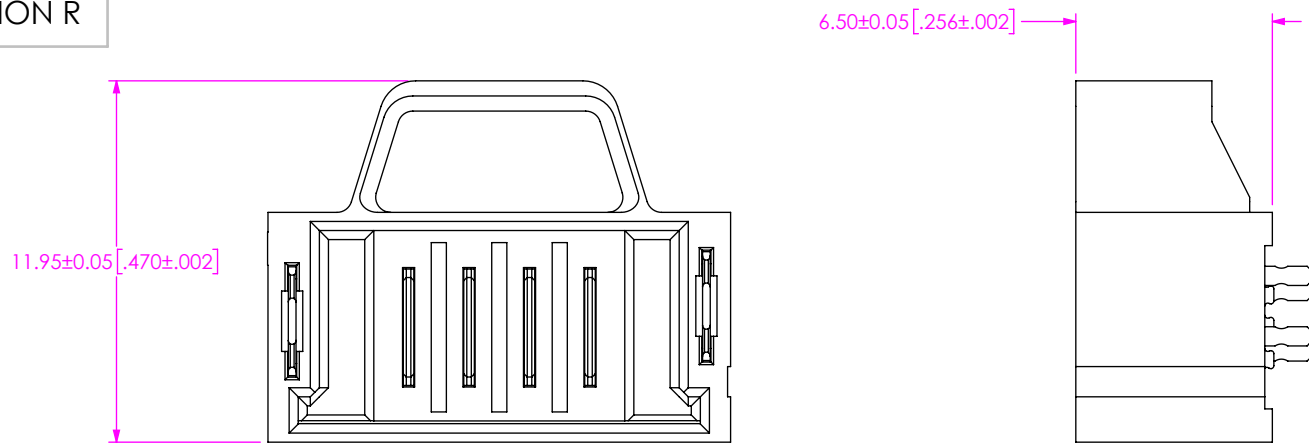

FIG 5
UMPT-04-02.5-XX-V-S-W-P-XR SHOWN
(DIFFERENT AS SHOWN, OTHERWISE SAME AS FIG 2)

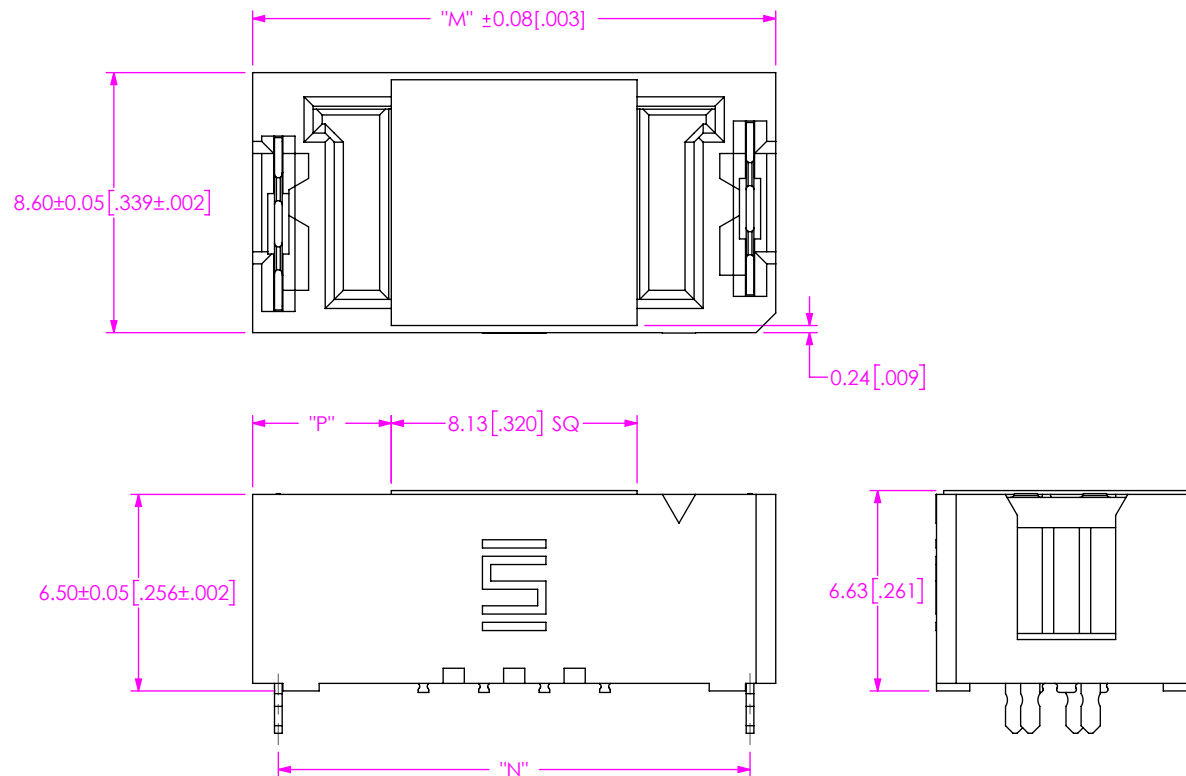

FIG 6
UMPT-04-02.5-XX-V-S-W-M-XR SHOWN
(DIFFERENT AS SHOWN, OTHERWISE SAME AS FIG 2)

TABLE 4			
No OF POSITIONS	"M"	"N"	"P"
-02	13.30 [.524]	11.600 [.4567]	2.59 [.102]
-03	15.30 [.602]	13.600 [.5354]	3.59 [.141]
-04	17.30 [.681]	15.600 [.6142]	4.59 [.181]
-05	19.30 [.760]	17.600 [.6929]	5.59 [.220]
-06	21.30 [.839]	19.600 [.7717]	6.59 [.259]
-07	23.30 [.917]	21.600 [.8504]	7.59 [.299]
-08	25.30 [.996]	23.600 [.9291]	8.59 [.338]
-09	27.30 [1.075]	25.600 [1.0079]	9.59 [.377]
-10	29.30 [1.154]	27.600 [1.0866]	10.59 [.417]

PROPRIETARY NOTE

THIS DOCUMENT CONTAINS CONFIDENTIAL AND PROPRIETARY INFORMATION AND ALL DESIGN, MANUFACTURING, REPRODUCTION, USE, PATENT RIGHTS AND SALES RIGHTS ARE EXPRESSLY RESERVED BY SAMTEC, INC. THIS DOCUMENT SHALL NOT BE DISCLOSED, IN WHOLE OR PART, TO ANY UNAUTHORIZED PERSON OR ENTITY NOR REPRODUCED, TRANSFERRED OR INCORPORATED IN ANY OTHER PROJECT IN ANY MANNER WITHOUT THE EXPRESS WRITTEN CONSENT OF SAMTEC, INC.

DO NOT SCALE DRAWING
SHEET SCALE: 5:1

samtec

520 PARK EAST BLVD, NEW ALBANY, IN 47150
PHONE: 812-944-6733 FAX: 812-948-5047
e-Mail: info@SAMTEC.com code 55322

DESCRIPTION:
ULTRA MICRO POWER TERMINAL

DWG. NO.
UMPT-XX-XX.X-XX-V-X-X-X-XR

BY: JOE Z 03/22/2017 SHEET 3 OF 4

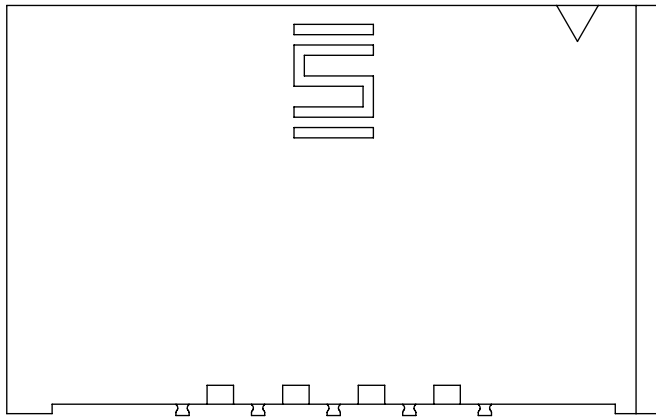
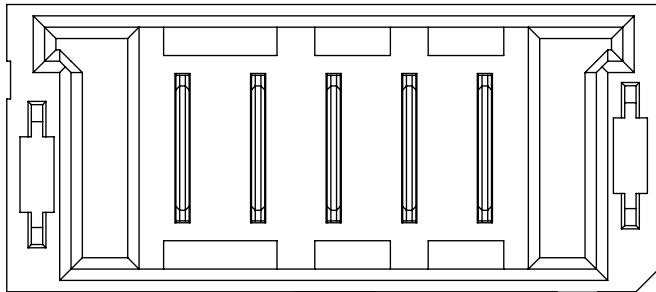

FIG 7
UMPT-05-07.5-XX-V-S-XR SHOWN
(DIFFERENT AS SHOWN, OTHERWISE SAME AS FIG 1)

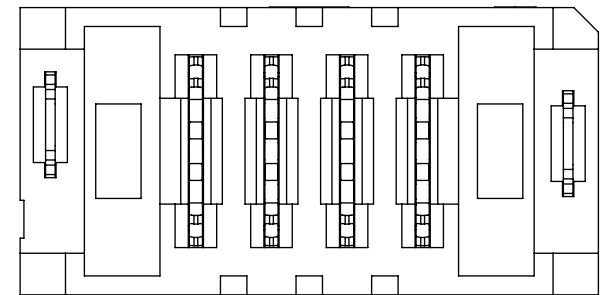
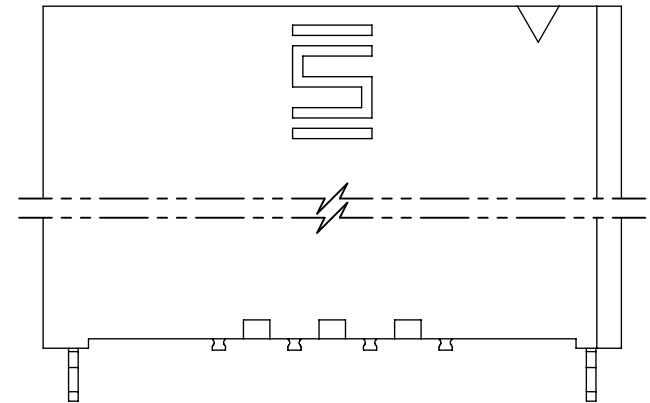
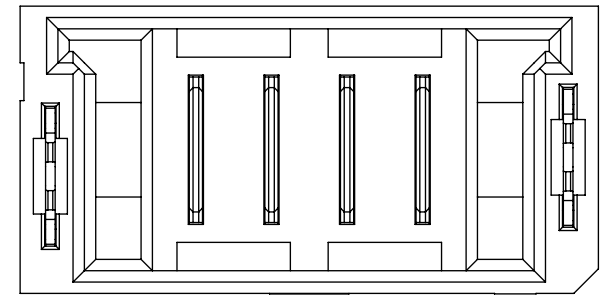

FIG 8
UMPT-04-12.5-XX-V-S-XR SHOWN
(DIFFERENT AS SHOWN, OTHERWISE SAME AS FIG 1 & 2)

PROPRIETARY NOTE
THIS DOCUMENT CONTAINS CONFIDENTIAL AND PROPRIETARY INFORMATION AND ALL DESIGN, MANUFACTURING, REPRODUCTION, USE, PATENT RIGHTS AND SALES RIGHTS ARE EXPRESSLY RESERVED BY SAMTEC, INC. THIS DOCUMENT SHALL NOT BE DISCLOSED, IN WHOLE OR PART, TO ANY UNAUTHORIZED PERSON OR ENTITY NOR REPRODUCED, TRANSFERRED OR INCORPORATED IN ANY OTHER PROJECT IN ANY MANNER WITHOUT THE EXPRESS WRITTEN CONSENT OF SAMTEC, INC.

DO NOT SCALE DRAWING
SHEET SCALE: 5:1

samtec

520 PARK EAST BLVD, NEW ALBANY, IN 47150
PHONE: 812-944-6733 FAX: 812-948-5047
e-Mail: info@SAMTEC.com code 55322

DESCRIPTION:
ULTRA MICRO POWER TERMINAL

DWG. NO.
UMPT-XX-XX.X-XX-V-X-X-X-XR

BY: JOE Z 03/22/2017 SHEET 4 OF 4