

# Actuator

704.230.6



<https://eao.com/p/704.230.6>

Your product:

---



## 704.230.6 Actuator

### FRONT

|                       |               |
|-----------------------|---------------|
| Front form:           | square        |
| Front bezel colour:   | Grey          |
| Front bezel material: | Plastic       |
| Front dimension:      | 30 mm x 30 mm |

### MOUNTING

|         |        |
|---------|--------|
| Design: | raised |
|---------|--------|

### OPERATING-/INDICATION PART

|                    |              |
|--------------------|--------------|
| Lens colour:       | Blue         |
| Lens illumination: | illuminative |
| Lens shape:        | flush        |
| Lens material:     | Plastic      |
| Lens optics:       | transparent  |

### ELECTRICAL CHARACTERISTICS

|            |   |
|------------|---|
| Standards: | The switches comply with the "Standards for low-voltage switching devices" DIN EN 60947-1 |
|------------|---|

### MECHANICAL CHARACTERISTIC

|                      |                             |
|----------------------|-----------------------------|
| Operating force:     | 8 N                         |
| Mechanical lifetime: | ≤3 Mio. cycles of operation |
| Terminal:            | Screw terminal              |

**Weight:** 0.056 kg

**Operating Travel:** ca. 5.8 mm ± 0.2 mm

**Switching action:** Momentary

#### AMBIENT CONDITION

**IP Protection:** IP65 front side

**Operating temperature:** – 40 °C ... + 55 °C

**Storage temperature:** – 40 °C ... + 85 °C

#### OTHER

**Housing colour:** Black

**max. number of switching elements:** 3

**Short Description:** Actuator, 30 mm x 30 mm, flush, illuminative, Blue, Plastic, transparent, square, Grey, Plastic, Momentary, Screw terminal

**Housing material:** Plastic

**Hints:** Frontring with protective cover to be mounted with a torque of 0.4 Nm onto actuator, Max. 3 switching elements can be clipped on

**Wiring diagrams:**

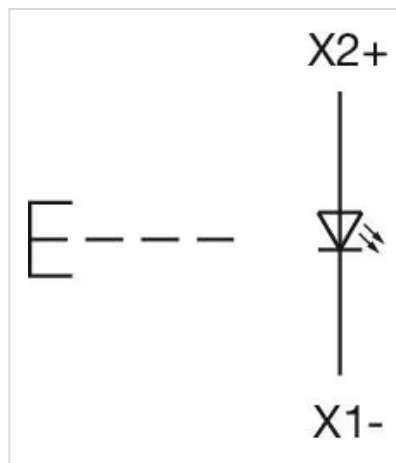

**Mounting cut-outs:**

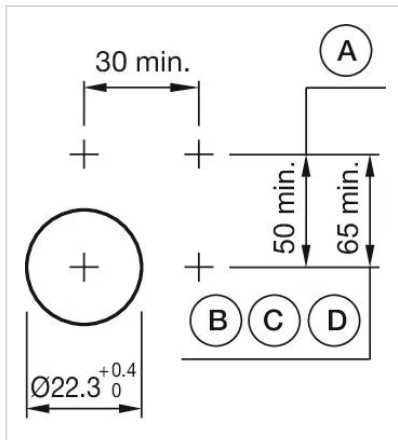

A = Screw terminal  
 B = Push-in terminal (PIT)  
 C = Plug-in terminal 6.3 mm x 0.8 mm  
 D = Double plug-in terminal 6.3 mm x 0.8 mm

#### Dimension drawings:

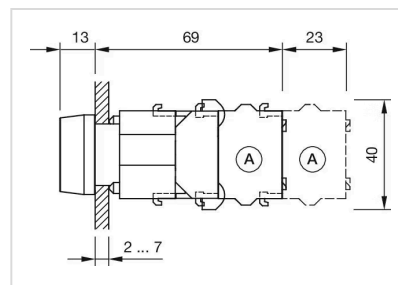

A = Screw terminal