

DESCRIPTION: 2B // QUIK-LOQ // F // RIGHT ANGLE PANEL MOUNT // PCB MOUNT

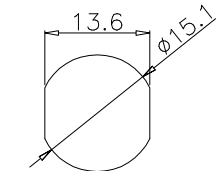

RECOMMENDED  
PANEL CUTOUT  
+0.1/-0.0

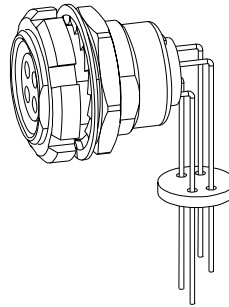
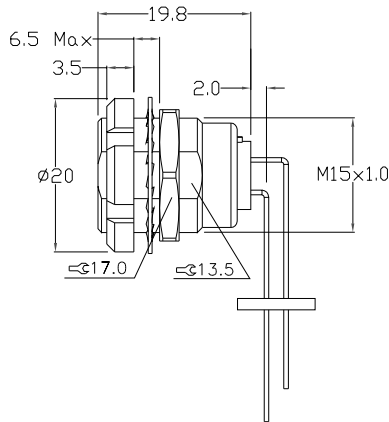

822BRY-213R001

SERIES \_\_\_\_\_  
RIGHT ANGLE \_\_\_\_\_  
POSITIONS \_\_\_\_\_  
YY = SEE POSITION CHART  
GENDER \_\_\_\_\_  
2 = FEMALE  
TYPE \_\_\_\_\_  
1 = PCB MOUNT (PANEL MOUNT)  
KEY ORIENTATION (SEE KEY ORIENTATION CHART) \_\_\_\_\_  
3 = 1 KEY // 0°  
A = 2 KEYS // 30°  
CONTACT PLATING \_\_\_\_\_  
1 = 7μ" GOLD PLATED

KEY ORIENTATION CHART	
KEY ORIENTATION	DIAGRAM
3	
A	

## SPECIFICATIONS:

### MATERIALS:

SHELL & NUTS: BRASS, 196u" CHROME PLATED MIN.  
CONTACTS: 7u" GOLD PLATED BRASS OVER 196u" NICKEL MIN.  
INSULATOR: PPS (HIGH TEMPERATURE)

### MECHANICAL:

MATING CYCLES: 5000 CYCLES  
OPERATING TEMPERATURE: -40°C TO +200°C  
PROCESS TEMPERATURE: 260°C FOR 5 SECONDS  
SHIELDING: 75dB @ 10MHz // 40dB @ 1GHz  
IP RATING: 50  
MAX TORQUE VALUE: 6.0Nm

POSITION CHART // ELECTRICAL/WIRE SPECIFICATIONS

\*solder side view of insulator

POSITIONS	CONTACTS*	CONTACT Ø	MAX CONTACT mΩ	WORKING VOLTAGE	MAX AMPERAGE
02		2.00mm	3.0 mΩ	700 V	12.0 A
03		1.60mm	4.0 mΩ	800 V	12.0 A
04		1.30mm	5.0 mΩ	610 V	12.0 A
06		1.30mm	5.0 mΩ	450 V	12.0 A
08		0.90mm	6.0 mΩ	500 V	6.0 A
10		0.90mm	6.0 mΩ	500 V	6.0 A
12		0.70mm	7.5 mΩ	480 V	6.0 A
14		0.70mm	7.5 mΩ	380 V	6.0 A
16		0.70mm	7.5 mΩ	315 V	6.0 A
19		0.70mm	7.5 mΩ	315 V	5.0 A
26		0.50mm	10.0 mΩ	315 V	2.0 A

RoHS COMPLIANT



THESE DRAWINGS AND SPECIFICATIONS ARE THE PROPERTY OF NorComp AND SHALL NOT BE REPRODUCED, COPIED OR USED AS THE BASIS FOR THE MANUFACTURE OR SALE OF APPARATUS WITHOUT WRITTEN PERMISSION.

DRAWN:  
M. SIGMON

DATE:  
02/15/2016

UNITS = mm

DO NOT SCALE FROM DRAWING

NorComp

SCALE:  
NTS

SHEET 1 OF 2

REV 4

DWG NO.

822BRY-213R001

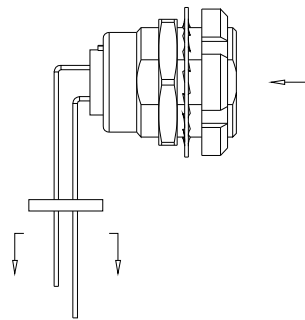

RECOMMENDED  
PCB LAYOUTS

2P

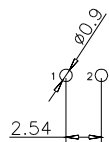

3P

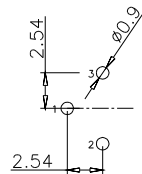

4P

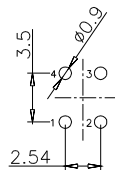

6P

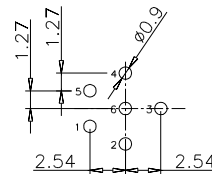

8P

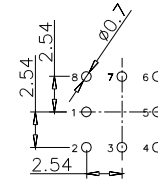

10P

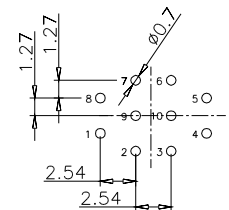

12P

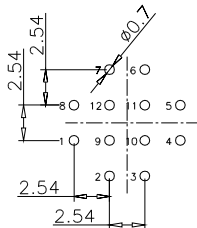

14P

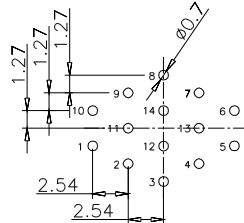

16P

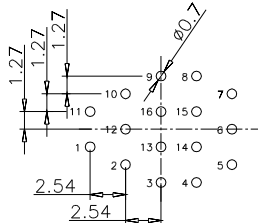

19P

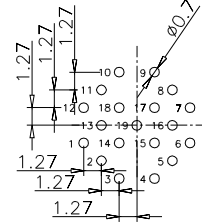

26P

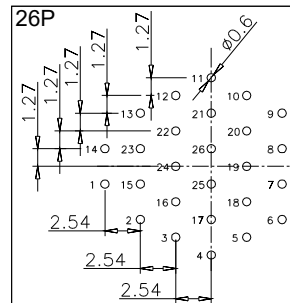

RoHS COMPLIANT



THESE DRAWINGS AND SPECIFICATIONS ARE THE PROPERTY OF NorComp AND SHALL NOT BE REPRODUCED, COPIED OR USED AS THE BASIS FOR THE MANUFACTURE OR SALE OF APPARATUS WITHOUT WRITTEN PERMISSION.

DRAWN:  
M. SIGMON

DATE:  
02/15/2016

UNITS = mm

DO NOT SCALE FROM DRAWING

NorComp

SCALE:  
NTS

SHEET OF  
2 2

REV  
4

DWG NO.

822BRYY-213R001