

Actuator

704.094.0



<https://eao.com/p/704.094.0>

Your product:



704.094.0 Actuator

FRONT

Front dimension:	Ø 29 mm
Front bezel material:	Plastic
Front bezel colour:	Grey

MOUNTING

Design:	raised
---------	--------

OPERATING-/INDICATION PART

Lever material:	plastic
Lever colour:	Black
Lever shape:	long

ELECTRICAL CHARACTERISTICS

Standards:	The switches comply with the "Standards for low-voltage switching devices" DIN EN 60947-1
------------	---

MECHANICAL CHARACTERISTIC

Switching positions:	3 positions
Mechanical lifetime:	≤2.5 Mio. cycles of operation
Switching angle:	42° left / 42° right
Weight:	0.034 kg
Switching action:	Momentary - Rest - Momentary

AMBIENT CONDITION

Operating temperature: – 40 °C ... + 55 °C

IP Protection: IP65 front side

Storage temperature: – 40 °C ... + 85 °C

OTHER

max. number of switching elements: 3

Hints: Max. 3 switching elements can be clipped on

Short Description: Actuator, Ø 29 mm, non illuminative, Black, long, Grey, Plastic, Momentary - Rest - Momentary

Mounting cut-outs:

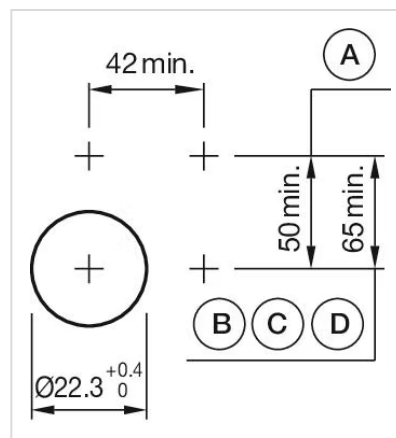

A = Screw terminal
B = Push-in terminal (PIT)
C = Plug-in terminal 6.3 mm x 0.8 mm
D = Double plug-in terminal 6.3 mm x 0.8 mm

Dimension drawings:

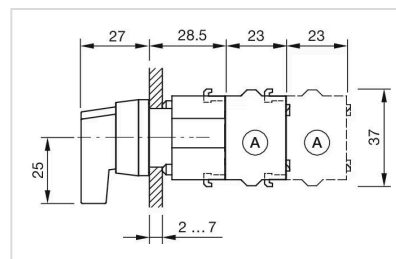

A = Screw terminal

Switching positions:

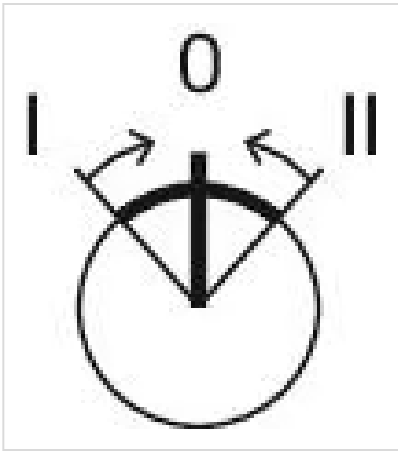

Wiring diagrams:

