

SUMMARY

Wires

Low voltage 4



Image is for illustrative purpose only

Series	3B
Termination type	Female crimp
IP rating	50
AWG wire size	16.00 - 12.00
Cable Ø	10.80 - 11.90 mm
Status	active
Matching parts	FGG.3B.304.CYCD12

Download

[Request a quote](#)

[Catalog](#)

TECHNICAL DETAILS

Mechanics

Shell Style/Model	PE*: Fixed receptacle, nut fixing, cable collet (back panel mounting)
Keying	1 key (alpha=0, plug: male contacts, receptacle: female contacts)
Housing Material	Brass (chrome plated [SAE AMS 2460]) shell and collet nut, nickel plated [SAE AMS QQ N 290] brass latch sleeve and mid pieces
Weight	57.69 g

Performance

Configuration	3B.304 : 4 Low Voltage
Insulator	Y: PEEK for crimp contacts
Rated Current	19 Amps

Specifications

Contact Type:	Crimp
Contact Retention:	65 N
Contact Dia.:	2 mm (0.079in)
Bucket Dia.:	2.4 mm (0.094in)
Min. Conductor:	1.5 mm ² (AWG 16)
Max. Conductor:	2.5 mm ² (AWG 12)
R (max):	3.3 mOhm
Vtest (contact-shell):	2200 V (AC), 3110 V (DC)

LEMO products and services are provided "as is". LEMO makes no warranties or representations with regard to LEMO product & services or use of them, express, implied or statutory, including for accuracy, completeness, or security. The user is fully responsible for his products and applications using LEMO components.

Vtest (contact-contact): 2500 V (AC), 3540 V (DC)

Others

- Endurance (Shell): 5000
- Temp (min / max): -55°C / +250°C
- Humidity (max): <=95% [at 60 deg C / 140 F]
- Vibration: 15 g [10 Hz - 2000 Hz]
- Shock Resistance: 100 g [6 ms]
- Climatical Category: 50/175/21
- Shielding (min): 75 dB (10 MHz)
- Shielding (min): 40 dB (1 GHz)
- Salt Spray Corrosion: >1000 hr

DRAWINGS

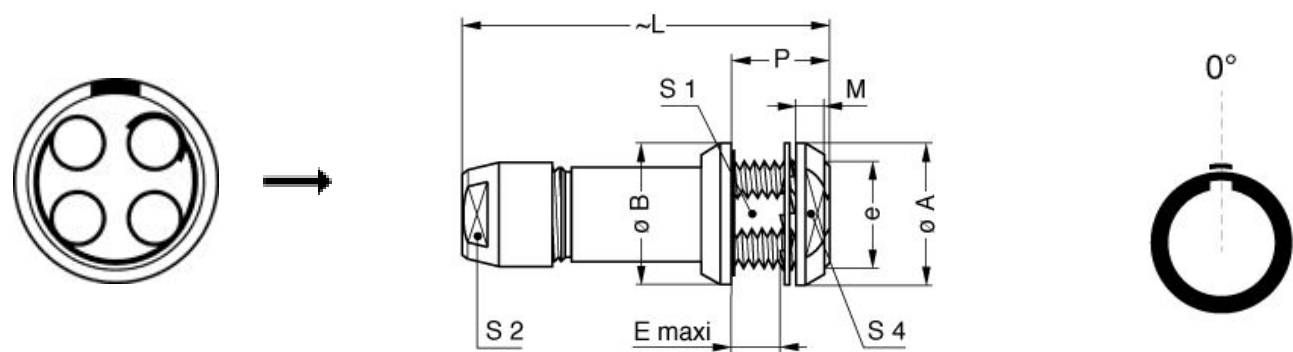

Dimensions

	A	B	E	L	M	P	S1	S2	S4	e
mm.	24	25	5	56	4.5	12	16.5	14	20	M18x1.0
in.	0,94	0,98	0,20	2,20	0,18	0,47	0,65	0,55	0,79	

RECOMMENDED BY LEMO

Tools

LEMO products and services are provided “as is”. LEMO makes no warranties or representations with regard to LEMO product & services or use of them, express, implied or statutory, including for accuracy, completeness, or security. The user is fully responsible for his products and applications using LEMO components.

Crimp Tool:	DPC.91.101.A
Crimp settings:	AWG/Selector = 12-14-16/8-7-6
Positionner:	DCE.91.203.BVCM
Extractor:	DCC.91.202.5LA
Replacement contact:	EGG.3B.675.ZZM
Spanner wrench:	DCD.3B.040.PA140

LEMO products and services are provided "as is". LEMO makes no warranties or representations with regard to LEMO product & services or use of them, express, implied or statutory, including for accuracy, completeness, or security. The user is fully responsible for his products and applications using LEMO components.