

Actuator

704.011.018



<https://eao.com/p/704.011.018>

Your product:



704.011.018 Actuator

FRONT

Front dimension:	Ø 35 mm
Front bezel colour:	Nature
Front form:	round
Front bezel material:	Aluminium

MOUNTING

Mounting cut-out:	Ø 30.5 mm
Design:	flush

OPERATING-/INDICATION PART

Lens optics:	opaque
Lens colour:	Black
Lens illumination:	non illuminative
Lens shape:	flush
Lens material:	Aluminium

ELECTRICAL CHARACTERISTICS

Standards:	The switches comply with the "Standards for low-voltage switching devices" DIN EN 60947-1
------------	---

MECHANICAL CHARACTERISTIC

Operating force:	8 N
Operating Travel:	ca. 5.8 mm ± 0.2 mm

Mechanical lifetime:	≤3 Mio. cycles of operation
Weight:	0.051 kg
Switching action:	Momentary

AMBIENT CONDITION

IP Protection:	IP65 front side
Storage temperature:	– 40 °C ... + 85 °C
Operating temperature:	– 40 °C ... + 55 °C

OTHER

Housing material:	Plastic
max. number of switching elements:	3
Hints:	Max. 3 switching elements can be clipped on, The colour of anodised aluminium parts can vary due to technical production reasons
Housing colour:	Grey
Short Description:	Actuator, Ø 30.5 mm, Ø 35 mm, flush, non illuminative, Black, Aluminium, opaque, round, Nature, Aluminium, anodised, Momentary
Wiring diagrams:	

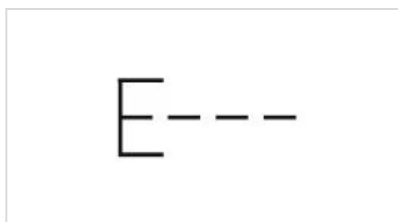

Dimension drawings:

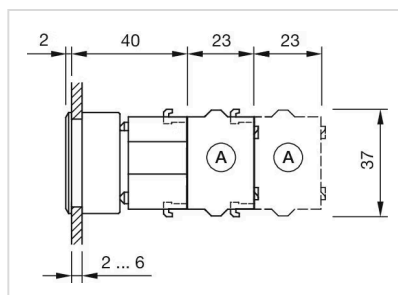

A = Screw terminal

Mounting cut-outs:

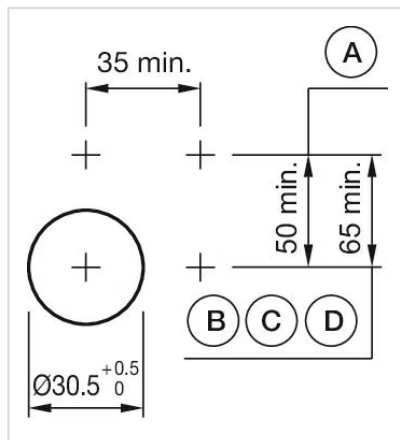

- A = Screw terminal
- B = Push-in terminal (PIT)
- C = Plug-in terminal 6.3 mm x 0.8 mm
- D = Double plug-in terminal 6.3 mm x 0.8 mm