

SIGN	DATE	DESCRIPTION	APPROVER
△	2/06'06	Part No. changed	Tony
△	3/10'09	Structure changed	Seamus
△	3/10'09	Dimension changed	Seamus
△	11/03'12	Change the screw plating specification	Jacky
△	11/03'12	Change the dimensional tolerance	Jacky

*THIS IS CAD DRAWING, DO NOT REVISE MANUALLY!!!*

N=Number of poles  
Dimension A&B&C

DIM A	(N+1)×8.25
DIM B	(N-1)×8.25
DIM C	(N+2)×8.25+2.5

Poles	Tolerance
2p-5p	+0.25/-0.25
6p-10p	+0.35/-0.35
11p-18p	+0.40/-0.40
19p-30p	+0.50/-0.50

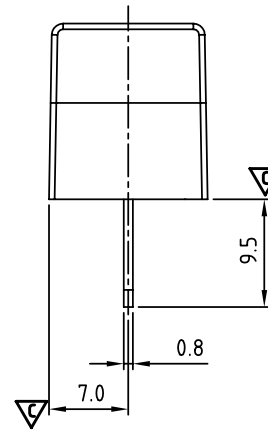
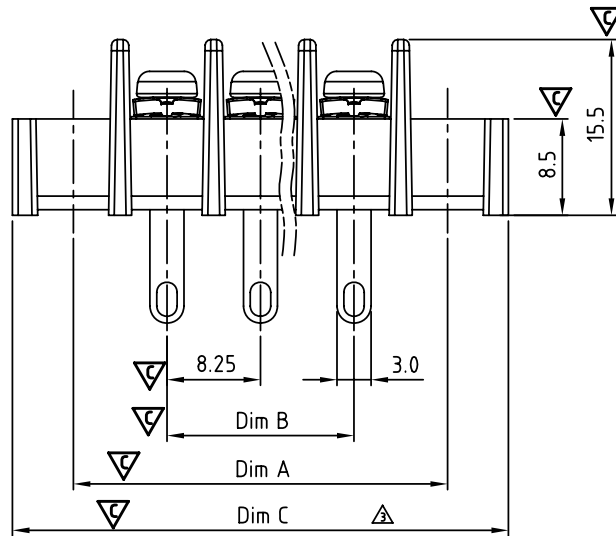
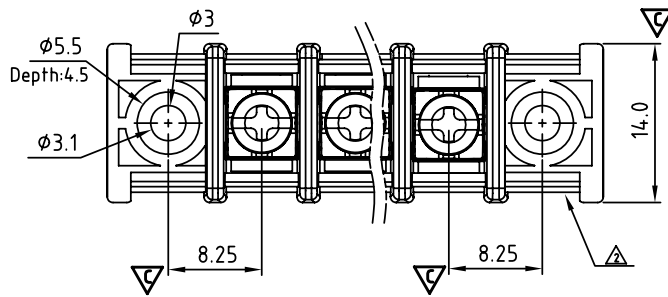

**MATERIALS ELECTRICAL**

**RATED VOLTAGE & CURRENT:** 300 V, 20 A  
**WITHSTAND VOLTAGE:** AC 2000 V/Min  
**INSULATION RESISTANCE:** 1000 MΩ OR MORE AT DC 500 V  
**OPERATING TEMPERATURE RANG:** -40 °C ~ +115 °C  
**SCREW TORQUE VALUE:** 8.8 Lb-In.  
**WIRE RANGE:** 22 - 12 AWG  
**1) MOLDED PARTS:** POLYIMIDE 66, UL 94 V-0 BLACK  
**2) TERMINAL:** BRASS, 0.8t, Tin PLATED  
**3) TERMINAL SCREWS:** STEEL, M3

APPROVAL:

△ PART NO.:  
Critical dimension:

**YK 413 xx 3 x x 00G**

NO. OF POLES  
02: 2 POLES  
03: 3 POLES  
04: 4 POLES  
:  
30: 30 POLES

RoHS compliant  
(lead<4%) In copper Alloy

MARK  
0: "@" MARK  
1: "ANY" MARK

TERMINAL & SCREW PLATED  
0: TERMINAL & SCREW: G/F  
△ 1: TERMINAL: G/F, SCREW: Zinc  
2: TERMINAL: Sn, SCREW: G/F  
△ 3: TERMINAL: Sn, SCREW: Zinc

**ANYTEK**

**CUSTOMER COPY**

ALL RIGHTS RESERVED. REPRODUCTION OR ISSUE TO THIRD PARTIES IN ANY FORM WHATSOEVER IS NOT PERMITTED WITHOUT WRITTEN AUTHORITY FROM THE PROPRIETOR. PROPERTY OF ANYTEK TECHNOLOGY CO., LTD

TITLE		YK-413 With Flange Series				
PART NO.		YK413xx3xx00G		DWG NO.	8YK0002-413	
APPROVED	CHECKED	DESIGNED	DRAWN	CUST NO.		Tolerance
		Jacky 2012.11.03	Jacky 2012.11.03			X. ±0.50
					UNIT: mm	X.X ±0.30
					SCALE: NONE	X.XX ±0.10
				SHEET: 01/01	REV.: E	X° ±1°