

Actuator

704.062.618



<https://eao.com/p/704.062.618>

Your product:



704.062.618 Actuator

FRONT

Front form:	round
Front bezel colour:	Nature
Front bezel material:	Aluminium
Front dimension:	Ø 35 mm

MOUNTING

Mounting cut-out:	Ø 30.5 mm
Design:	flush

OPERATING-/INDICATION PART

Lens shape:	flush
Lens colour:	Blue
Lens optics:	transparent
Lens material:	Plastic
Lens illumination:	illuminative

ELECTRICAL CHARACTERISTICS

Standards:	The switches comply with the "Standards for low-voltage switching devices" DIN EN 60947-1
------------	---

MECHANICAL CHARACTERISTIC

Operating force:	8 N
Operating Travel:	ca. 5.8 mm ± 0.2 mm

Mechanical lifetime:	≤3 Mio. cycles of operation
Terminal:	Screw terminal
Switching action:	Maintained
Weight:	0.067 kg

AMBIENT CONDITION

Storage temperature:	– 40 °C ... + 85 °C
Operating temperature:	– 40 °C ... + 55 °C
IP Protection:	IP65 front side

OTHER

max. number of switching elements:	3
Housing colour:	Grey
Housing material:	Plastic
Short Description:	Actuator, Ø 30.5 mm, Ø 35 mm, flush, illuminative, Blue, Plastic, transparent, round, Nature, Aluminium, anodised, Maintained, Screw terminal
Hints:	Max. 3 switching elements can be clipped on, The lamp block will be delivered with screw terminal, The colour of anodised aluminium parts can vary due to technical production reasons

Mounting cut-outs:

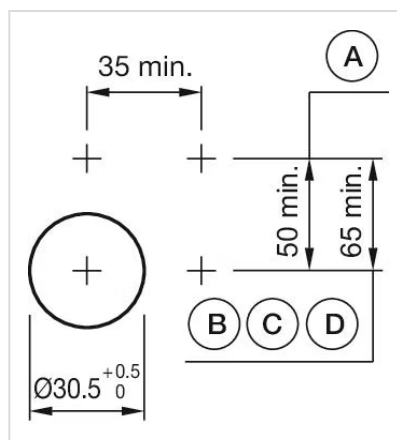

A = Screw terminal
 B = Push-in terminal (PIT)
 C = Plug-in terminal 6.3 mm x 0.8 mm
 D = Double plug-in terminal 6.3 mm x 0.8 mm

Wiring diagrams:

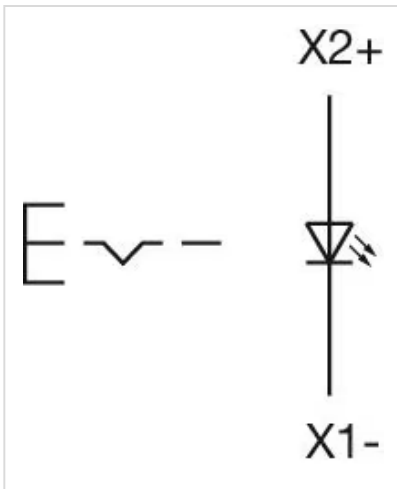

Dimension drawings:

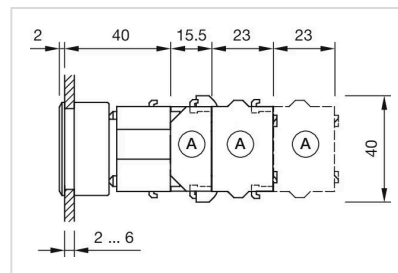

A = Screw terminal