

NOTES:

1. PART NUMBER VARIABLES: (SEE SHEET 2 FOR ADDITIONAL INFORMATION)  
NOT ALL POSSIBLE CONFIGURATIONS SHOWN ON THIS DRAWING ARE AVAILABLE AS STANDARD PRODUCTS.  
PLEASE CHECK WITH RAYCHEM TO CONFIRM AVAILABILITY.

MTC100-BXX-PXX-XXX  
MODIFICATION NUMBER. REFER TO APPLICABLE MOD DESCRIPTION SHEET.  
"BLANK WHEN NOT APPLICABLE"

1=LONG TAIL  
2=SHORT TAIL  
3=90° IN "B" DIRECTION

2=NICKEL PLATE  
3=CADMIUM OVER NICKEL PLATE

1=1 INCH  
2=2 INCH

F=FLANGED WITH STANDARD PANEL GASKET  
S=FLANGED/SHEilded WITH EME PANEL GASKET  
J=FLANGELESS  
Y=SPECIALS: REFER TO INDIVIDUAL SPECIFICATION CONTROL DRAWINGS FOR DESCRIPTIONS

2. A BOX MOUNT RECEPTACLE MATES WITH A MTC PLUG CONTAINING SOCKET INSERTS.  
REFER TO APPLICABLE RAYCHEM SPECIFICATION CONTROL DRAWING FOR DETAILS.
3. FOR KEYING INFORMATION, SEE RAYCHEM DRAWING D-659-0080.
4. THESE ITEMS ARE SUPPLIED UNASSEMBLED.
5. DIMENSION SHOWN IS WITH MATED PLUG CONNECTOR: a. WITH CABLE CLAMP  
b. WITHOUT CABLE CLAMP AND WITHOUT EARS
6. THIS BOX MOUNT RECEPTACLE IS REAR PANEL MOUNTED BY REMOVING AS MANY PANEL WASHERS AS REQUIRED TO ACCOMMODATE THE THICKNESS OF THE PANEL BEING USED.  
SEE SHEET 2, TABLE 2, AND SHEET 3, FIGURE 2.
7. FOR FRONT PANEL MOUNTING OF A FLANGELESS CONNECTOR, USE HARDWARE KIT CHA-0038 AND REFER TO THAT SPECIFICATION CONTROL DRAWING FOR APPLICATION DETAILS.
8. WIRE WRAPPABLE POST DESIGNED TO MIL-STD-1130.
9. WHEN MOUNTING FLANGELESS CONNECTORS ADJACENT TO ONE ANOTHER AND USING THE .400 MINIMUM CENTERLINE LOCATION, THERE WILL BE NO WEB BETWEEN PANEL CUT-OUTS. SEE SHEET 3, FIGURE 2 FOR DETAILS.
10. KIT NUMBER CHA-0046 IS AVAILABLE FOR MOUNTING A CONNECTOR TO A PRINTED CIRCUIT BOARD. SEE SHEET 3, FIGURE 3 FOR HOLE PATTERN RECOMMENDATION.
11. SEE SHEET 3, TABLE 3, FOR WEIGHTS. WEIGHTS SHOWN ARE WITHOUT DUST CAP AND WITHOUT POST PROTECTOR.
12. DUST CAP SUPPLIED WITH ASSEMBLY.
13. TORQUE MOUNTING HARDWARE TO: 14-16 IN.-LBS.

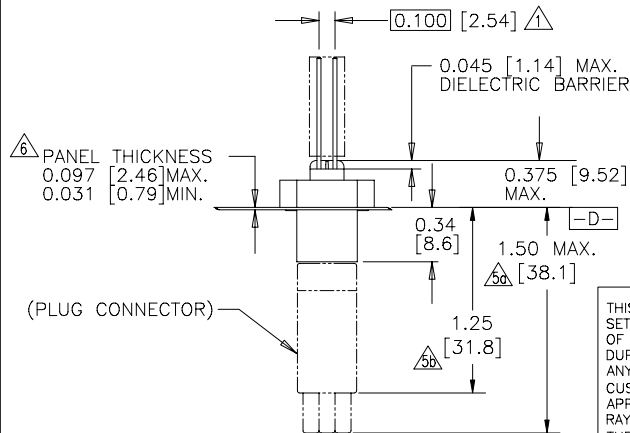

VIEW W-W

SPECIFICATION CONTROL DRAWING

THIS DRAWING AND THE INFORMATION SET FORTH HEREON ARE THE PROPERTY OF RAYCHEM CORPORATION. PUBLICATION, DUPLICATION, DISCLOSURE OR USE FOR ANY PURPOSE OTHER THAN THE CUSTOMER'S DIRECT NEEDS FOR THE APPLICATION CONCERNED, ARE PROHIBITED. RAYCHEM RESERVES THE RIGHT TO AMEND THE DRAWING AT ANY TIME. RAYCHEM'S OBLIGATIONS SHALL ONLY BE AS SET FORTH IN RAYCHEM'S TERMS AND CONDITIONS OF SALE OF THIS PRODUCT. USERS SHOULD INDEPENDENTLY EVALUATE THE SUITABILITY OF THIS PRODUCT FOR THEIR APPLICATION.

UNLESS OTHERWISE SPECIFIED DIMENSIONS ARE IN INCHES. METRIC DIMENSIONS ARE IN BRACKETS.

DECIMALS  
.XXX ± .005 { 0.13mm }  
.XX ± .01 { 0.25mm }

ANGLES  
.X ±

WEIGHT

RE-DRAWN	J.VALENTA	04/20/99
CHECKED		
APPROVED	M.HIGGY	04/23/99
APPROVED		
CAD NAME	T-22750a.DWG	
THIRD ANGLE PROJECTION		

<b>Raychem</b> <small>RAYCHEM CORPORATION 300 CONSTITUTION DRIVE MENLO PARK, CALIFORNIA 94025</small>			
TITLE			
CONNECTOR, RECEPTACLE, BOX MOUNT, .025 SQ., TERMINATION POST, MTC100 SERIES			
SIZE	CODE IDENT. NO.	DWG. NO.	REV
C	06090	MTC100-BXX-PXX-XXX	H
DO NOT SCALE THIS DRAWING		SHEET 1 OF 3	

REVISIONS			
LTR	DESCRIPTION	DATE	APPROVED
G	REVISED PER ECN T-18624	10/12/93	R.LOVATO
H	REDRAWN ON CAD PER ECN T-22750	04/29/99	J.VALENTA

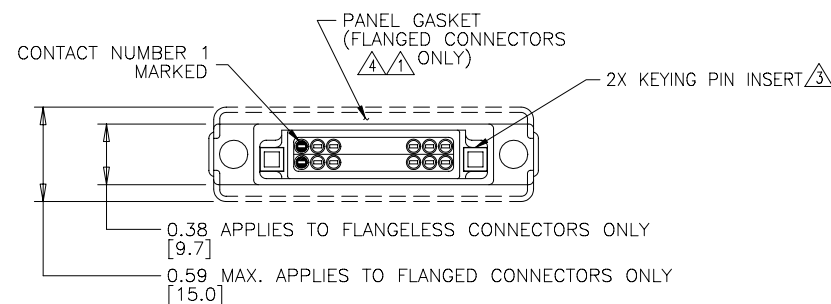
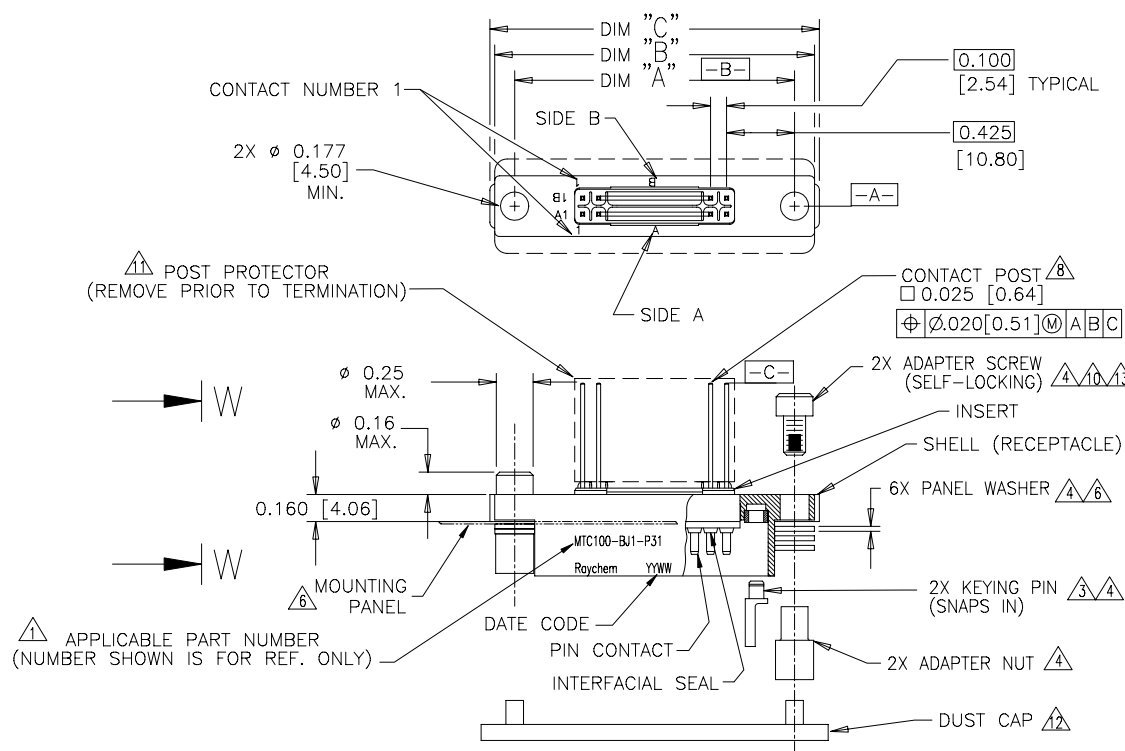

SHEET 1  
MTC100-BXX-PXX-XXX  
DWG. NO.

4

3

2

1

FIGURE 1

1  
BASIC DESIGN  
(AVAILABLE)

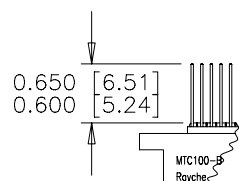

TERMINATION POSTS  
0.580 MINIMUM LENGTH  
FLANGELESS  
MTC100-BJX-PX1

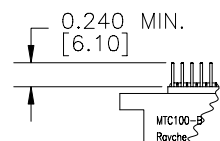

TERMINATION POSTS  
0.240 MINIMUM LENGTH  
FLANGELESS  
MTC100-BJX-PX2

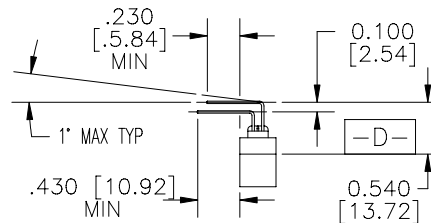

TERMINATION POSTS BENT  
90° IN "B" DIRECTION  
FLANGELESS  
MTC100-BJX-PX3

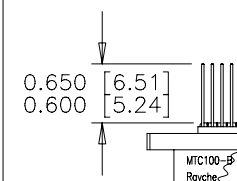

TERMINATION POSTS  
0.580 MINIMUM LENGTH  
FLANGED  
MTC100-BF/SX-PX1

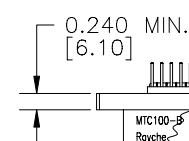

TERMINATION POSTS  
0.240 MINIMUM LENGTH  
FLANGED  
MTC100-BF/SX-PX2

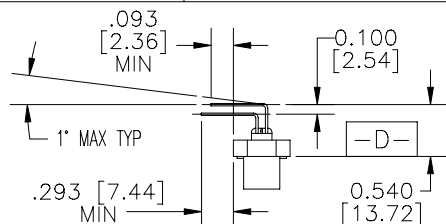

TERMINATION POSTS BENT  
90° IN "B" DIRECTION  
FLANGED  
MTC100-BF/SX-PX3

TABLE 1

CONNECTOR SIZE	"A"	"B"	"C"	"X"	"Y"	"Z" (MIN)
1 INCH						
FLANGELESS	1.750 [44.45]	2.00 [50.8]		1.750 [44.45]	1.520 [38.61]	0.400 [10.16]
FLANGED	1.750 [44.45]		2.06 [52.3]	1.750 [44.45]	1.520 [38.61]	0.600 [15.24]
2 INCH						
FLANGELESS	2.750 [69.85]	3.00 [76.2]		2.750 [69.85]	2.520 [64.00]	0.400 [10.16]
FLANGED	2.750 [69.85]		3.06 [77.7]	2.750 [69.85]	2.520 [64.00]	0.600 [15.24]

TABLE 2

PANEL THICKNESS	NUMBER OF PANEL WASHERS FOR EACH FASTENER
0.031/0.036 [0.8]/[0.9]	2
0.062/0.067 [1.5]/[1.7]	1
0.93/0.097 [2.3]/[2.4]	0

If this document is printed it becomes uncontrolled.  
Check with the web for latest revision.

SIZE	CODE IDENT. NO.	DWG. NO.	REV.
C	06090	MTC100-BXX-PXX-XXX	H
DO NOT SCALE THIS DRAWING	CAD NAME: T-22750b.DWG	SHEET 2 OF 3	

4

3

2

1

SHEET 2

DWG. NO. MTC100-BXX-PXX-XXX

A

# SPECIFICATIONS:

## MATERIALS:

A. SHELL	ALUMINUM ALLOY PER QQ-A-591
B. ADAPTER SCREW	STAINLESS STEEL PER QQ-S-763, 300 SERIES
C. ADAPTER NUT	STAINLESS STEEL PER QQ-S-763, 300 SERIES
D. STANDARD PANEL GASKET EME PANEL GASKET	SILICONE ELASTOMER PER MIL-R-25988 CONDUCTIVE FLOROSILICONE
E. INSERT	HIGH GRADE POLARYLENE THERMOPLASTIC
F. INTERFACIAL SEAL	SILICONE ELASTOMER PER MIL-R-25988
G. KEYING PIN	HIGH GRADE POLARYLENE THERMOPLASTIC
H. PIN CONTACT	COPPER ALLOY PER QQ-B-750
I. PANEL WASHER	STAINLESS STEEL PER QQ-S-763, 300 SERIES
J. KEYING PIN INSERT	HIGH GRADE POLARYLENE THERMOPLASTIC

## FINISH:

	APPLIES TO NICKEL PLATED CONNECTORS (STANDARD PLATING)	APPLIES TO CADMIUM PLATED CONNECTORS
A. SHELL	NICKEL PLATED PER MIL-C-26074 CLASS 3, GRADE B	CADMIUM PLATED PER QQ-P-416 OVER NICKEL UNDERPLATE
B. ADAPTER SCREW	PASSIVATED PER QQ-P-35	CADMIUM PLATED PER QQ-P-416
C. ADAPTER NUT	PASSIVATED PER QQ-P-35	CADMIUM PLATED PER QQ-P-416
D. PANEL WASHER	PASSIVATED PER QQ-P-35	CADMIUM PLATED PER QQ-P-416
E. PIN CONTACT	GOLD PLATED PER MIL-G-45204 TYPE 1, GRADE C, CLASS 1	

## DESIGN AND CONSTRUCTION:

THE CONNECTORS SPECIFIED HEREIN ARE PANEL MOUNTED RECEPTACLES WITH FIXED (NON-REMOVABLE) PIN INSERTS AND CONTACTS. THE CONNECTOR IS WITHOUT PROVISIONS FOR CABLE CLAMPS OR TERMINATION SEALS.

## PERFORMANCE:

THESE CONNECTORS MEET THE APPLICABLE REQUIREMENTS OF RAYCHEM SPECIFICATION C-6111.

PERFORMANCE; SHELL BE IN ACCORDANCE WITH C-6111, EXCEPT AS FOLLOWS

HUMIDITY  
ALTITUDE IMMERSION  
ALTITUDE - LOW TEMPERATURE  
FLUID IMMERSION

THE CONNECTOR TERMINATION END  
MUST BE SUITABLY PROTECTED  
FOR TESTING OR APPLICATION IN  
ANY OF THESE ENVIRONMENTS.

TABLE 3

PART NUMBER	WEIGHT MAXIMUM GRAMS
MTC100-BF1-P32	23.0
MTC100-BF2-P32	33.2

THE FOLLOWING TABLE CONSISTS OF WEIGHTS  
FOR THESE SPECIFIC PART NUMBERS

11

If this document is printed it becomes uncontrolled.  
Check with the web for latest revision.

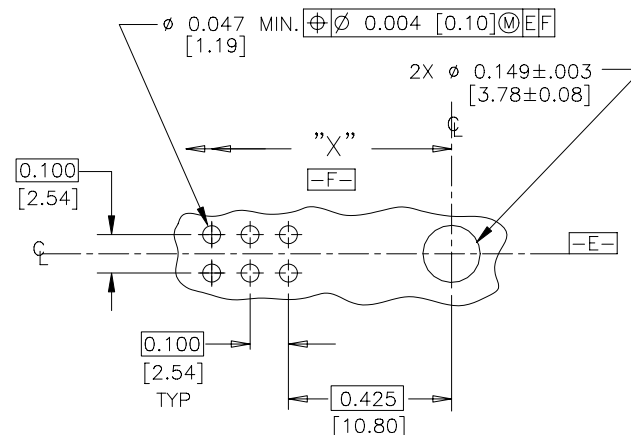

RECOMMENDED HOLE PATTERN AND SIZE  
FOR PRINTED CIRCUIT BOARDS

FIGURE 3

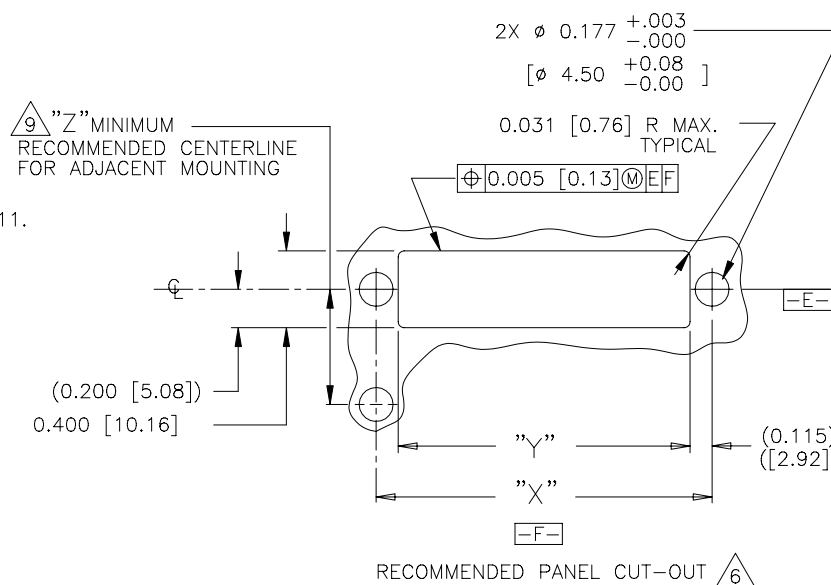

RECOMMENDED PANEL CUT-OUT

FIGURE 2

SIZE C	CODE IDENT. NO. 06090	DWG. NO. MTC100-BXX-PXX-XXX	REV H
DO NOT SCALE THIS DRAWING	DATE T22750c.DWG	SHEET 3 OF 3	