

DO NOT  
SCALE FROM  
THIS PRINT

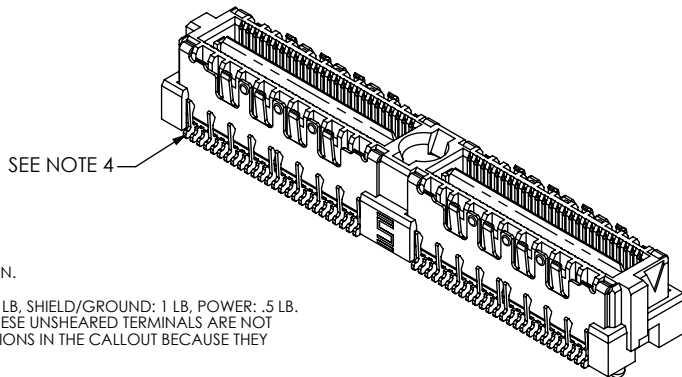
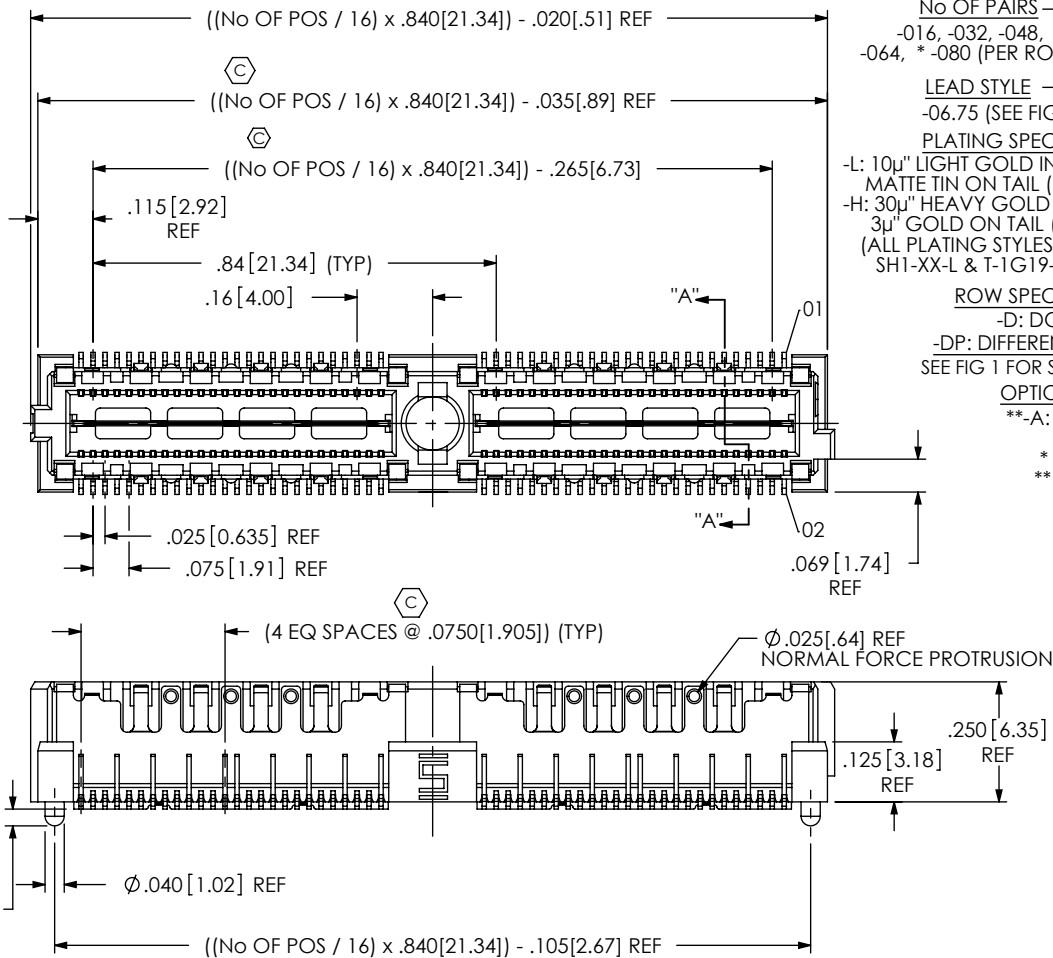

NOTES:

1.  $\odot$  REPRESENTS A CRITICAL DIMENSION.
2. BURR ALLOWANCE: .0015 MAX.
3. MINIMUM PUSHOUT FORCE: SIGNAL: .5 LB. SHIELD/GROUND: 1 LB. POWER: .5 LB.
4. DO NOT SHEAR TERMINALS SHOWN; THESE UNSHEARED TERMINALS ARE NOT CONSIDERED IN THE NUMBER OF POSITIONS IN THE CALLOUT BECAUSE THEY ARE GROUNDED TO THE SHIELDS.
5. MAX VARIANCE OF .002.
6. DIMENSION APPLIES TO CONTACTS & GROUND PLANE.
7. GROUND PLANE PRESS HEIGHT MUST BE .003[.08] LESS THAN THE MAX HEIGHT OR .001[.03] GREATER THAN THE MINIMUM HEIGHT OF THE TERMINALS.
8. PARTS TO BE PACKAGED IN TRAYS AS STANDARD.
9. LEADSTYLE -11 MAY BE SUBSTITUTED IN PART CALLOUT FOR -06.75 FOR EXISTING CUSTOMERS ONLY

PATENT NUMBERS  
6739884/ 7165994  
7121849

QMSS-XXX-XX.XX-X-D-DP-X-XXX-XX

No OF PAIRS  
-016, -032, -048,  
-064, \* -080 (PER ROW)

LEAD STYLE  
-06.75 (SEE FIG 1, SEE NOTE 9)

PLATING SPECIFICATION  
-L: 10 $\mu$ " LIGHT GOLD IN CONTACT AREA  
MATTE TIN ON TAIL (USE T-1M19-06.75-L)  
-H: 30 $\mu$ " HEAVY GOLD IN CONTACT AREA  
3 $\mu$ " GOLD ON TAIL (USE T-1M19-06.75-H)  
(ALL PLATING STYLES USE  
SH1-XX-L & T-1G19-06.75-L)

ROW SPECIFICATION  
-D: DOUBLE  
-DP: DIFFERENTIAL PAIRS  
SEE FIG 1 FOR SHIELD BEAM CONFIGURATION

OPTION  
\*\*-A: ALIGNMENT PIN

\* = NOT TOOLED  
\*\* = NOT AVAILABLE WITH PXX OPTION

PACKAGING OPTION

-TR: TAPE & REEL  
(-016 THRU -048 WITHOUT OPTIONS  
-GP OR -PXX, -016 THRU -032 WITH  
OPTIONS -GP OR -PXX)

OPTION

\*\* -GP: GUIDE POSTS  
(SEE FIG 3, SHEET 2)  
\*\* -K: KAPTON PAD  
(SEE FIG 2, SHEET 2)  
-PC4: POWER COMBO 4 (.062" THICK BOARD)  
(SEE FIG 5, SHEET 3)  
-PC8: POWER COMBO 8 (.062" THICK BOARD)  
(SEE FIG 5, SHEET 3)  
-PT4: POWER COMBO 4 (.093" THICK BOARD)  
(SEE FIG 5, SHEET 3)  
-PT8: POWER COMBO 8 (.093" THICK BOARD)  
(SEE FIG 5, SHEET 3)

-PXX NOT AVAILABLE WITH -GP, -A, -K  
-PXX AVAILABLE ON POSITIONS  
-016, -032 & -048 ONLY AND ON  
LEAD STYLE -06.75 ONLY

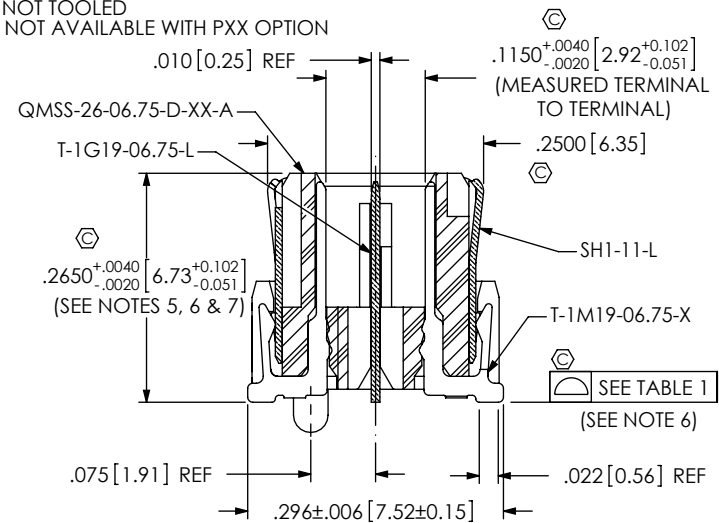

SECTION "A"-"A"  
SCALE 4.5 : 1

TABLE 1

No OF PAIRS	No OF BANKS	COPLANARITY
-016 THRU -048	1 THRU 3	.004[.10]
-064 AND -080	4 AND 5	.006[.15]

UNLESS OTHERWISE SPECIFIED,  
DIMENSIONS ARE IN INCHES.

TOLERANCES ARE:

DECIMALS ANGLES  
.XX:  $\pm .01$  [.3] 2°  
.XXX:  $\pm .005$  [.13]  
.XXXX:  $\pm .0020$  [.051]

PROPRIETARY NOTE

THIS DOCUMENT CONTAINS INFORMATION  
CONFIDENTIAL AND PROPRIETARY TO  
SAMTEC, INC. AND SHALL NOT BE REPRODUCED  
OR TRANSFERRED TO OTHER DOCUMENTS OR  
DISCLOSED TO OTHERS OR USED FOR ANY  
PURPOSE OTHER THAN THAT WHICH IT WAS  
OBTAINED WITHOUT THE EXPRESSED WRITTEN  
CONSENT OF SAMTEC, INC.

MATERIAL: DO NOT SCALE DRAWING

INSULATOR: LCP, COLOR: BLACK  
TERMINAL, GROUND PLANE,  
& SHIELD: PHOS BRONZE

SHEET SCALE: 2.5:1

DESCRIPTION:  
.635mm DIFFERENTIAL PAIRS SHIELDED TERMINAL STRIP

DWG. NO.  
QMSS-XXX-XX.XX-X-D-DP-X-XXX-XX

BY: BRATCHER 08/12/03 SHEET 1 OF 3

**samtec**

520 PARK EAST BLVD, NEW ALBANY, IN 47150  
PHONE: 812-944-6733 FAX: 812-948-5047  
e-Mail: info@SAMTEC.com code: 55322

IN-PROCESS 1

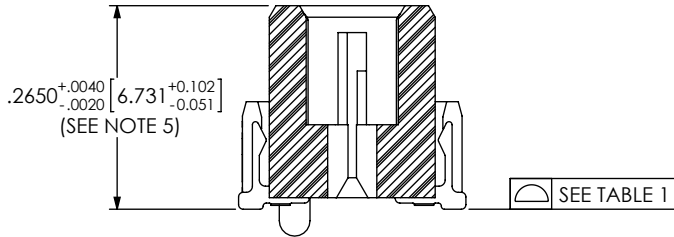

IN-PROCESS 2

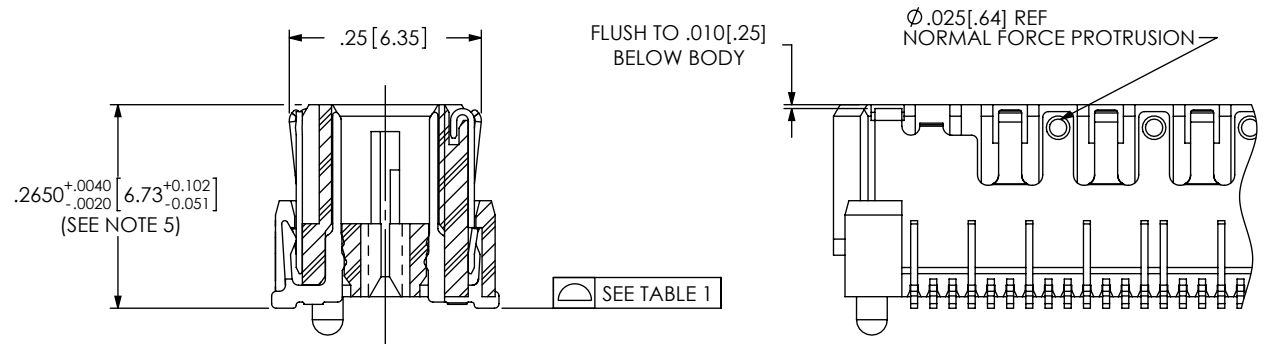

TERMINAL DETAILS

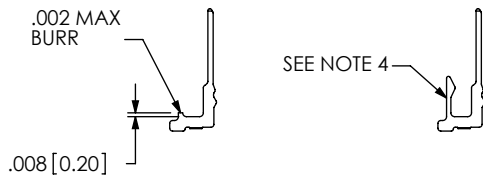

FIG 3

-GP: GUIDE POST OPTION  
(QMSS-032-06.75-X-D-DP-A-GP SHOWN)

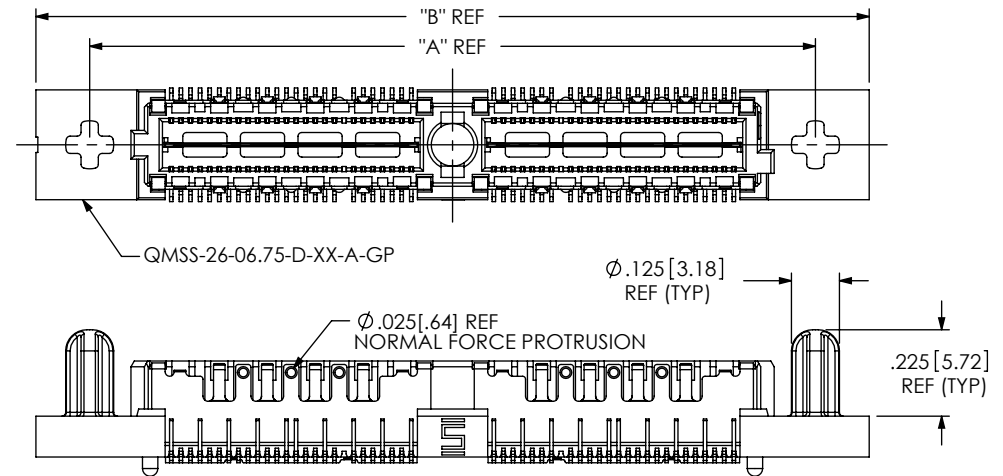

FIG 2

-K: KAPTON PAD OPTION  
(USE K-500-300)

(USE K-DOT .217-.313-.005 FOR -GP OPTION, NOT APPROVED FOR VISION INTEGRATED KAPTON APPLICATION)  
(QMSS-032-06.75-X-D-DP-A-K SHOWN)

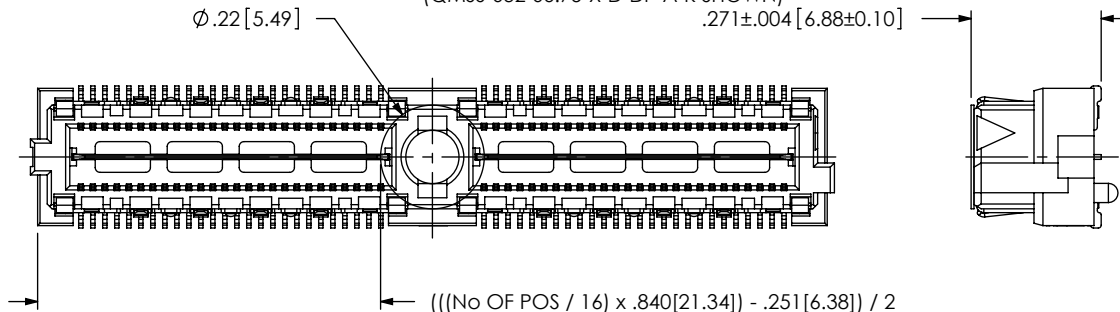

TABLE 2

ASSEMBLY	"A"	"B"
QMSS-016-06.75-X-D-GP	1.050[26.67]	1.330[33.78]
QMSS-032-06.75-X-D-GP	1.890[48.00]	2.170[55.12]
QMSS-048-06.75-X-D-GP	2.730[69.34]	3.010[76.45]
QMSS-064-06.75-X-D-GP	3.570[90.68]	3.850[97.79]
QMSS-080-06.75-X-D-GP	4.410[112.01]	4.690[119.13]

PROPRIETARY NOTE

THIS DOCUMENT CONTAINS INFORMATION  
CONFIDENTIAL AND PROPRIETARY TO  
SAMTEC, INC. AND SHALL NOT BE REPRODUCED  
OR TRANSFERRED TO OTHER DOCUMENTS OR  
DISCLOSED TO OTHERS OR USED FOR ANY  
PURPOSE OTHER THAN THAT WHICH IT WAS  
OBTAINED WITHOUT THE EXPRESSED WRITTEN  
CONSENT OF SAMTEC, INC.

DO NOT SCALE DRAWING

SHEET SCALE: 2.5:1

**samtec**

520 PARK EAST BLVD, NEW ALBANY, IN 47150  
PHONE: 812-944-6733 FAX: 812-948-5047  
e-Mail: info@SAMTEC.com code: 55322

DESCRIPTION:

.635mm DIFFERENTIAL PAIRS SHIELDED TERMINAL STRIP

DWG. NO.

QMSS-XXX-XX.XX-X-D-DP-X-XXX-XX

BY: BRATCHER 08/12/03

SHEET 2 OF 3

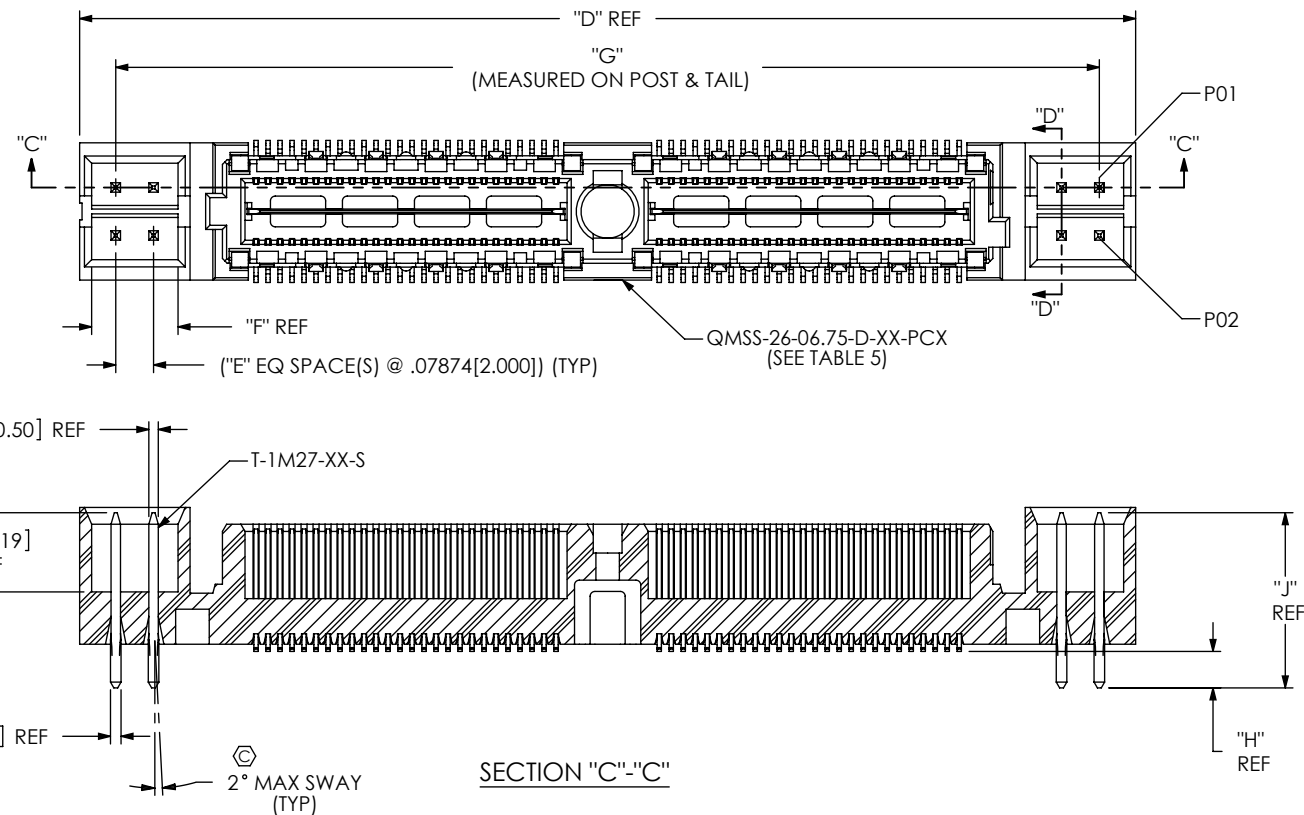

FIG. 5 -PXX OPTION  
POWER COMBO OPTIONS  
QMSS-032-06.75-X-D-DP-PC4 SHOWN  
(SAME AS FIG 1, UNLESS OTHERWISE STATED)  
[NOT AVAILABLE WITH -GP, -A, OR -K OPTION]  
[AVAILABLE ON -016, -032 & -048 POSITIONS ONLY]

TABLE 5

ASSEMBLY	BODY	"D"	"E"	"F"	"G"
QMSS-016-06.75-X-DP-X-PX4	QMSS-26-06.75-D-01-PC4	1.360[34.54]	1	.180[4.57]	1.209[30.71]
QMSS-016-06.75-X-DP-X-PX8	QMSS-26-06.75-D-01-PC8	1.675[42.55]	3	.337[8.56]	1.524[38.71]
QMSS-032-06.75-X-DP-X-PX4	QMSS-26-06.75-D-02-PC4	2.200[55.88]	1	.180[4.57]	2.049[52.04]
QMSS-032-06.75-X-DP-X-PX8	QMSS-26-06.75-D-02-PC8	2.515[63.88]	3	.337[8.56]	2.364[60.05]
QMSS-048-06.75-X-DP-X-PX4	QMSS-26-06.75-D-03-PC4	3.040[77.22]	1	.180[4.57]	2.889[73.38]
QMSS-048-06.75-X-DP-X-PX8	QMSS-26-06.75-D-03-PC8	3.355[85.22]	3	.337[8.56]	3.204[81.38]

TABLE 6

POWER OPTION	TERMINAL	"H"	"J"	"K"	"L"
PC4 / PC8	T-1M27-01-S	.071[1.80]	.365[9.27]	.086[2.18]	.124[3.15]
PT4 / PT8	T-1M27-03-S	.110[2.79]	.400[10.16]	.125[3.18]	.159[4.04]

F:\DWG\MISC\MKTG\QMSS-XXX-XX-XX-X-D-DP-X-XXX-XX-MKT.SLDDRW

IN-PROCESS

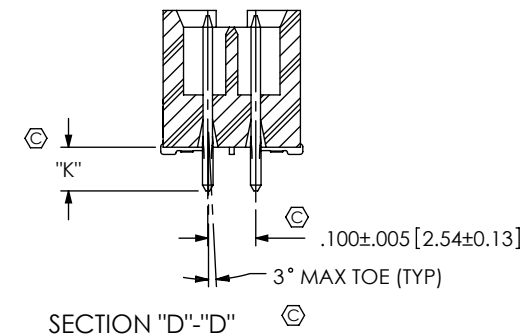
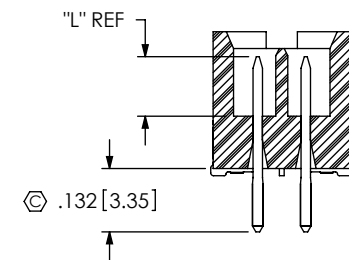

## PROPRIETARY NOTE

THIS DOCUMENT CONTAINS INFORMATION  
CONFIDENTIAL AND PROPRIETARY TO  
SAMTEC, INC. AND SHALL NOT BE REPRODUCED  
OR TRANSFERRED TO OTHER DOCUMENTS OR  
DISCLOSED TO OTHERS OR USED FOR ANY  
PURPOSE OTHER THAN THAT WHICH IT WAS  
OBTAINED WITHOUT THE EXPRESSED WRITTEN  
CONSENT OF SAMTEC, INC.

DO NOT SCALE DRAWING

SHEET SCALE: 2.5:1

**samtec**

520 PARK EAST BLVD, NEW ALBANY, IN 47150  
PHONE: 812-944-6733 FAX: 812-948-5047  
e-Mail: info@SAMTEC.com code: 55322

## DESCRIPTION:

.635mm DIFFERENTIAL PAIRS SHIELDED TERMINAL STRIP

## DWG. NO.

QMSS-XXX-XX.XX-X-D-DP-X-XXX-XX

BY: BRATCHER 08/12/03

SHEET 3 OF 3