

Illuminated pushbutton Ø 22 mm stainless steel 304, with
symbol

82-6151.1A14.B001



<https://eao.com/p/82-6151.1A14.B001>

Your product:



82-6151.1A14.B001

Illuminated pushbutton Ø 22 mm
stainless steel 304, with symbol

FRONT

Front bezel material: Stainless steel

Front bezel shape: flush

MOUNTING

Mounting cut-out: Ø 22 mm

OPERATING-/INDICATION PART

Illumination colour: Red

Symbol: ON/OFF

Lens material: Plastic metalised

Lens optics: opaque

Lens shape: flush

Lens colour: Silver

Shape of illumination: Symbol

Lens illumination: illuminative

ELECTRICAL CHARACTERISTICS

Operating voltage: 24 V DC

Pollution degree: 2, according to EN IEC 60947-1

Rated insulation voltage U_i : 250 V

Rated Operational Voltage U_e : 250 VAC

Contacts: 1 C

Thermal current I_{th}:	5 A		
Electric strength:	1500 VAC, 50 Hz 1 minute between life terminals and ground		
Electrical lifetime:	50 000 cycles of operation		
Switching voltage and switching current:	according to IEC 60947-5-1 (Silver contacts) Service categorie AC-15		
	Voltage		Current
	24 VAC		1 A
	35 VAC		1 A (M12 versio
	110 VAC		1 A
	220 VAC		0.5 A
	Switch rating DC service categorie DC-13 (Silver contacts)		
	Voltage		Current
	24 VDC		0.7 A
	35 VDC		0.5 A (M12 vers
	110 VDC		0.2 A
	220 VDC		0.1 A
	according to UL 508 (Silver contacts) cosφ 0,75 ... 0,8		
	Voltage		Current
	120 VAC		5 A
	240 VAC		3 A
	24 VAC		1 A

MECHANICAL CHARACTERISTIC

Tightening torque:	0.5 ... 0.6 Nm
Switching system:	Snap-action switching element
Terminal:	Soldering terminal, 2.8 x 0.5 mm
Switching action:	Momentary
Operating force:	4 N ... 7 N
Contact material:	Silver
Mechanical lifetime:	1 Mio. cycles of operation
Operating Travel:	ca. 3 mm
Weight:	0.025 kg

AMBIENT CONDITION

Climate resistance:	Damp heat, 21 days according to IEC 60512-11
Storage temperature:	– 40 °C ... + 80 °C
IP front protection:	IP65, IP67
Operating temperature:	– 30 °C ... + 70 °C
Shock resistance:	Max. 500 m / s ² as per IEC 60068-2-27
Vibration resistance:	

10 ... 500 Hz, amplitude 1.5 mm p-p according to IEC 60068-2-6

CERTIFICATE

Approbations:

CB, CCC, C UL, UL

Conformities:

CE, 2011 / 65 / EC (RoHS), 2014 / 35 / EU (LVD)

OTHER

Kind of illumination:

Single-LED

Short Description:

Illuminated pushbutton Ø 22 mm stainless steel 304, with symbol, Momentary, 24 V DC, 1 C, Soldering terminal, 2.8 x 0.5 mm, Stainless steel, Red, ON/OFF, Silver

Wiring diagrams:

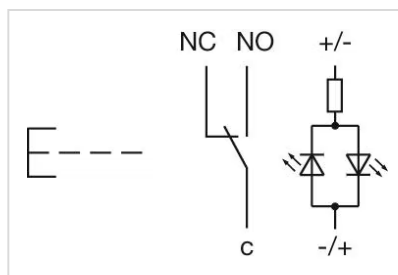

Component layouts:

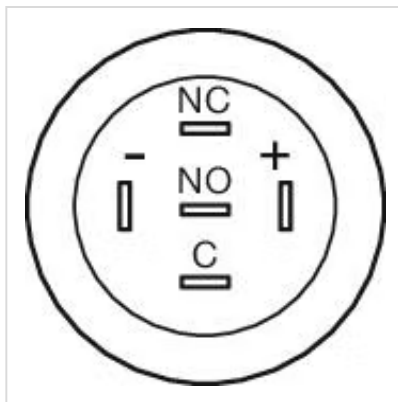

Mounting cut-outs:

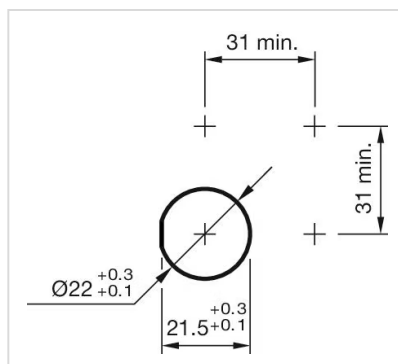

Dimension drawings:

