

LOC		DIST		REVISIONS			
HV	00	P	LTR	DESCRIPTION	DATE	DWN	APVD
		A		ECO-14-001314	27JAN2014	DR	DR

(7.20) (7.20)

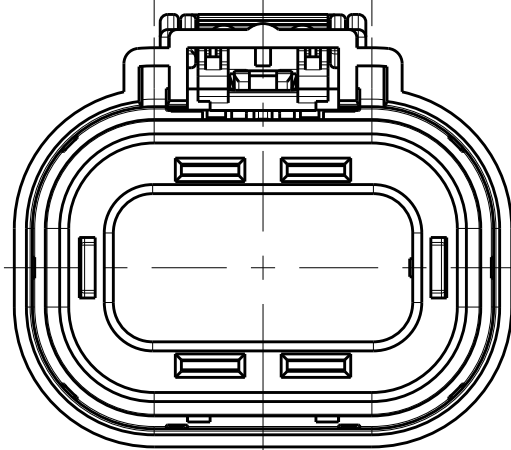

2103534-1
KEY A

(9.20) (7.20)

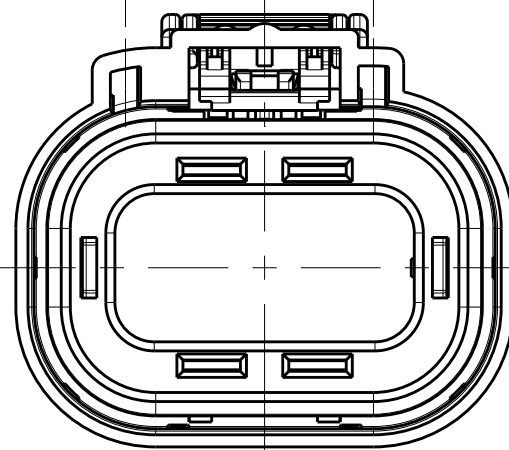

2103534-2
KEY B

(9.20) (9.20)

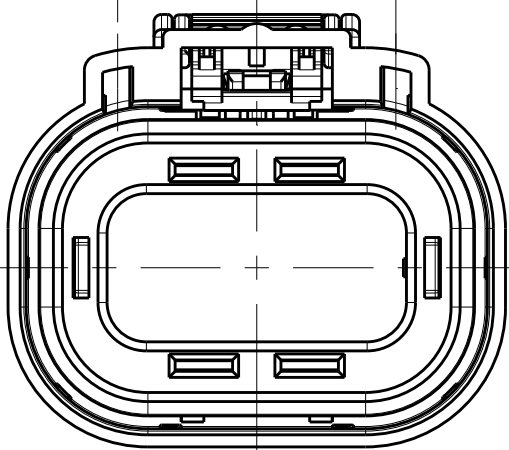

2103534-4
KEY D

(8.20)

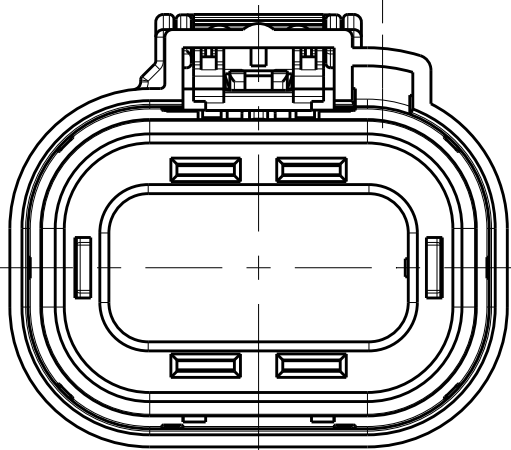

2103534-5
KEY E

(8.20)

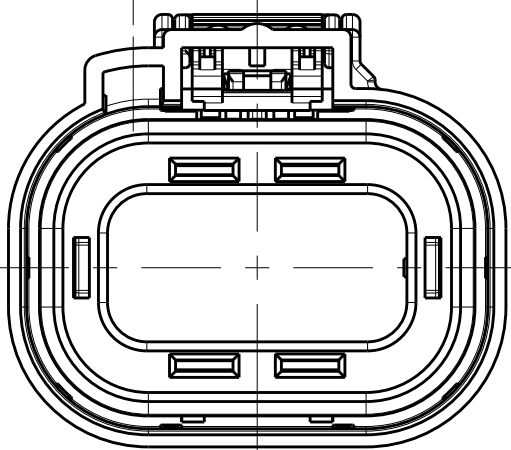

2103534-6
KEY F

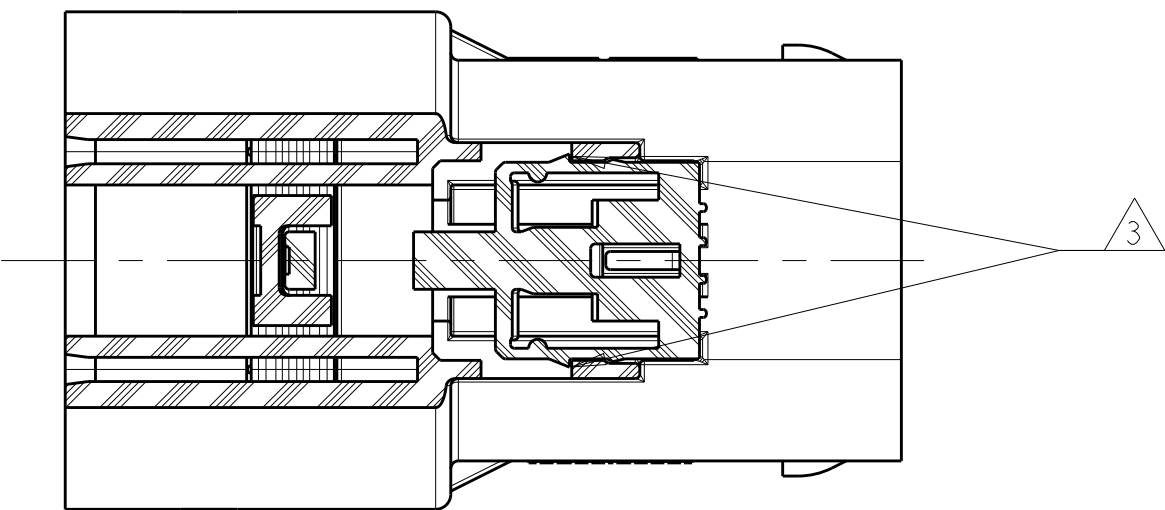

SECTION C-C

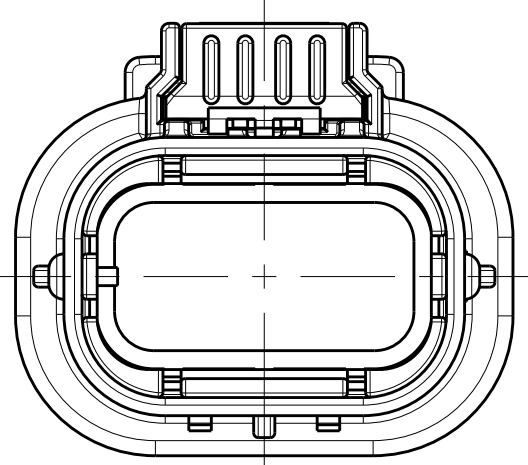
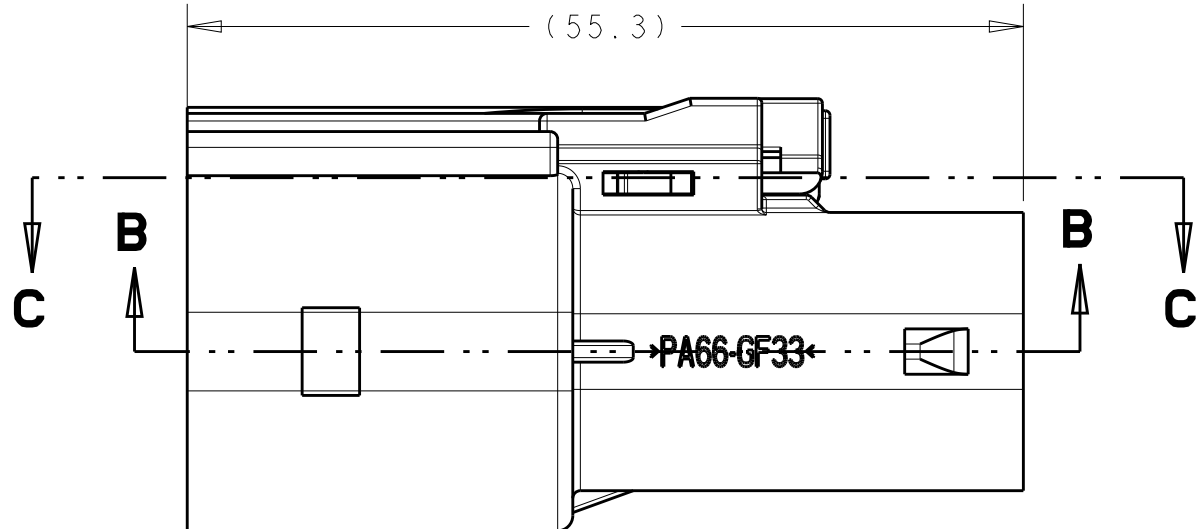
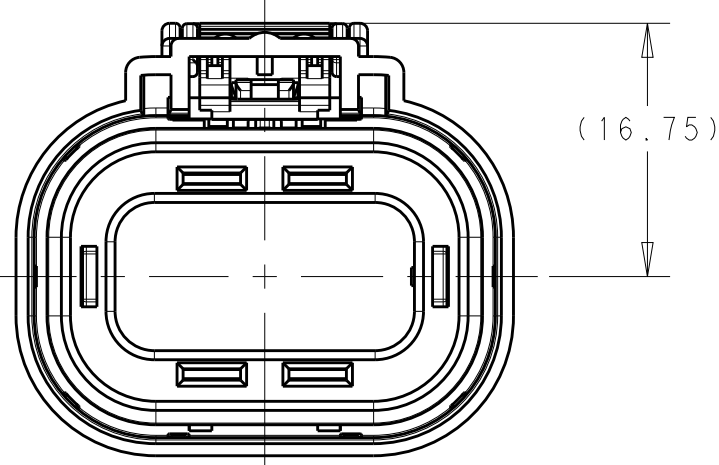
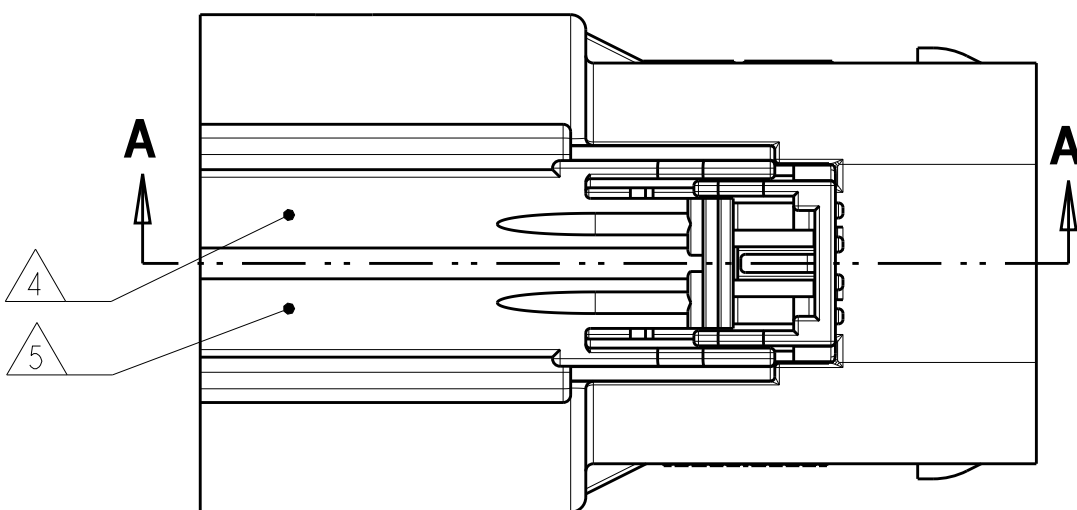

2103534-1 SHOWN

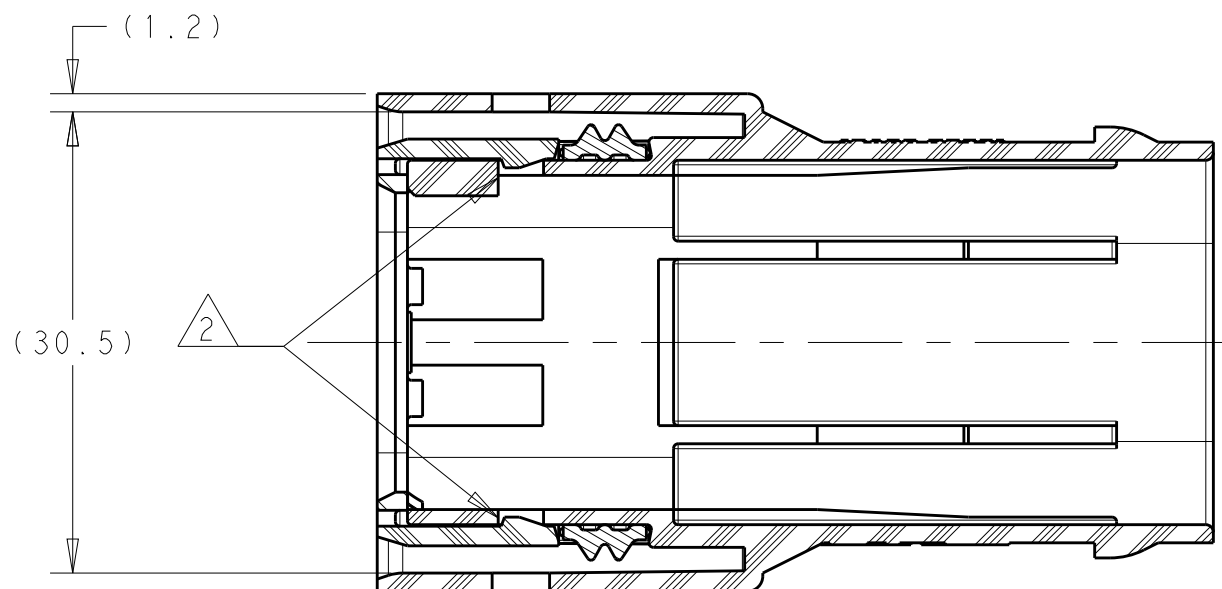

SECTION B-B

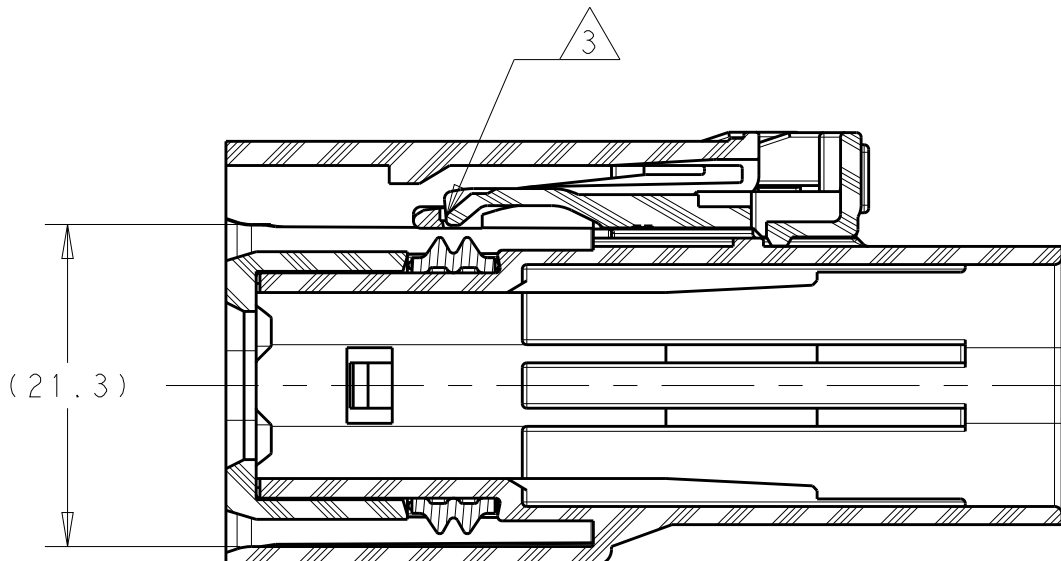

SECTION A-A

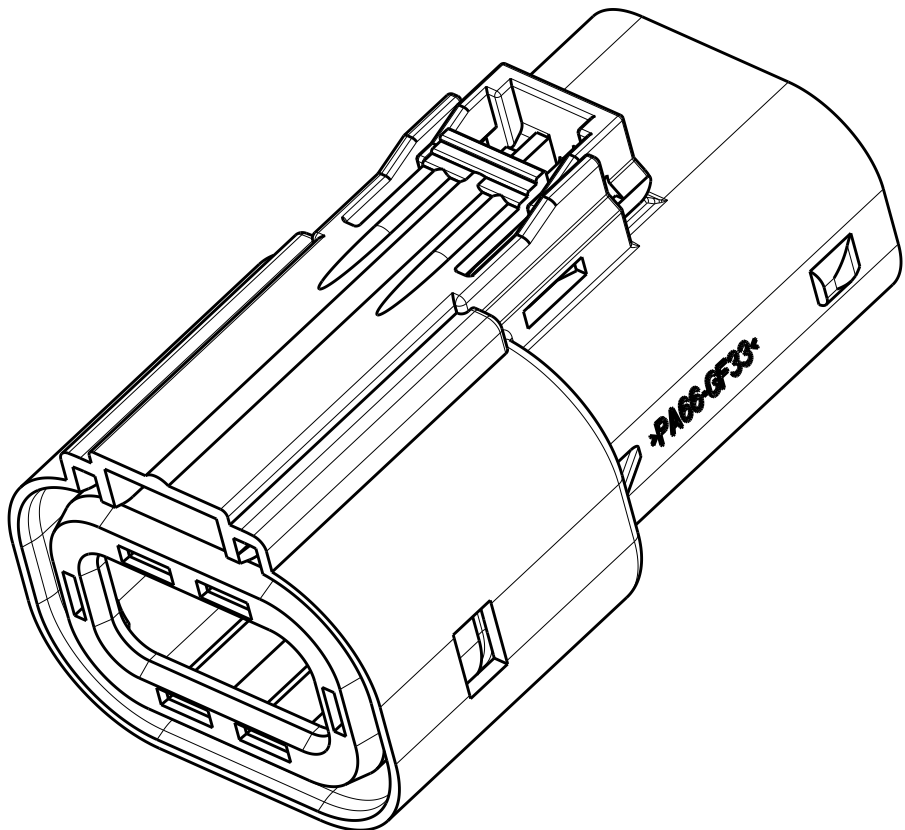

1. CONNECTOR MUST BE FREE OF ANY MECHANICAL DEFECTS WHICH COULD NEGATIVELY AFFECT FIT, FUNCTION, OR PERFORMANCE
- 2 PERIPHERAL SEAL RETAINER MUST BE FULLY LOCKED IN TWO LOCATIONS INTO OUTER HOUSING
- 3 CPA MUST BE INSTALLED IN PRE-STAGE POSITION AS SHOWN
- 4 JULIAN DATE CODE IN THIS LOCATION AT ASSEMBLY
- 5 TE PART NUMBER IN THIS LOCATION AT ASSEMBLY (VARIABLE)

F	14.39 g	2103534-6
E	14.30 g	2103534-5
D	14.64 g	2103534-4
B	14.62 g	2103534-2
A	14.48 g	2103534-1
INDEX CODE	WEIGHT	PART NO

THIS DRAWING IS A CONTROLLED DOCUMENT.		DWN D. RHEIN 04SEP2013	TE Connectivity	
DIMENSIONS:		CHK D. RHEIN 04SEP2013		
mm	TOLERANCES UNLESS OTHERWISE SPECIFIED:	APVD A. GUANCO 04SEP2013	NAME PLUG SUB-ASSEMBLY HVA280	
	0 PLC ±	PRODUCT SPEC	SIZE A100779C=2103534	
	1 PLC ±0.5	APPLICATION SPEC		
MATERIAL	2 PLC ±0.30	WEIGHT SEE TABLE	RESTRICTED TO -	
	3 PLC ±	Customer Drawing	SCALE 2:1	
	4 PLC ±		SHEET 1 OF 1	
	ANGLES ±1°		REV A	
	FINISH			