

Pushbutton Ø 22 mm silver contact

82-6162.2000



<https://eao.com/p/82-6162.2000>

Your product:



82-6162.2000

Pushbutton Ø 22 mm silver contact

FRONT

Front bezel shape:	flush
Front bezel material:	Stainless steel

MOUNTING

Mounting cut-out:	Ø 22 mm
-------------------	---------

OPERATING-/INDICATION PART

Lens colour:	Silver
Lens shape:	raised
Lens illumination:	non illuminative
Lens material:	Stainless steel
Lens optics:	opaque

ELECTRICAL CHARACTERISTICS

Thermal current I _{th} :	5 A
Electrical lifetime:	50 000 cycles of operation
Rated insulation voltage U _i :	250 V
Switching voltage and switching current:	

according to IEC 60947-5-1 (Silver contacts)

Service categorie AC-15

Voltage

24 VAC

35 VAC

110 VAC

220 VAC

Current

1 A

1 A (M12 version)

1 A

0.5 A

Switch rating DC service categorie DC-13 (Silver contacts)

Voltage

24 VDC

35 VDC

110 VDC

220 VDC

Current

0.7 A

0.5 A (M12 version)

0.2 A

0.1 A

according to UL 508 (Silver contacts)

$\cos\phi$ 0,75 ... 0,8

Voltage

120 VAC

240 VAC

24 VAC

Current

5 A

3 A

1 A

Contacts:

1 C

Rated Operational Voltage U_e :

250 VAC

Pollution degree:

2, according to EN IEC 60947-1

Electric strength:

1500 VAC, 50 Hz 1 minute between life terminals and ground

MECHANICAL CHARACTERISTIC

Tightening torque:

0.5 ... 0.6 Nm, Screw terminal 0.1 Nm

Mechanical lifetime:

500 000 cycles of operation

Weight:

0.02 kg

Contact material:

Silver

Switching system:

Snap-action switching element

Terminal:

Screw terminal

Switching action:

Maintained

Operating Travel:

ca. 3 mm

Operating force:

4 N ... 7 N

AMBIENT CONDITION

Vibration resistance:

10 ... 500 Hz, amplitude 1.5 mm p-p according to IEC 60068-2-6

Operating temperature:

- 30 °C ... + 70 °C

Climate resistance:

Damp heat, 21 days according to IEC 60512-11

Shock resistance:

Max. 500 m / s² as per IEC 60068-2-27

Storage temperature:

– 40 °C ... + 80 °C

IP front protection:

IP65, IP67

CERTIFICATE

Conformities:

CE, 2011 / 65 / EC (RoHS), 2014 / 35 / EU (LVD)

Approbations:

CB, CCC, C UL, UL

OTHER

Short Description:

Pushbutton Ø 22 mm silver contact, Maintained, 1 C, Screw terminal, Stainless steel, Silver

Mounting cut-outs:

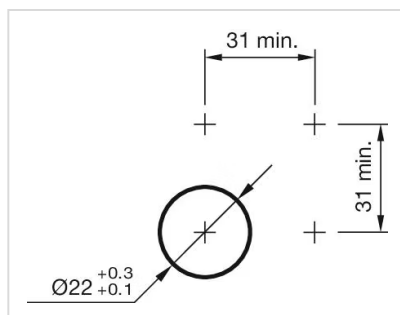

Wiring diagrams:

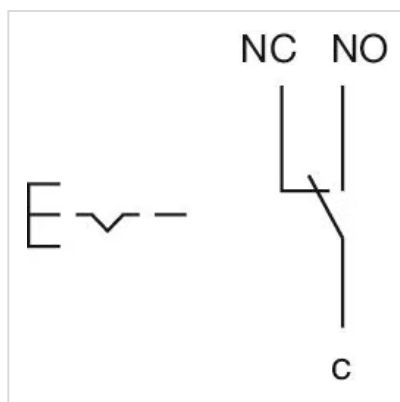

Component layouts:

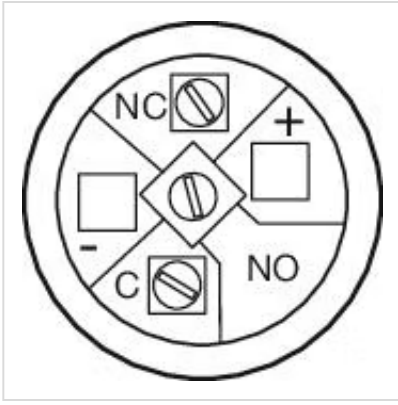

Dimension drawings:

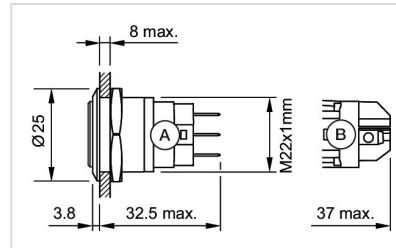

A = Solder terminal
B = Screw terminal