

Illuminated pushbutton Ø 22 mm silver contact

82-6151.2114.B002



<https://eao.com/p/82-6151.2114.B002>

Your product:



82-6151.2114.B002
Illuminated pushbutton Ø
22 mm silver contact

FRONT

Front bezel shape:	flush
Front bezel material:	Stainless steel

MOUNTING

Mounting cut-out:	Ø 22 mm
-------------------	---------

OPERATING-/INDICATION PART

Lens colour:	Silver
Lens optics:	opaque
Lens illumination:	illuminative
Symbol:	Standby
Lens material:	Stainless steel
Shape of illumination:	Ring
Lens shape:	flush
Illumination colour:	Red

ELECTRICAL CHARACTERISTICS

Thermal current I _{th} :	5 A
Contacts:	1 C
Rated Operational Voltage U _e :	250 VAC
Electrical lifetime:	50 000 cycles of operation
Operating voltage:	24 V AC/DC

Pollution degree:	2, according to EN IEC 60947-1		
Rated insulation voltage Ui:	250 V		
Electric strength:	1500 VAC, 50 Hz 1 minute between live terminals and ground		
Switching voltage and switching current:	according to IEC 60947-5-1 (Silver contacts)		
	Service categorie AC-15		
	Voltage		Current
	24 VAC		1 A
	35 VAC		1 A (M12 versio
	110 VAC		1 A
	220 VAC		0.5 A
	Switch rating DC service categorie DC-13 (Silver contacts)		
	Voltage		Current
	24 VDC		0.7 A
	35 VDC		0.5 A (M12 vers
	110 VDC		0.2 A
	220 VDC		0.1 A
	according to UL 508 (Silver contacts)		
	cosφ 0,75 ... 0,8		
	Voltage		Current
	120 VAC		5 A
	240 VAC		3 A
	24 VAC		1 A

MECHANICAL CHARACTERISTIC

Switching system:	Snap-action switching element
Contact material:	Silver
Weight:	0.018 kg
Tightening torque:	0.5 ... 0.6 Nm
Operating Travel:	ca. 3 mm
Switching action:	Maintained
Mechanical lifetime:	500 000 cycles of operation
Operating force:	4 N ... 7 N
Terminal:	Soldering terminal, 2.8 x 0.5 mm

AMBIENT CONDITION

Shock resistance:	Max. 500 m / s ² as per IEC 60068-2-27
IP front protection:	IP65, IP67
Climate resistance:	Damp heat, 21 days according to IEC 60512-11
Operating temperature:	– 30 °C ... + 70 °C
Vibration resistance:	10 ... 500 Hz, amplitude 1.5 mm p-p according to IEC 60068-2-6
Storage temperature:	

– 40 °C ... + 80 °C

CERTIFICATE

Approbations: CB, CCC, C UL, UL

Conformities: CE, 2011 / 65 / EC (RoHS), 2014 / 35 / EU (LVD)

OTHER

Kind of illumination: Single-LED

Short Description: Illuminated pushbutton Ø 22 mm silver contact, Maintained, 24 V AC/DC, 1 C, Soldering terminal, 2.8 x 0.5 mm, Stainless steel, Red, Standby, Silver

Dimension drawings:

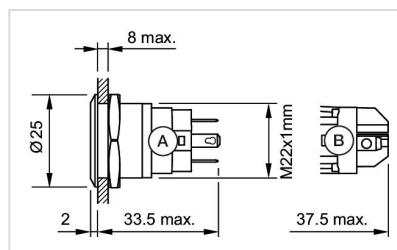

A = Solder terminal
B = Screw terminal

Component layouts:

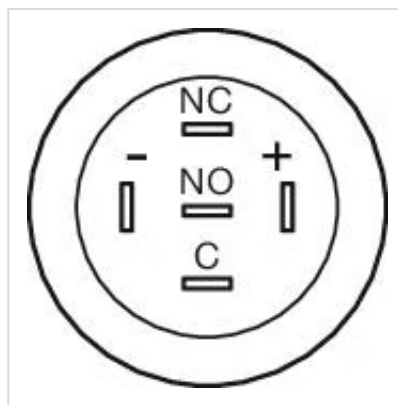

Wiring diagrams:

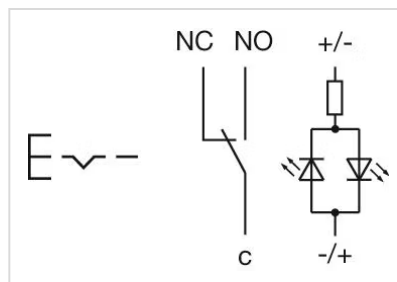

Mounting cut-outs:

