

Illuminated pushbutton Ø 19 mm silver contact

82-5152.1114



<https://eao.com/p/82-5152.1114>

Your product:



82-5152.1114

Illuminated pushbutton Ø
19 mm silver contact

FRONT

Front bezel material: Stainless steel

Front bezel shape: flush

MOUNTING

Mounting cut-out: Ø 19 mm

OPERATING-/INDICATION PART

Lens colour: Silver

Lens optics: opaque

Lens material: Stainless steel

Lens shape: flush

Shape of illumination: Ring

Lens illumination: illuminative

Illumination colour: Red

ELECTRICAL CHARACTERISTICS

Electrical lifetime: 50 000 cycles of operation

Rated Operational Voltage U_e: 250 VAC

Contacts: 1 C

Electric strength: 1500 VAC, 50 Hz 1 minute between life terminals and ground

Pollution degree: 2, according to EN IEC 60947-1

Thermal current I_{th}: 5 A

Operating voltage:	24 V DC		
Rated insulation voltage Ui:	250 V		
Switching voltage and switching current:	according to IEC 60947-5-1 (Silver contacts) Service categorie AC-15 Voltage 24 VAC 35 VAC 110 VAC 220 VAC Switch rating DC service categorie DC-13 (Silver contacts) Voltage 24 VDC 35 VDC 110 VDC 220 VDC		Current 1 A 1 A (M12 versio 1 A 0.5 A Current 0.7 A 0.5 A (M12 vers 0.2 A 0.1 A
	according to UL 508 (Silver contacts) cosφ 0,75 ... 0,8 Voltage 120 VAC 240 VAC 24 VAC		Current 5 A 3 A 1 A

MECHANICAL CHARACTERISTIC

Operating force:	4 N ... 7 N
Operating Travel:	ca. 3 mm
Terminal:	Screw terminal
Tightening torque:	0.5 ... 0.6 Nm
Weight:	0.018 kg
Mechanical lifetime:	1 Mio. cycles of operation
Switching action:	Momentary
Switching system:	Snap-action switching element
Contact material:	Silver

AMBIENT CONDITION

IP front protection:	IP65, IP67
Vibration resistance:	10 ... 500 Hz, amplitude 1.5 mm p-p according to IEC 60068-2-6
Storage temperature:	– 40 °C ... + 80 °C
Shock resistance:	Max. 500 m / s ² as per IEC 60068-2-27
Operating temperature:	– 30 °C ... + 70 °C
Climate resistance:	Damp heat, 21 days according to IEC 60512-11

CERTIFICATE

Approbations: CB, CCC, C UL, UL

Conformities: CE, 2011 / 65 / EC (RoHS), 2014 / 35 / EU (LVD)

OTHER

Kind of illumination: Single-LED

Short Description: Illuminated pushbutton Ø 19 mm silver contact, Momentary, 24 V DC, 1 C, Screw terminal, Stainless steel, Red, Silver

Component layouts:

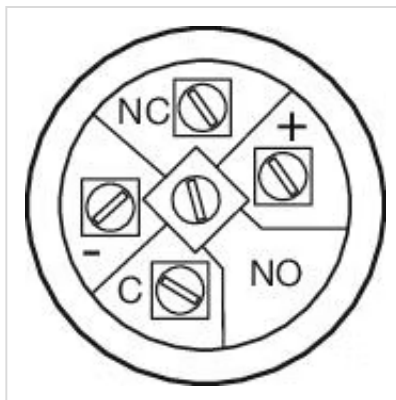

Wiring diagrams:

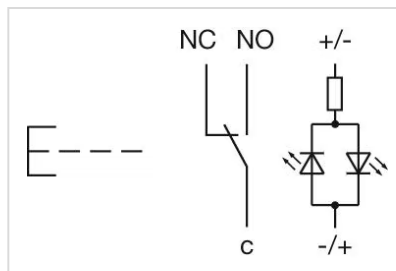

Dimension drawings:

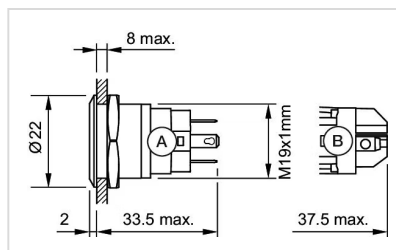

A = Solder terminal
B = Screw terminal

Mounting cut-outs:

