

- NOTES:
1. ALL PARTS TO BE BULK PACKED
  2. CONTACTS SHIPPED UNASSEMBLED
  3. SEE DRAWING HPMUSTD FOR HOLE PATTERN
  4. ALL DIMENSIONS ARE REFERENCE EXCEPT THOSE WITH A TOLERANCE

ASS'Y P/N	CONTACT QTY.
4280-4PG-300	4 #20
4280-5PG-300	5 #20
4280-6PG-300	6 #20
4280-7PG-300	7 #20
4280-8PG-300	8 #20
4280-9PG-300	9 #20

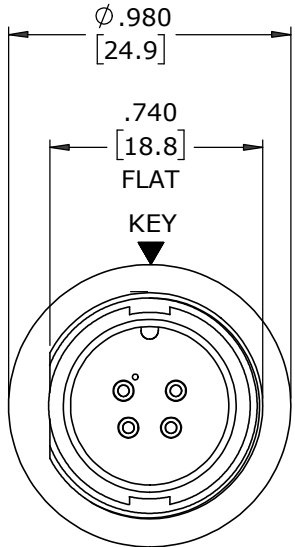

**FACE VIEW**  
4280-4PG-300  
SHOWN

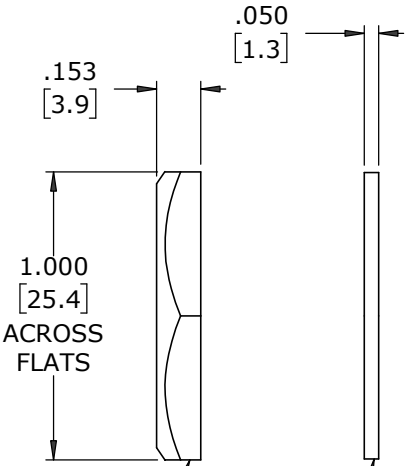

HEX NUT  
MAT'L: NYLON, BLACK  
GASKET  
MAT'L: RUBBER, BLACK

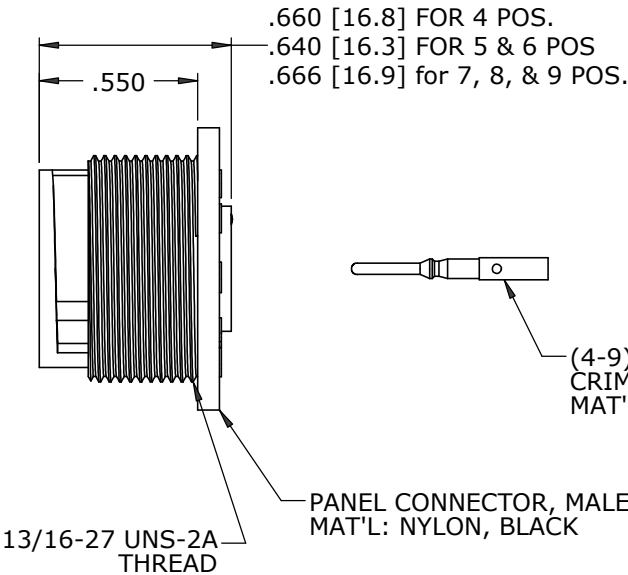
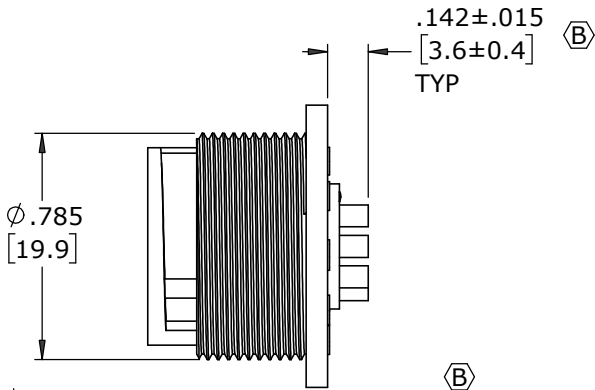

(4-9) #20 PIN CONTACTS  
CRIMP TAIL  
MAT'L: GOLD PLATED COPPER ALLOY

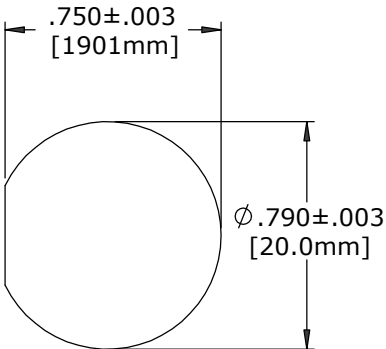

**RECOMMENDED  
PANEL CUT OUT**

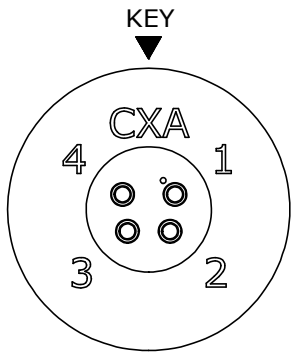

**WIRING VIEW**  
ASSY: 4280-4PG-300

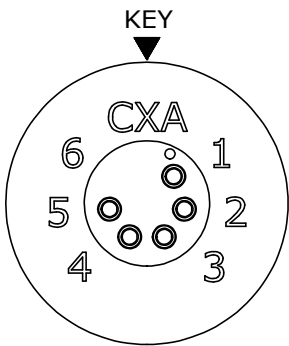

**WIRING VIEW**  
ASSY: 4280-5PG-300

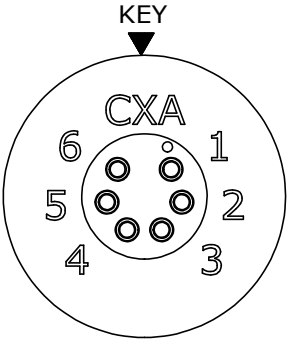

**WIRING VIEW**  
ASSY: 4280-6PG-300

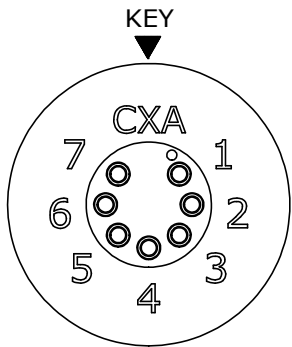

**WIRING VIEW**  
ASSY: 4280-7PG-300

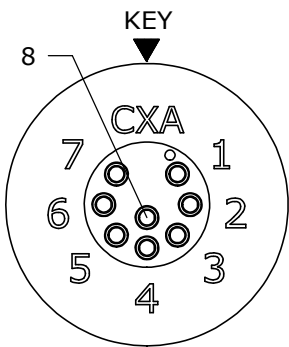

**WIRING VIEW**  
ASSY: 4280-8PG-300

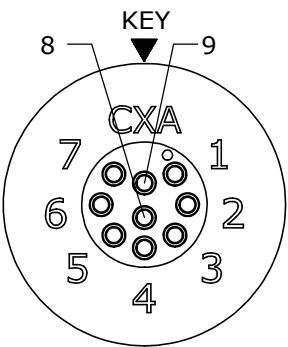

**WIRING VIEW**  
ASSY: 4280-9PG-300

CUSTOMER APPROVAL	
THIS DOCUMENT CONTAINS CONFIDENTIAL INFORMATION PROPRIETARY TO CONXALL CORPORATION. ANY REPRODUCTION, DISCLOSURE, OR USE OF THIS DOCUMENT /INFORMATION IS EXPRESSLY PROHIBITED UNLESS AUTHORIZED IN WRITING BY CONXALL CORPORATION.	
APPROVED BY: _____	DATE: _____
<b>RoHS COMPLIANT</b>	

B	MA	10-14-20	CONNECTOR OVERALL LENGTH WAS .666 FOR 4 POS. .640 FOR ALL REMAINING POS. ADDED CONTACT HEIGHT VIEW. REVISED NOTES PER ECR 9552
A	JD	03-14-14	DRAWING CREATED PER DOR 14-E149SL(13)
REV.	INIT.	DATE	DESCRIPTION
			ALL INFORMATION ILLUSTRATED IS THE PROPERTY OF "CONXALL CORPORATION". UNAUTHORIZED DUPLICATION OR DISTRIBUTION OF THIS DOCUMENT IS PROHIBITED.
			ALL UNITS ARE IN FEET, INCHES, FRACTION OF INCHES AND DECIMALS.
			ORIG. DRAWN BY: JD DATE: 03-14-14
			CHECKED BY:
			APPROVED BY:
			SCALE: NTS SIZE: B SHEET: 1 OF 1
			FILE: 4280-XPG-300 DIRECTORY: SLW
			TITLE: PANEL MOUNT ASSEMBLY (4-9) #20 PIN CONTACTS MULTI-CON-X STANDARD PRODUCT
			CUSTOMER: PART NUMBER: 4280-XPG-300
			REV B

DIMENSIONS IN BRACKETS [ ] ARE IN MILLIMETERS