

RAFIX 16 F - Selector switch, illuminated, momentary

1.30.093.651/2000



General information

| | |
|-------------------------|-------------------|
| Actuator | handle |
| Color of handle marking | translucent white |
| Form of collar | square |
| Color of collar | black |

Dimensions

| | |
|-----------------------------------|----------------|
| Collar dimensions | 24.9 x 24.9 mm |
| Overall height | 12.1 mm |
| Mounting depth with contact block | 50 mm |
| Key grid | 30 x 30 mm |
| Mounting hole | 23.1 x 23.1 mm |

Mechanical design

| | |
|------------------|-----------|
| Mounting | ring nut |
| Contact function | momentary |
| Illumination | yes |
| Rotating angle | 2 x 40° |

Mechanical characteristics

| | |
|-------------|--------|
| Torque max. | 1.3 Nm |
|-------------|--------|

Electrical characteristics

| | |
|------------------|---|
| Protection class | - |
|------------------|---|

Other specifications

| | |
|---|--|
| Operating life (operations) | 30.000 cycle |
| Degree of protection from front side | IP65 (DIN EN 60529) |
| Operation temperature min. | -25 °C |
| Ambient temp. operating max. without lamp / LED | +70 °C |
| Ambient temp. operating max. with lamp / LED | +55 °C |
| Storage temperature min. | -40 °C |
| Storage temperature max. | +85 °C |
| Environmental resistance | acc. to IEC 60068-2-14, -30, -33 and -78 |
| ROHS compliant | yes |
| REACH compliant | yes |

Panel cut-out

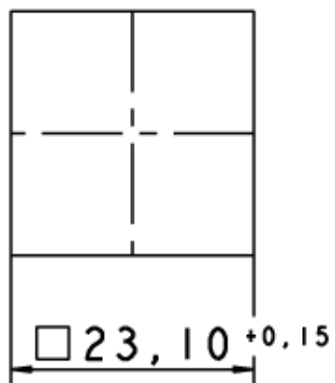

with PCB plug-in socket

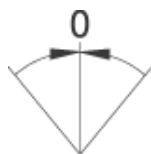
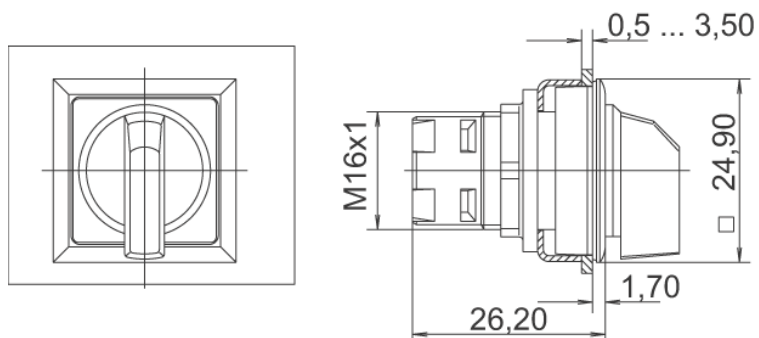
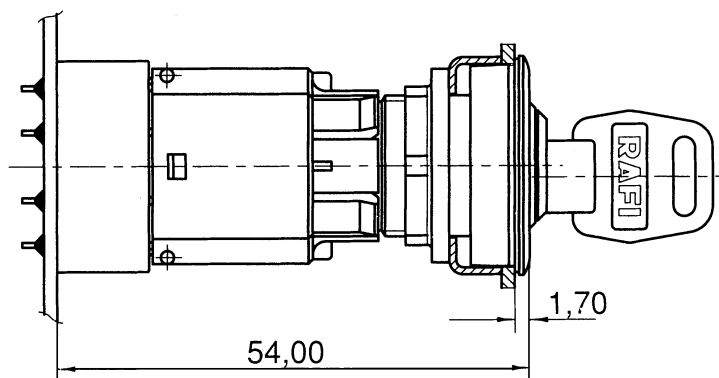

operating element and contact block

