

Pushbutton Ø 16 mm silver contact

82-4161.1000.B001



<https://eao.com/p/82-4161.1000.B001>

Your product:



82-4161.1000.B001

Pushbutton Ø 16 mm silver contact

FRONT

Front bezel shape:	flush
Front bezel material:	Stainless steel

MOUNTING

Mounting cut-out:	Ø 16 mm
-------------------	---------

OPERATING-/INDICATION PART

Lens illumination:	non illuminative
Lens shape:	raised
Lens colour:	Silver
Symbol:	ON/OFF
Lens material:	Stainless steel
Lens optics:	opaque

ELECTRICAL CHARACTERISTICS

Pollution degree:	2, according to EN IEC 60947-1
Thermal current I _{th} :	5 A
Rated Operational Voltage U _e :	250 VAC
Electrical lifetime:	50 000 cycles of operation
Rated insulation voltage U _i :	250 V
Electric strength:	1500 VAC, 50 Hz 1 minute between life terminals and ground
Contacts:	1 C

Switching voltage and switching current:

according to IEC 60947-5-1 (Silver contacts)		
Service categorie AC-15		
Voltage		Current
24 VAC		1 A
35 VAC		1 A (M12 versio
110 VAC		1 A
220 VAC		0.5 A
Switch rating DC service categorie DC-13 (Silver contacts)		
Voltage		Current
24 VDC		0.7 A
35 VDC		0.5 A (M12 vers
110 VDC		0.2 A
220 VDC		0.1 A

according to UL 508 (Silver contacts)	
cosφ 0,75 ... 0,8	
Voltage	Current
120 VAC	5 A
240 VAC	3 A
24 VAC	1 A

MECHANICAL CHARACTERISTIC

Weight:	0.02 kg
Switching system:	Snap-action switching element
Switching action:	Momentary
Tightening torque:	0.5 ... 0.6 Nm
Operating force:	4 N ... 7 N
Terminal:	Soldering terminal, 2.8 x 0.5 mm
Operating Travel:	ca. 3 mm
Contact material:	Silver
Mechanical lifetime:	1 Mio. cycles of operation

AMBIENT CONDITION

Storage temperature:	– 40 °C ... + 80 °C
Vibration resistance:	10 ... 500 Hz, amplitude 1.5 mm p-p according to IEC 60068-2-6
IP front protection:	IP65, IP67
Climate resistance:	Damp heat, 21 days according to IEC 60512-11
Operating temperature:	– 30 °C ... + 70 °C
Shock resistance:	Max. 500 m / s ² as per IEC 60068-2-27

CERTIFICATE

Conformities:

CE, 2011 / 65 / EC (RoHS), 2014 / 35 / EU (LVD)

Approbations:

CB, CCC, C UL, UL

OTHER**Short Description:**

Pushbutton Ø 16 mm silver contact, Momentary, 1 C, Soldering terminal, 2.8 x 0.5 mm, Stainless steel, ON/OFF, Silver

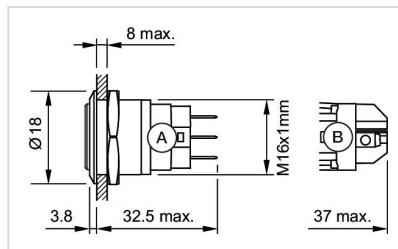
Dimension drawings:

A = Solder terminal
B = Screw terminal

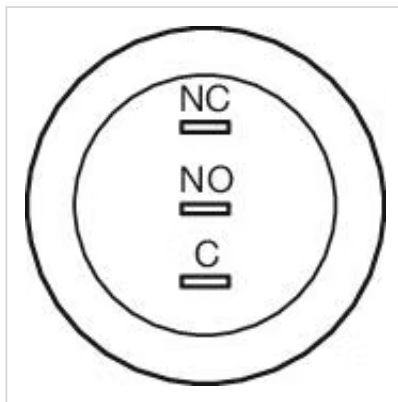
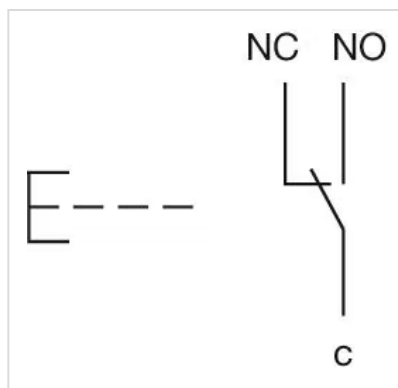
Component layouts:**Wiring diagrams:****Mounting cut-outs:**

