

Features

- Halogen Free. "Green" Device (Note 1)
- Epoxy Meets UL 94 V-0 Flammability Rating
- Moisture Sensitivity Level 1
- Lead Free Finish/RoHS Compliant (Note 2) ("P" Suffix Designates RoHS Compliant. See Ordering Information)

Maximum Ratings @ 25°C (Unless Otherwise Specified)

Parameter	Symbol	Value							Unit
		MBRD1020CT	MBRD1030CT	MBRD1045CT	MBRD1050CT	MBRD1060CT	MBRD1080CT	MBRD10100CT	
Peak Repetitive Reverse Voltage	V _{RRM}	20	30	45	50	60	80	100	V
Working Peak Reverse Voltage	V _{RWM}								
DC Blocking Voltage	V _R								
RMS Reverse Voltage	V _{RMS}	14	21	32	35	42	56	70	V
Average Rectified Forward Current	I _{F(AV)}	5 10							A
Per Diode									
Per Device									
Non-Repetitive Peak Surge Current @ 8.3ms Half Sine Wave	I _{FSM}	150							A
Current Squared Time @1ms≤t≤8.3ms	I ² t	93							A ² s

Marking code

Part Number	Marking Code
MBRD1020CT	MBRD1020CT
MBRD1030CT	MBRD1030CT
MBRD1045CT	MBRD1045CT
MBRD1050CT	MBRD1050CT
MBRD1060CT	MBRD1060CT
MBRD1080CT	MBRD1080CT
MBRD10100CT	MBRD10100CT

Internal Structure

Pin	Description	Simplified Outline	Graphic Symbol
1,3	Anode		
2,4	Cathode		
		XXXXX = Marking Code	

Note: 1. Halogen free "Green" products are defined as those which contain <900ppm bromine, <900ppm chlorine (<1500ppm total Br + Cl) and <1000ppm antimony compounds.

2. High Temperature Solder Exemption Applied, see EU Directive Annex 7a.

10 Amp Schottky Barrier Rectifiers 20 to 100 Volts

(TO-252) DPAK

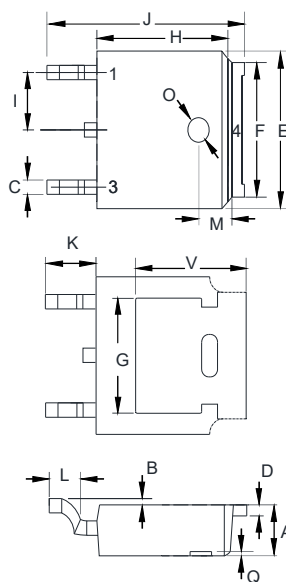

DIMENSIONS					
DIM	INCHES		MM		NOTE
	MIN	MAX	MIN	MAX	
A	0.087	0.094	2.20	2.40	
B	0.000	0.005	0.00	0.13	
C	0.026	0.034	0.66	0.86	
D	0.018	0.023	0.46	0.58	
E	0.256	0.264	6.50	6.70	
F	0.201	0.215	5.10	5.46	
G	0.190		4.83		
H	0.236	0.244	6.00	6.20	
I	0.086	0.094	2.18	2.39	
J	0.386	0.409	9.80	10.40	
K	0.114		2.90		
L	0.055	0.067	1.40	1.70	
M	0.063		1.60		
O	0.043	0.051	1.10	1.30	
Q	0.000	0.012	0.00	0.30	
V	0.211		5.35		

Thermal characteristics

Symbol	Parameter	Conditions	Min	Typ	Max	Unit
T_J	Operating Junction Temperature Range		-55		150	°C
T_{stg}	Storage Temperature Range		-55		150	°C
$R_{th(J-C)}$	Thermal Resistance from Junction to Case			2.5		°C/W

Electrical Characteristics @ 25°C Unless Otherwise Specified

Parameter	Symbol	Test Conditions	Min	Typ	Max	Unit
Forward Voltage Per Diode MBRD1020CT~45CT MBRD1050CT~60CT MBRD1080CT~100CT	V_F	$I_F=5A; T_J=25^{\circ}C$			0.65 0.75 0.85	V
Reverse Current Per Diode MBRD1020CT~60CT MBRD1080CT~100CT	I_R	at Rated $V_R; T_J=25^{\circ}C$ at Rated $V_R; T_J=100^{\circ}C$ at Rated $V_R; T_J=25^{\circ}C$ at Rated $V_R; T_J=100^{\circ}C$			0.1 10 0.01 5	mA
Junction Capacitance Per Diode MBRD1020CT~45CT MBRD1050CT~60CT MBRD1080CT~100CT	C_J	$V_R=4V; f=1MHz; T_J=25^{\circ}C$		205 140 120		pF

Curve Characteristics

Fig. 1 - Forward Current Derating Curve

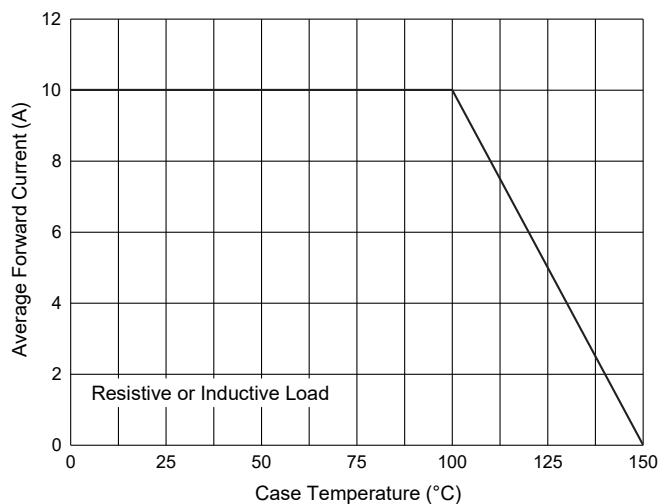

Fig. 2 - Maximum Non-Repetitive Peak Forward Surge Current Per Diode

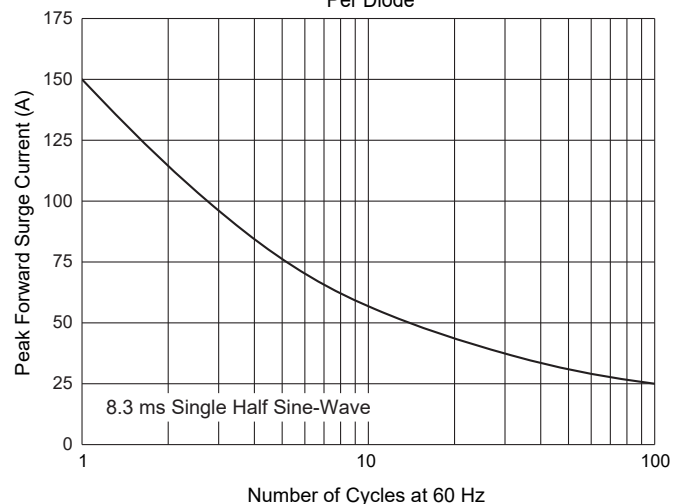

Fig. 3 - Typical Instantaneous Forward Characteristics Per Diode

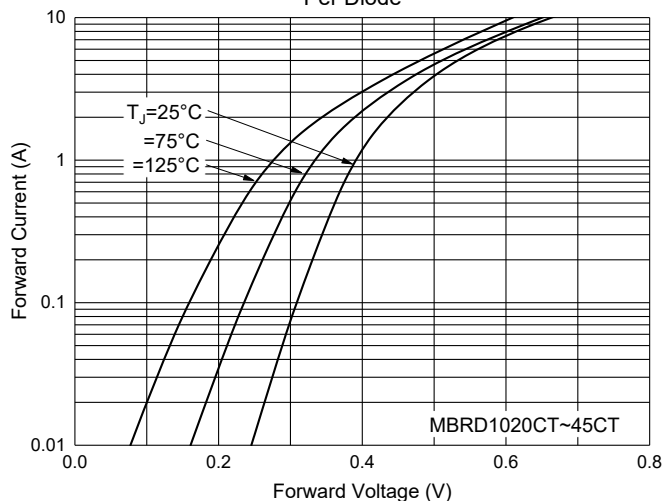

Fig. 4 - Typical Reverse Leakage Characteristics Per Diode

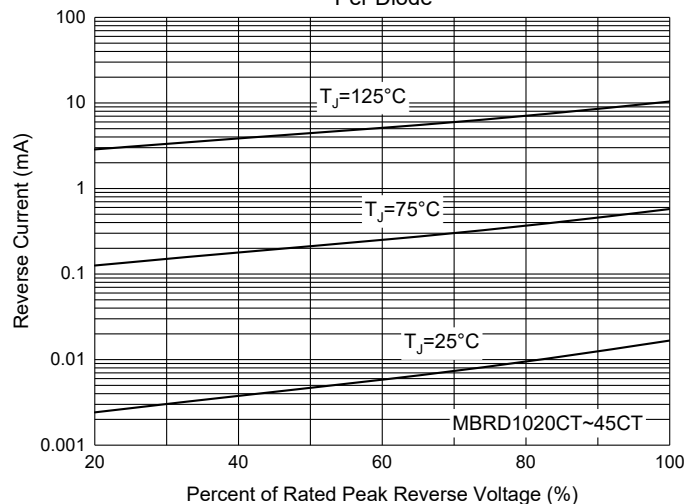

Fig. 5 - Typical Instantaneous Forward Characteristics Per Diode

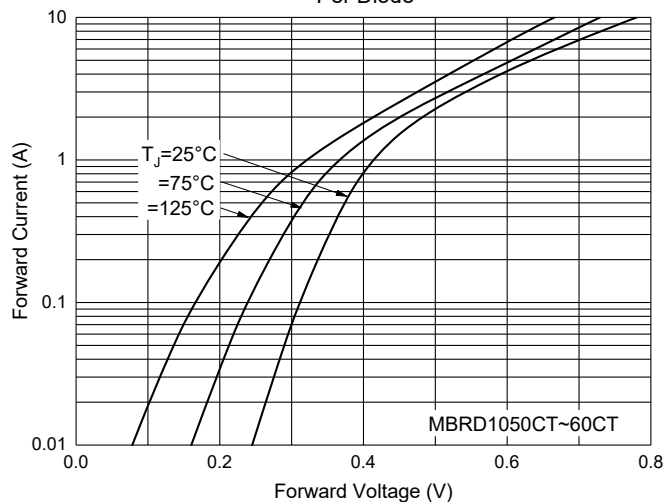
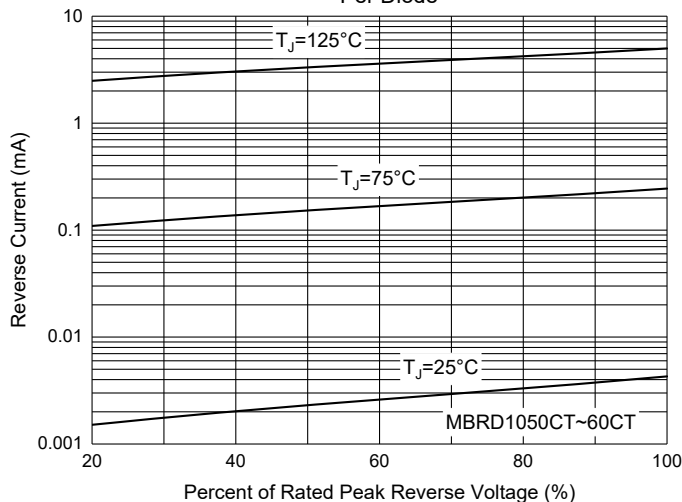

Fig. 6 - Typical Reverse Leakage Characteristics Per Diode



Curve Characteristics

Fig. 7 - Typical Instantaneous Forward Characteristics Per Diode

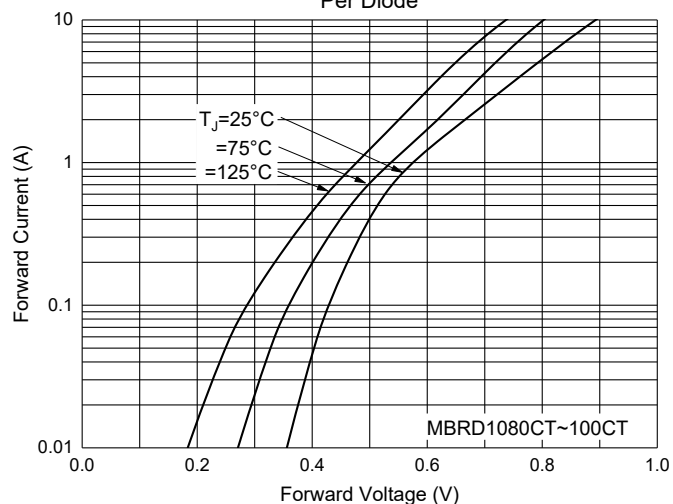

Fig. 8 - Typical Reverse Leakage Characteristics Per Diode

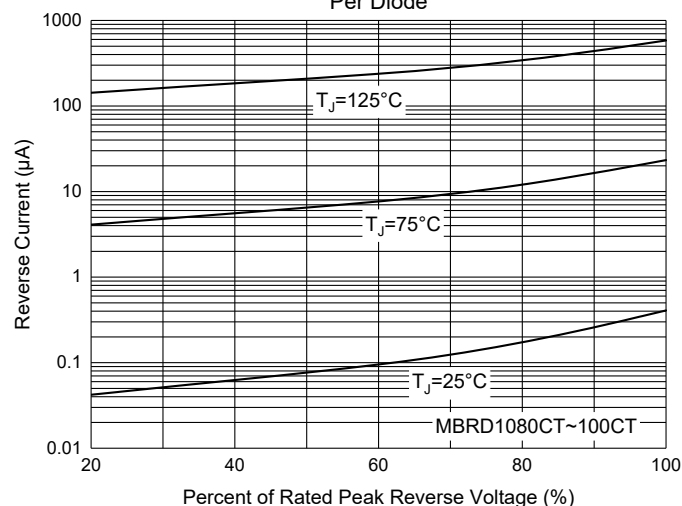
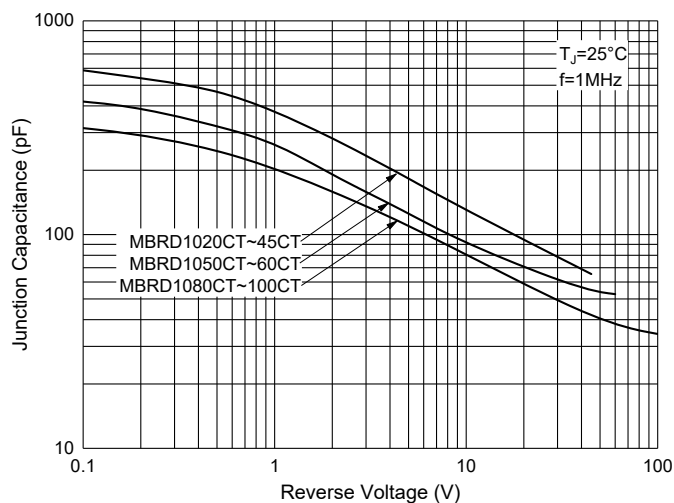

Fig. 9 - Typical Capacitance Characteristics Per Diode



Ordering Information

Device	Packing
Part Number-TP	Tape&Reel: 2.5Kpcs/Reel

IMPORTANT NOTICE

Micro Commercial Components Corp. reserves the right to make changes without further notice to any product herein to make corrections, modifications , enhancements , improvements , or other changes . **Micro Commercial Components Corp** . does not assume any liability arising out of the application or use of any product described herein; neither does it convey any license under its patent rights ,nor the rights of others . The user of products in such applications shall assume all risks of such use and will agree to hold **Micro Commercial Components Corp** . and all the companies whose products are represented on our website, harmless against all damages. **Micro Commercial Components Corp**. products are sold subject to the general terms and conditions of commercial sale, as published at <https://www.mccsemi.com/Home/TermsAndConditions>.

LIFE SUPPORT

MCC's products are not authorized for use as critical components in life support devices or systems without the express written approval of Micro Commercial Components Corporation.

CUSTOMER AWARENESS

Counterfeiting of semiconductor parts is a growing problem in the industry. Micro Commercial Components (MCC) is taking strong measures to protect ourselves and our customers from the proliferation of counterfeit parts. MCC strongly encourages customers to purchase MCC parts either directly from MCC or from Authorized MCC Distributors who are listed by country on our web page cited below. Products customers buy either from MCC directly or from Authorized MCC Distributors are genuine parts, have full traceability, meet MCC's quality standards for handling and storage. **MCC will not provide any warranty coverage or other assistance for parts bought from Unauthorized Sources.** MCC is committed to combat this global problem and encourage our customers to do their part in stopping this practice by buying direct or from authorized distributors.