

NOTES:

1.  $\odot$  REPRESENTS A CRITICAL DIMENSION.
2. POSITIONS -04 THRU -50 ARE TO BE TUBED.
3. POSITIONS 02 & 03 ARE TO BE LAYERED PACKAGED.
4. MAXIMUM CUT FLASH: .010[.25].
5. STAKED ALIGNMENT PIN USED AT SAMTECS DISCRETION.
6. MEASURE THE HEIGHT FROM THE EDGE, NOT THE BREAK OFF.
7. MEASURED AT BEND RADIUS, NOT END OF PIN.
8. DUE TO THE HIGH AMOUNT OF INSERTION FORCE NEEDED, THE -LC OPTION IS NOT COMPATIBLE WITH AUTO PLACEMENT. SAMTEC RECOMMENDS MANUAL PLACEMENT FOR ALL ASSEMBLIES WITH THE -LC OPTION.
9. MINIMUM PUSHOUT FORCE: .5 LB.
10. COPLANARITY MEASURED AT .0016[0.041] IN/IN

DO NOT  
SCALE FROM  
THIS PRINT

SQW-1XX-01-XXX-D-VS-XX-XXX

No OF POSITIONS  
-02 THRU -50  
(PER ROW)  
LEAD STYLE  
-01

POLARIZATION OPTION  
-XXX: INDICATES POSITION POLARIZED  
(USE PK-07-N, SEE FIG 2, SHT 2)

OPTION  
-A: STAKED & MOLDED IN ALIGNMENT PIN  
(5 POS MIN) (USE SM-A8H, SEE FIG 3, SHT 2)  
-LC: LOCKING CLIP (5 POS MIN)  
(USE LC-07-TM, SEE FIG 4, SHT 2 & NOTE 8)  
-P: PICK & PLACE PAD (4 POS MIN)  
(USE LMP-03, SEE FIG 6, SHT 2)  
-TR: TAPE & REEL  
(AVAILABLE POS 4 THRU 28)  
-K: POLYAMIDE FILM PAD (4 POS MIN)  
(USE K-500-300, SEE FIG 7, SHT 2)  
(.005 [.13] THICKNESS WITH SILICONE ADHESIVE)

TAIL STYLE  
-VS: VERTICAL

ROW SPECIFICATION  
-D: DOUBLE (USE SQW-XX-D)

PLATING SPECIFICATION

-F: 3 $\mu$ " FLASH SELECTIVE GOLD IN CONTACT AREA  
MATTE TIN ON TAIL  
-L: 10 $\mu$ " LIGHT SELECTIVE GOLD IN CONTACT AREA  
MATTE TIN ON TAIL  
-S: 30 $\mu$ " SELECTIVE GOLD IN CONTACT AREA  
MATTE TIN ON TAIL  
-STL: 30 $\mu$ " SELECTIVE GOLD IN CONTACT AREA  
TIN/LEAD (93/7+/-5%) TAIL  
-H: 30 $\mu$ " HEAVY GOLD IN CONTACT AREA  
3 $\mu$ " ON TAIL  
-FM: 3 $\mu$ " FLASH SELECTIVE GOLD IN CONTACT AREA  
MATTE TIN ON TAIL  
-LM: 10 $\mu$ " LIGHT SELECTIVE GOLD IN CONTACT AREA  
MATTE TIN ON TAIL  
-SM: 30 $\mu$ " SELECTIVE GOLD IN CONTACT AREA  
MATTE TIN ON TAIL

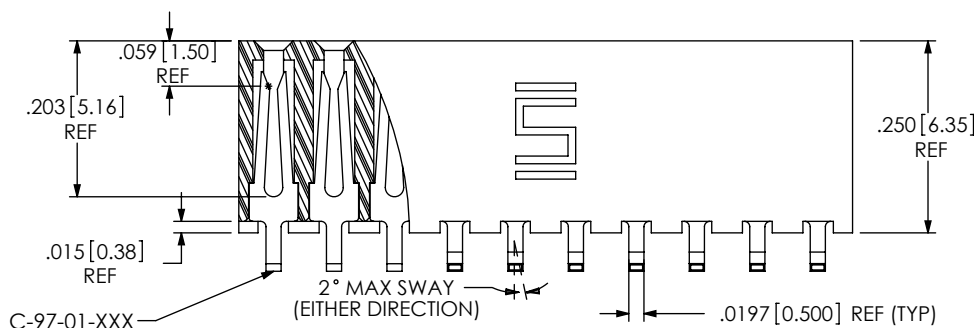
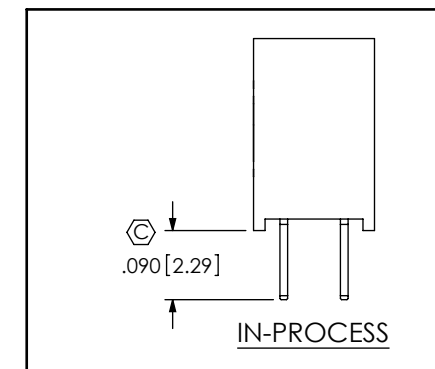
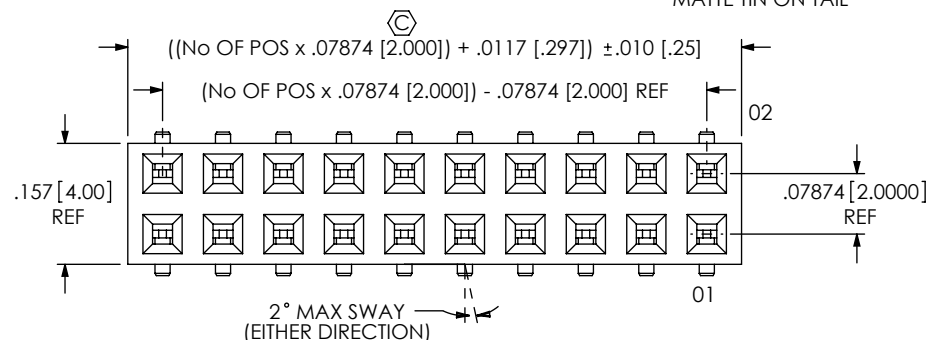
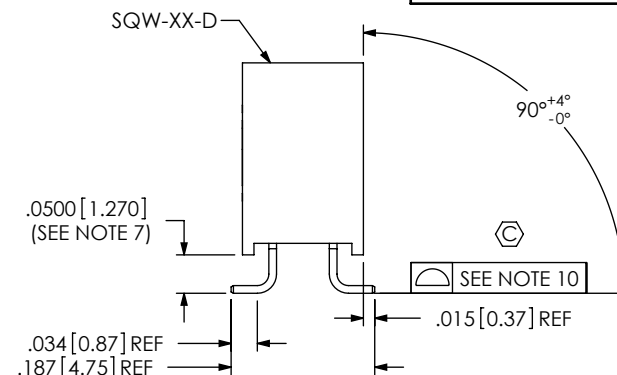

FIG 1

SQW-110-01-XXX-D-VS SHOWN



UNLESS OTHERWISE SPECIFIED,  
DIMENSIONS ARE IN INCHES.  
TOLERANCES ARE:  
DECIMALS ANGLES  
.XX: ±.01 [.3]  
.XXX: ±.005 [.13]  
.XXXX: ±.0020 [.051]

PROPRIETARY NOTE  
THIS DOCUMENT CONTAINS INFORMATION  
CONFIDENTIAL AND PROPRIETARY TO  
SAMTEC, INC. AND SHALL NOT BE REPRODUCED  
OR TRANSFERRED TO OTHER DOCUMENTS OR  
DISCLOSED TO OTHERS OR USED FOR ANY  
PURPOSE OTHER THAN THAT WHICH IT WAS  
OBTAINED WITHOUT THE EXPRESSED WRITTEN  
CONSENT OF SAMTEC, INC.

**samtec**

520 PARK EAST BLVD, NEW ALBANY, IN 47150  
PHONE: 812-944-6733 FAX: 812-948-5047  
e-Mail info@SAMTEC.com code 55322

MATERIAL: DO NOT SCALE DRAWING SHEET SCALE: 4:1  
INSULATOR: LCP, UL 94 VO, COLOR: BLACK  
TERMINAL: PHOSPHOR BRONZE

DESCRIPTION:  
2MM SOCKETS TRIP ASSEMBLY

DWG. NO.  
SQW-1XX-01-XXX-D-VS-XX-XXX

BY: DEAN P 04/22/1997 SHEET 1 OF 3

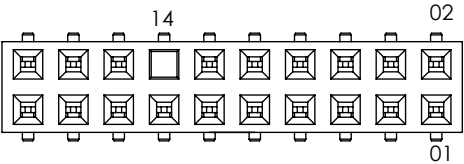

FIG 2  
POLARIZATION OPTION LOCATION  
INSERT PK-07-N INTO SPECIFIED  
POSITION AND BREAK OFF TAB  
SQW-110-01-XXX-D-VS-014 SHOWN  
(DIFFERENT AS SHOWN, OTHERWISE SAME AS FIG 1)

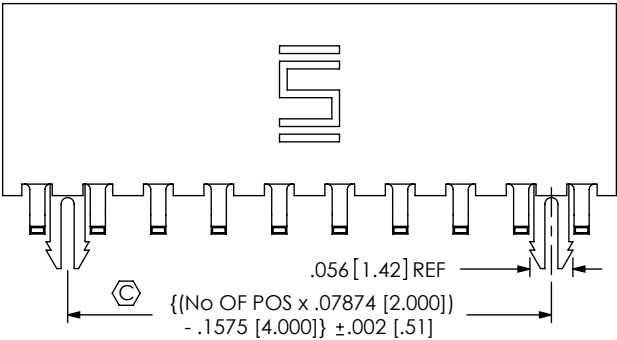

FIG 4  
-LC: LOCKING CLIP  
(5 POS MIN)  
SQW-110-01-XXX-D-VS-LC SHOWN  
(DIFFERENT AS SHOWN, OTHERWISE SAME AS FIG 1)

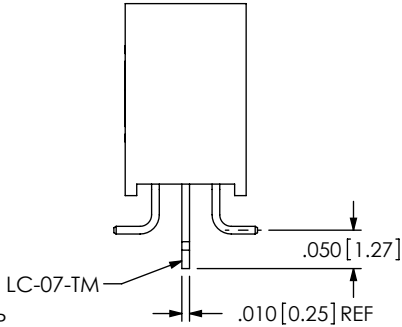

FIG 5  
-A: MOLDED ALIGNMENT PIN  
(5 POS MIN)  
SQW-110-01-XXX-D-VS-A SHOWN  
(DIFFERENT AS SHOWN, OTHERWISE SAME AS FIG 1)

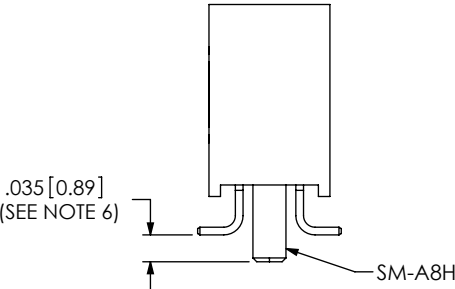

FIG 3  
-A: STAKED ALIGNMENT PIN  
(5 POS MIN)  
SQW-110-01-XXX-D-VS-A SHOWN  
(DIFFERENT AS SHOWN, OTHERWISE SAME AS FIG 1)

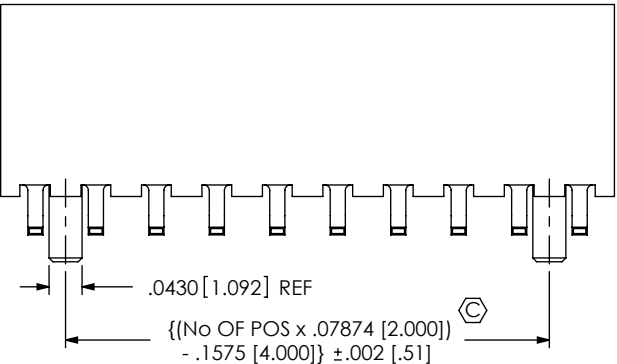

FIG 6  
-P: PICK & PLACE PAD  
(4 POS MIN)  
SQW-110-01-XXX-D-VS-P SHOWN  
(DIFFERENT AS SHOWN, OTHERWISE SAME AS FIG 1)

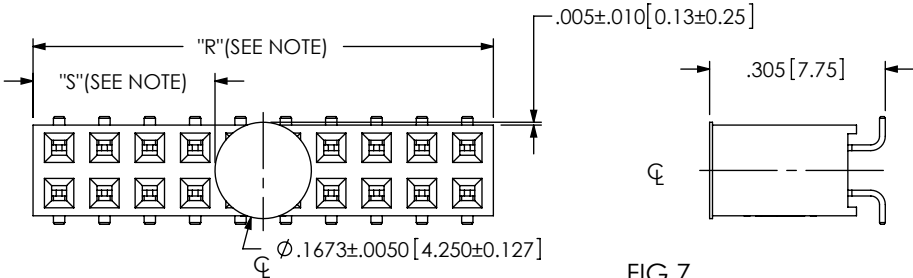
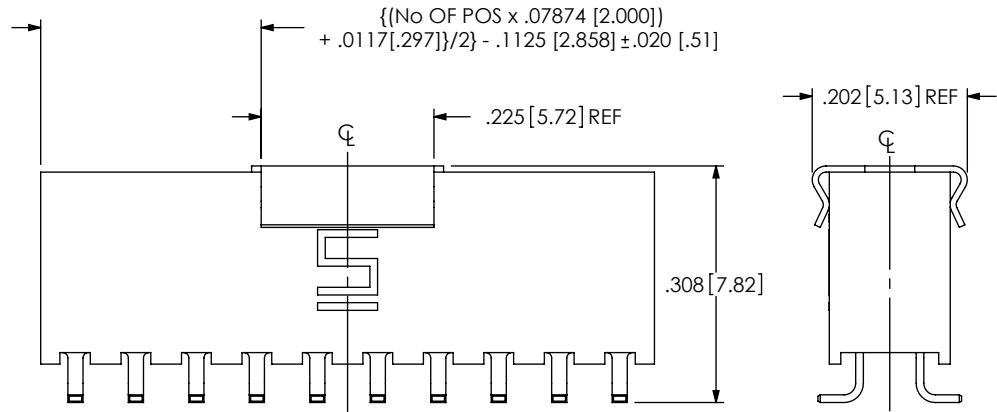

FIG 7  
POLYAMIDE FILM PAD  
(4 POS MIN)  
SQW-110-01-XXX-D-VS-K SHOWN  
(DIFFERENT AS SHOWN, OTHERWISE SAME AS FIG 1)

PROPRIETARY NOTE  
THIS DOCUMENT CONTAINS INFORMATION  
CONFIDENTIAL AND PROPRIETARY TO  
SAMTEC, INC. AND SHALL NOT BE REPRODUCED  
OR TRANSFERRED TO OTHER DOCUMENTS OR  
DISCLOSED TO OTHERS OR USED FOR ANY  
PURPOSE OTHER THAN THAT WHICH IT WAS  
OBTAINED WITHOUT THE EXPRESSED WRITTEN  
CONSENT OF SAMTEC, INC.

DO NOT SCALE DRAWING  
SHEET SCALE: 4:1

**samtec**

520 PARK EAST BLVD, NEW ALBANY, IN 47150  
PHONE: 812-944-6733 FAX: 812-948-5047  
e-Mail: info@SAMTEC.com code 55322

DESCRIPTION:  
2MM SOCKETS TRIP ASSEMBLY  
DWG. NO.  
SQW-1XX-01-XXX-D-VS-XX-XXX  
BY: DEAN P 04/22/1997 SHEET 2 OF 3

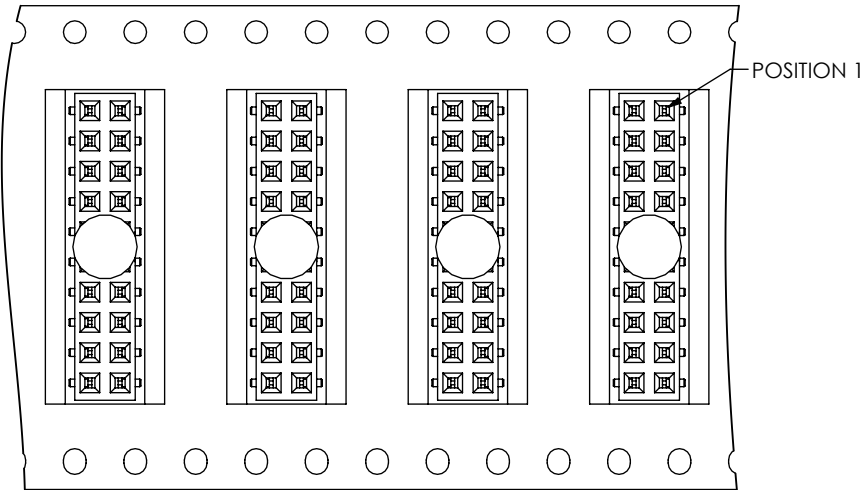

USER DIRECTION OF UNREELING →  
POCKET NOT DETAILED

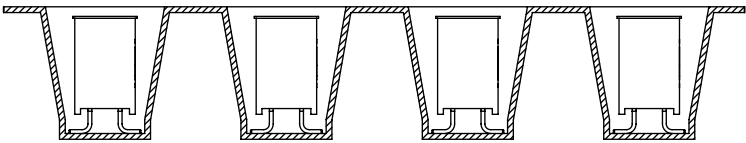

PARTS TO COME OFF REEL AS SHOWN  
WITH POCKETS FACING UP

TAPE & REEL VIEW

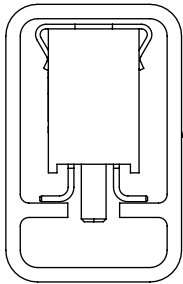

PT-1-24-03-09  
TP-09

TUBE VIEW

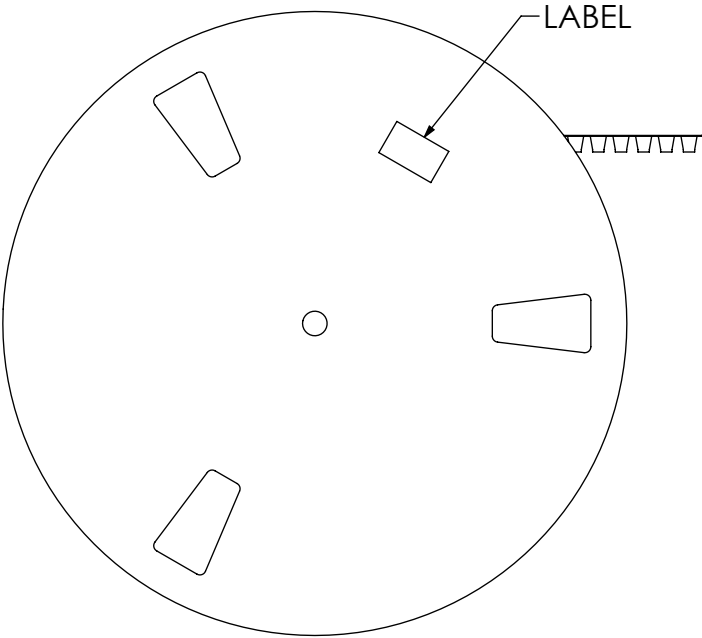
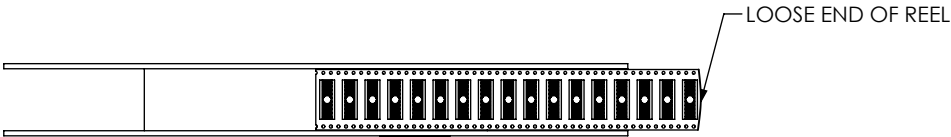

UNWINDING DIRECTION →

REEL

PROPRIETARY NOTE  
THIS DOCUMENT CONTAINS INFORMATION  
CONFIDENTIAL AND PROPRIETARY TO  
SAMTEC, INC. AND SHALL NOT BE REPRODUCED  
OR TRANSFERRED TO OTHER DOCUMENTS OR  
DISCLOSED TO OTHERS OR USED FOR ANY  
PURPOSE OTHER THAN THAT WHICH IT WAS  
OBTAINED WITHOUT THE EXPRESSED WRITTEN  
CONSENT OF SAMTEC, INC.

DO NOT SCALE DRAWING

SHEET SCALE: 4:1

**samtec**

520 PARK EAST BLVD, NEW ALBANY, IN 47150  
PHONE: 812-944-6733 FAX: 812-948-5047  
e-Mail: info@SAMTEC.com code 55322

DESCRIPTION:  
2MM SOCKETS TRIP ASSEMBLY

DWG. NO.  
**SQW-1XX-01-XXX-D-VS-XX-XXX**

BY: DEAN P 04/22/1997 SHEET 3 OF 3