

# Illuminated pushbutton Ø 22 mm stainless steel 304, with symbol

82-6151.1A24.B006



<https://eao.com/p/82-6151.1A24.B006>

Your product:

---



82-6151.1A24.B006

Illuminated pushbutton Ø 22 mm  
stainless steel 304, with symbol

#### FRONT

Front bezel shape:	flush
Front bezel material:	Stainless steel

#### MOUNTING

Mounting cut-out:	Ø 22 mm
-------------------	---------

#### OPERATING-/INDICATION PART

Illumination colour:	Green
Lens illumination:	illuminative
Lens shape:	flush
Symbol:	Door open
Lens optics:	opaque
Shape of illumination:	Symbol
Lens material:	Plastic metalised
Lens colour:	Silver

#### ELECTRICAL CHARACTERISTICS

Rated insulation voltage $U_i$ :	250 V
Thermal current $I_{th}$ :	5 A
Operating voltage:	24 V DC
Contacts:	1 C
Switching voltage and switching current:	

according to IEC 60947-5-1 (Silver contacts)

Service categorie AC-15

Voltage

24 VAC

35 VAC

110 VAC

220 VAC

Current

1 A

1 A (M12 version)

1 A

0.5 A

Switch rating DC service categorie DC-13 (Silver contacts)

Voltage

24 VDC

35 VDC

110 VDC

220 VDC

Current

0.7 A

0.5 A (M12 version)

0.2 A

0.1 A

according to UL 508 (Silver contacts)

$\cos\phi$  0,75 ... 0,8

Voltage

120 VAC

240 VAC

24 VAC

Current

5 A

3 A

1 A

**Pollution degree:**

2, according to EN IEC 60947-1

**Rated Operational Voltage  $U_e$ :**

250 VAC

**Electric strength:**

1500 VAC, 50 Hz 1 minute between life terminals and ground

**Electrical lifetime:**

50 000 cycles of operation

## MECHANICAL CHARACTERISTIC

**Mechanical lifetime:**

1 Mio. cycles of operation

**Contact material:**

Silver

**Tightening torque:**

0.5 ... 0.6 Nm

**Switching action:**

Momentary

**Operating force:**

4 N ... 7 N

**Switching system:**

Snap-action switching element

**Weight:**

0.025 kg

**Operating Travel:**

ca. 3 mm

**Terminal:**

Soldering terminal, 2.8 x 0.5 mm

## AMBIENT CONDITION

**Storage temperature:**

- 40 °C ... + 80 °C

**Operating temperature:**

- 30 °C ... + 70 °C

**Climate resistance:**

Damp heat, 21 days according to IEC 60512-11

**Shock resistance:**

Max. 500 m / s<sup>2</sup> as per IEC 60068-2-27

**Vibration resistance:**

10 ... 500 Hz, amplitude 1.5 mm p-p according to IEC 60068-2-6

**IP front protection:** IP65, IP67

## CERTIFICATE

**Conformities:** CE, 2011 / 65 / EC (RoHS), 2014 / 35 / EU (LVD)

**Approbations:** CB, CCC, C UL, UL

## OTHER

**Kind of illumination:** Single-LED

**Short Description:** Illuminated pushbutton Ø 22 mm stainless steel 304, with symbol, Momentary, 24 V DC, 1 C, Soldering terminal, 2.8 x 0.5 mm, Stainless steel, Green, Door open, Silver

**Component layouts:**

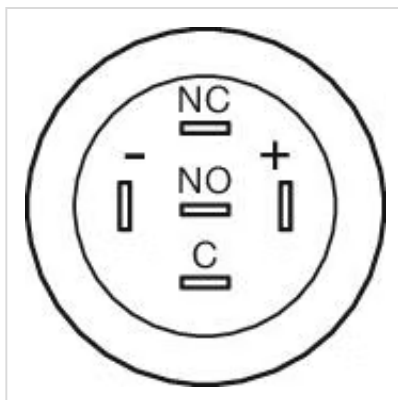

**Mounting cut-outs:**

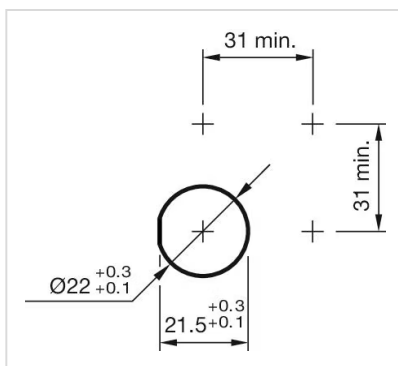

**Wiring diagrams:**

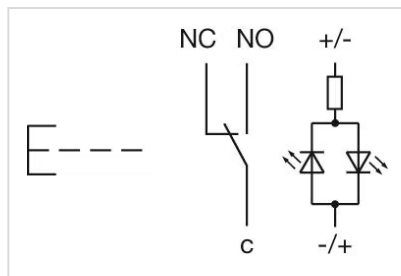

**Dimension drawings:**

