

SUMMARY

Wires

Low voltage 2



Image is for illustrative purpose only

| | |
|------------------|--------------------------------|
| Series | 1B |
| Termination type | Male crimp |
| IP rating | 50 |
| AWG wire size | 20.00 - 18.00 |
| Cable Ø | 5.30 - 6.20 mm |
| Status | active |
| Matching parts | EGG.1B.302.CYM |

Download

[Request a quote](#)

[Catalog](#)

TECHNICAL DETAILS

Mechanics

| | |
|-------------------|---|
| Shell Style/Model | FP*: Elbow (90°) plug with cable collet |
| Keying | 1 key (alpha=0, plug: male contacts, receptacle: female contacts) |
| Housing Material | Brass (chrome plated [SAE AMS 2460]) shell and collet nut, nickel plated [SAE AMS QQ N 290] brass latch sleeve and mid pieces |
| Weight | 21.85 g |

Performance

| | |
|---------------|----------------------------|
| Configuration | 1B.302 : 2 Low Voltage |
| Insulator | Y: PEEK for crimp contacts |
| Rated Current | 15 Amps |

Specifications

| |
|---|
| Contact Type: Crimp |
| Contact Retention: 40 N |
| Contact Dia.: 1.3 mm (0.051in) |
| Bucket Dia.: 1.4 mm (0.055in) |
| Min. Conductor: 0.5 mm ² (AWG 20) |
| Max. Conductor: 1 mm ² (AWG 18) |
| R (max): 3.6 mOhm |
| Vtest (contact-shell): 1450 V (AC), 2100 V (DC) |

LEMO products and services are provided "as is". LEMO makes no warranties or representations with regard to LEMO product & services or use of them, express, implied or statutory, including for accuracy, completeness, or security. The user is fully responsible for his products and applications using LEMO components.

Vtest (contact-contact): 1700 V (AC), 2400 V (DC)

Others

- Endurance (Shell): 5000
- Temp (min / max): -55°C / +250°C
- Humidity (max): <=95% [at 60 deg C / 140 F]
- Vibration: 15 g [10 Hz - 2000 Hz]
- Shock Resistance: 100 g [6 ms]
- Climatical Category: 50/175/21
- Shielding (min): 75 dB (10 MHz)
- Shielding (min): 40 dB (1 GHz)
- Salt Spray Corrosion: >1000 hr

DRAWINGS

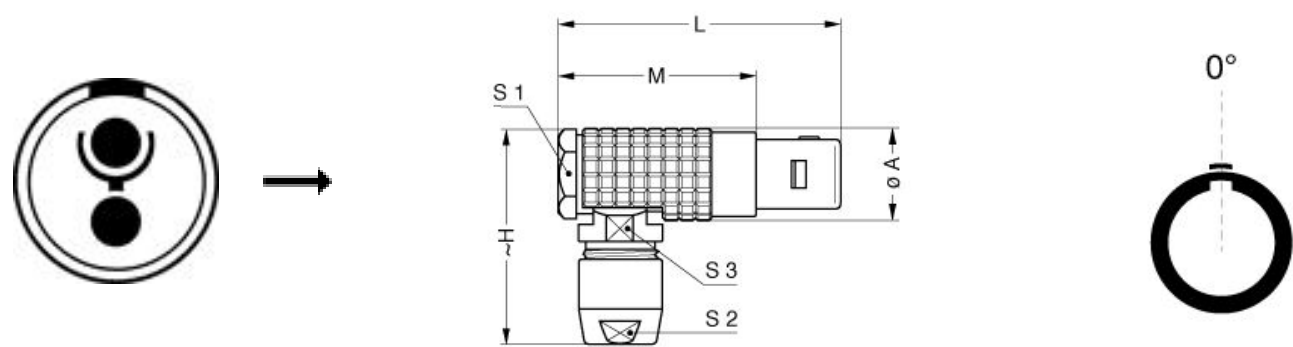

Dimensions

| | A | H | L | M | S1 | S2 | S3 |
|-----|------|------|------|------|------|------|------|
| mm. | 12 | 29 | 36 | 25 | 11 | 9 | 10 |
| in. | 0,47 | 1,14 | 1,42 | 0,98 | 0,43 | 0,35 | 0,39 |

RECOMMENDED BY LEMO

Tools

LEMO products and services are provided “as is”. LEMO makes no warranties or representations with regard to LEMO product & services or use of them, express, implied or statutory, including for accuracy, completeness, or security. The user is fully responsible for his products and applications using LEMO components.

Crimp Tool: [DPC.91.701.V](#)
Crimp settings: AWG/Selector = 18-20/8-7
Positionner: [DCE.91.131.BVC](#)
Extractor: [DCF.91.131.2LT](#)
Replacement contact: FGG.1B.565.ZZC
Spanner wrench: [DCD.1B.015.PA090](#)

Cables

| | | | |
|--------|-----|-------|--|
| 102080 | PVC | Grey | |
| 120184 | PVC | Black |  |
| 120500 | PVC | Grey |  |
| 120751 | PVC | Grey |  |
| 220750 | PVC | Grey |  |

LEMO products and services are provided “as is”. LEMO makes no warranties or representations with regard to LEMO product & services or use of them, express, implied or statutory, including for accuracy, completeness, or security. The user is fully responsible for his products and applications using LEMO components.