

LOC	DIST	REVISIONS					
		P	LTR	DESCRIPTION	DATE	DWN	APVD
GP	00		A	RELEASE	29FEB2016	JY	SH

- ⚠ SURFACE TRACES PERMITTED WITHIN THIS AREA EXCEPT WHERE CAGE STANDOFFS, SHOWN IN DETAIL S, CONTACT PC BOARD.
- ⚠ PITCH BETWEEN PORTS OF ONE 1X2 CAGE ASSEMBLY.
- ⚠ SPACING BETWEEN CAGES ON THE SAME PC BOARD, TO BE SPECIFIED BY CUSTOMER, MUST COMPLY WITH MINIMUM DIMENSIONS SHOWN.
- ⚠ REFERENCE APPLICATION SPEC 114-32023 FOR RECOMMENDED DRILL HOLE DIAMETER AND PLATING THICKNESS.
- ⚠ UNPLATED THRU HOLE.
- ⚠ DATUMS AND BASIC DIMENSIONS ESTABLISHED BY CUSTOMER.
- ⚠ DATUM A IS TOP SURFACE OF PC BOARD.
- ⚠ DIMENSION C IS THE NOMINAL THICKNESS OF CUSTOMER SUPPLIED PC BOARD.
- MINIMUM PC BOARD THICKNESS:
SINGLE SIDED = 1.45mm
DOUBLE SIDED = 2.2mm
- 9 MATES WITH QSFP MSA COMPATIBLE TRANSCEIVER.
- ⚠ BASELINE FOR THESE DIMENSIONS IS THE CENTER OF COMPLIANT PIN HOLE.
- ⚠ DATE CODE (YYWWD) MARKED APPROXIMATELY AS SHOWN.
- ⚠ MATERIAL/FINISH:
CAGE ASSEMBLY: NICKEL SILVER, 0.25 THICK
EMI SPRINGS: COPPER ALLOY/TIN
FRONT FLANGE: ZINC ALLOY/TIN OVER NICKEL AND COPPER
EMI GASKET: BURRER FOAM

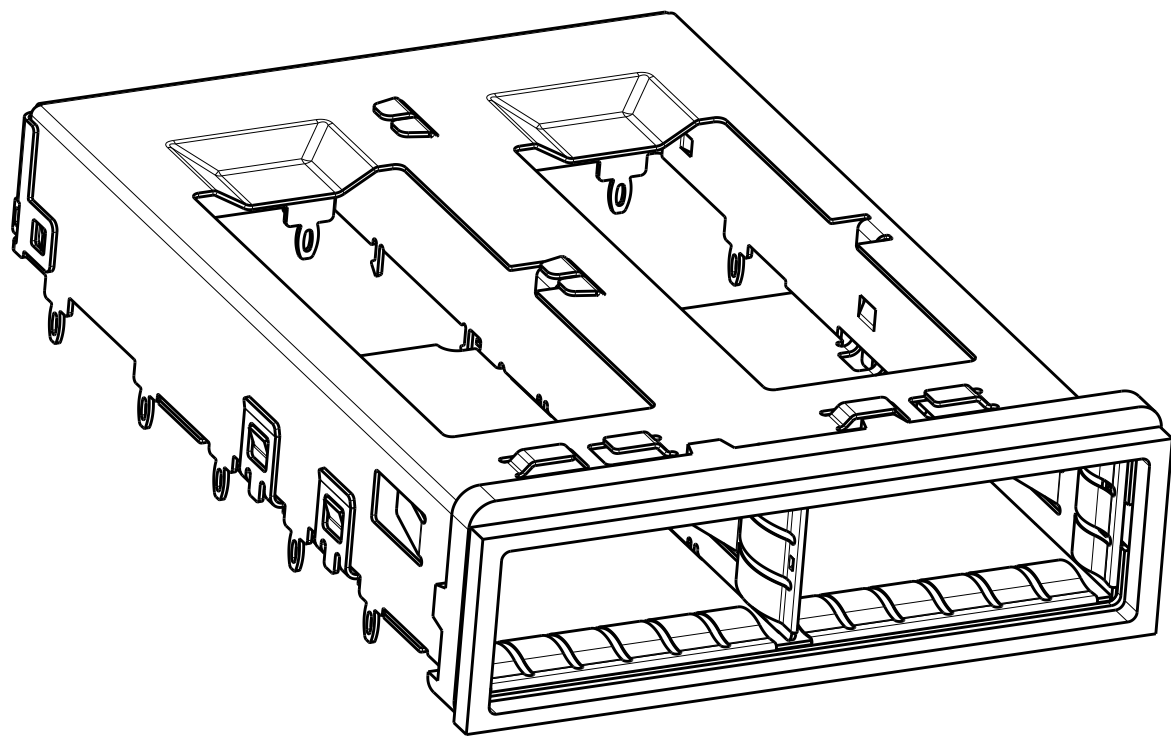

ISOMETRIC VIEW
SCALE 5:2

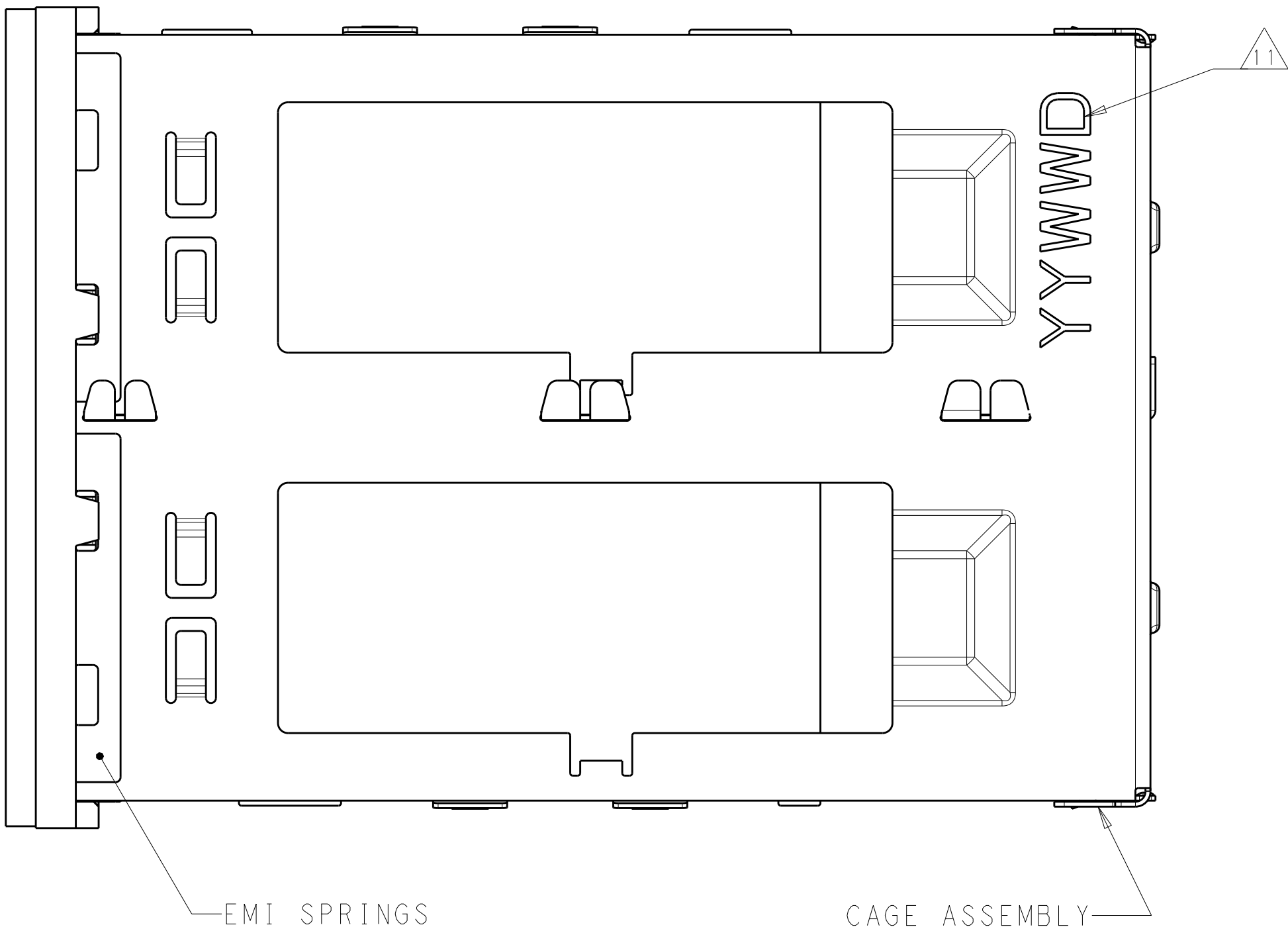
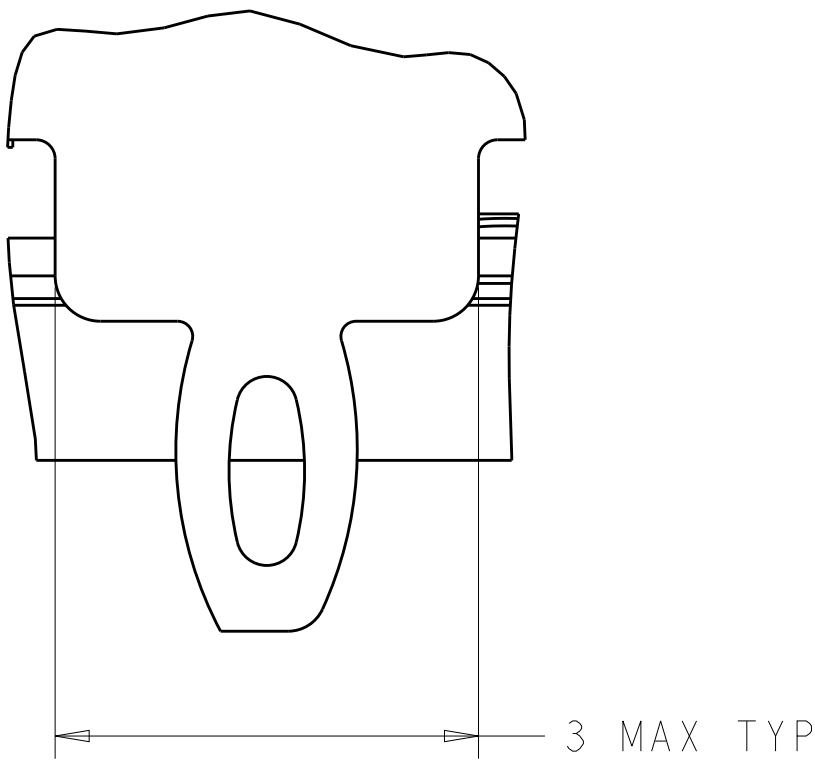
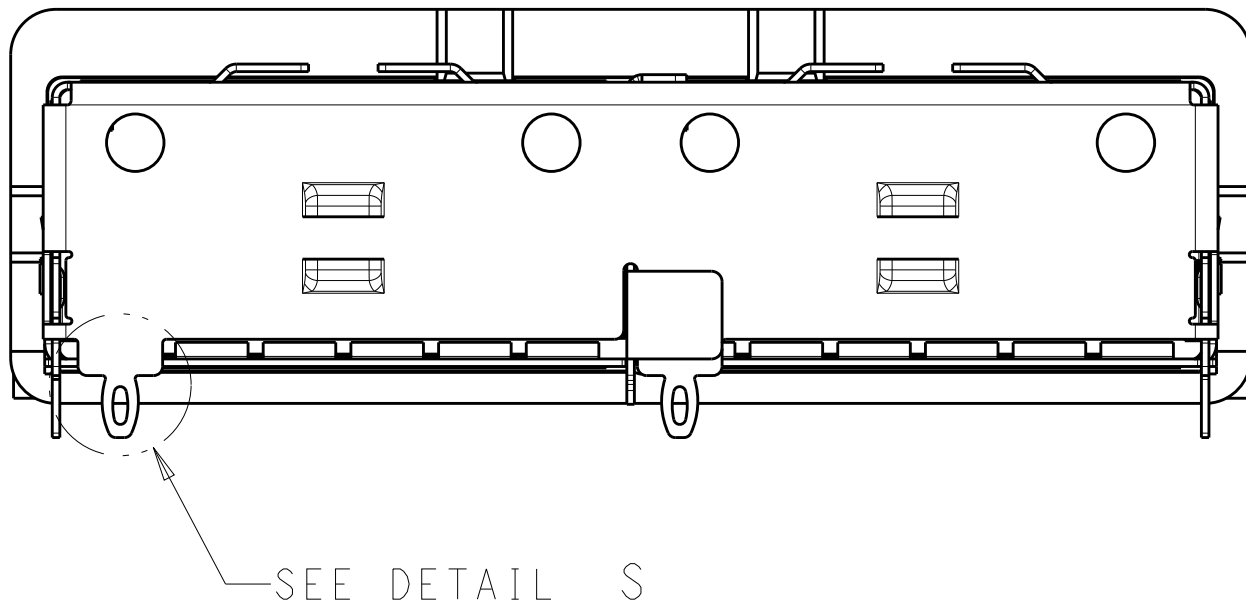
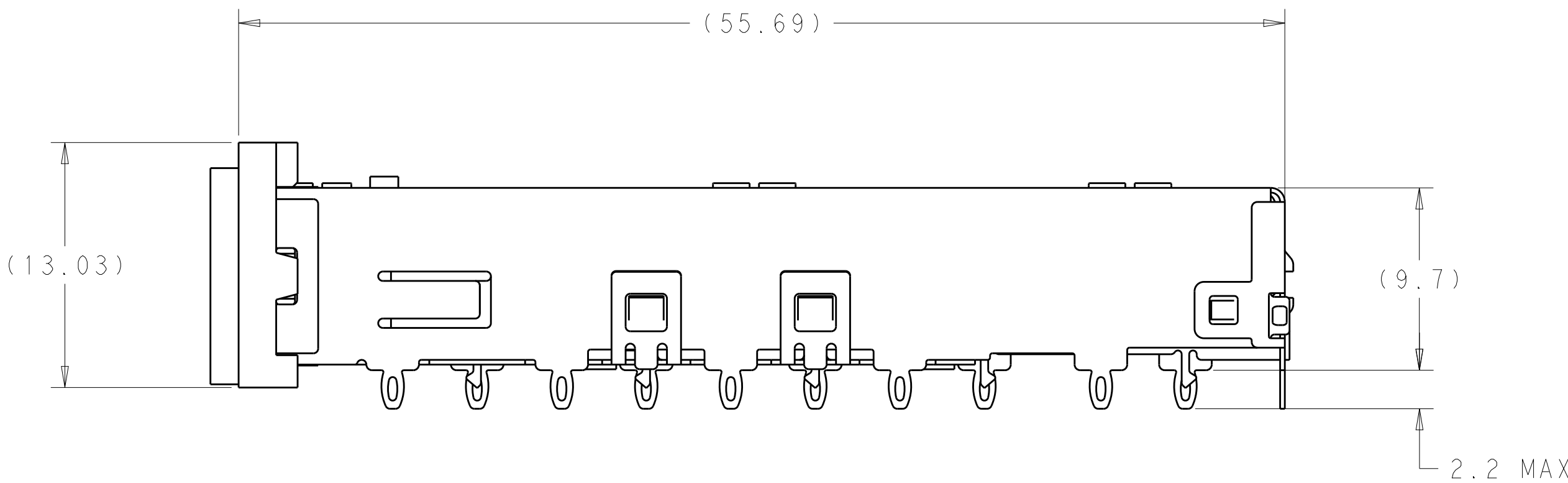
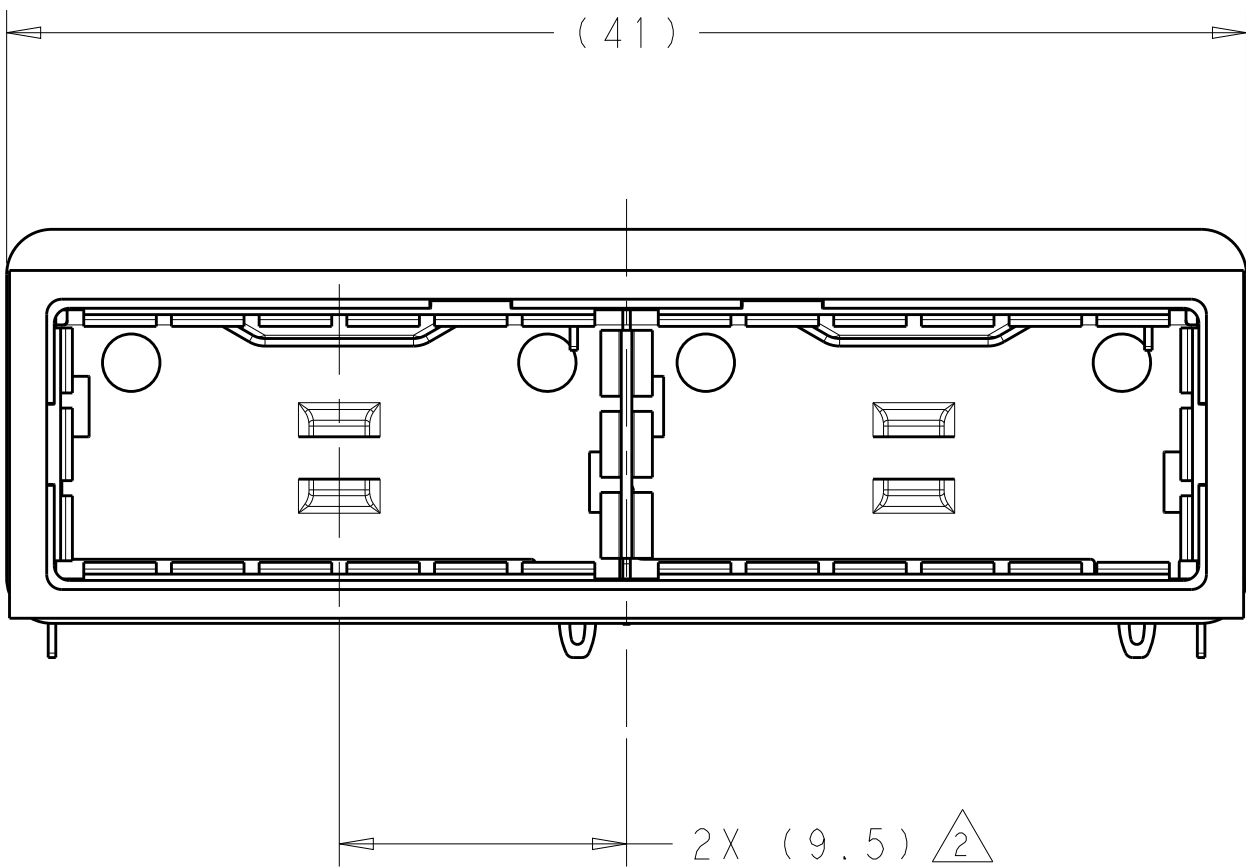

DETAIL S ⚠
SCALE 20:1

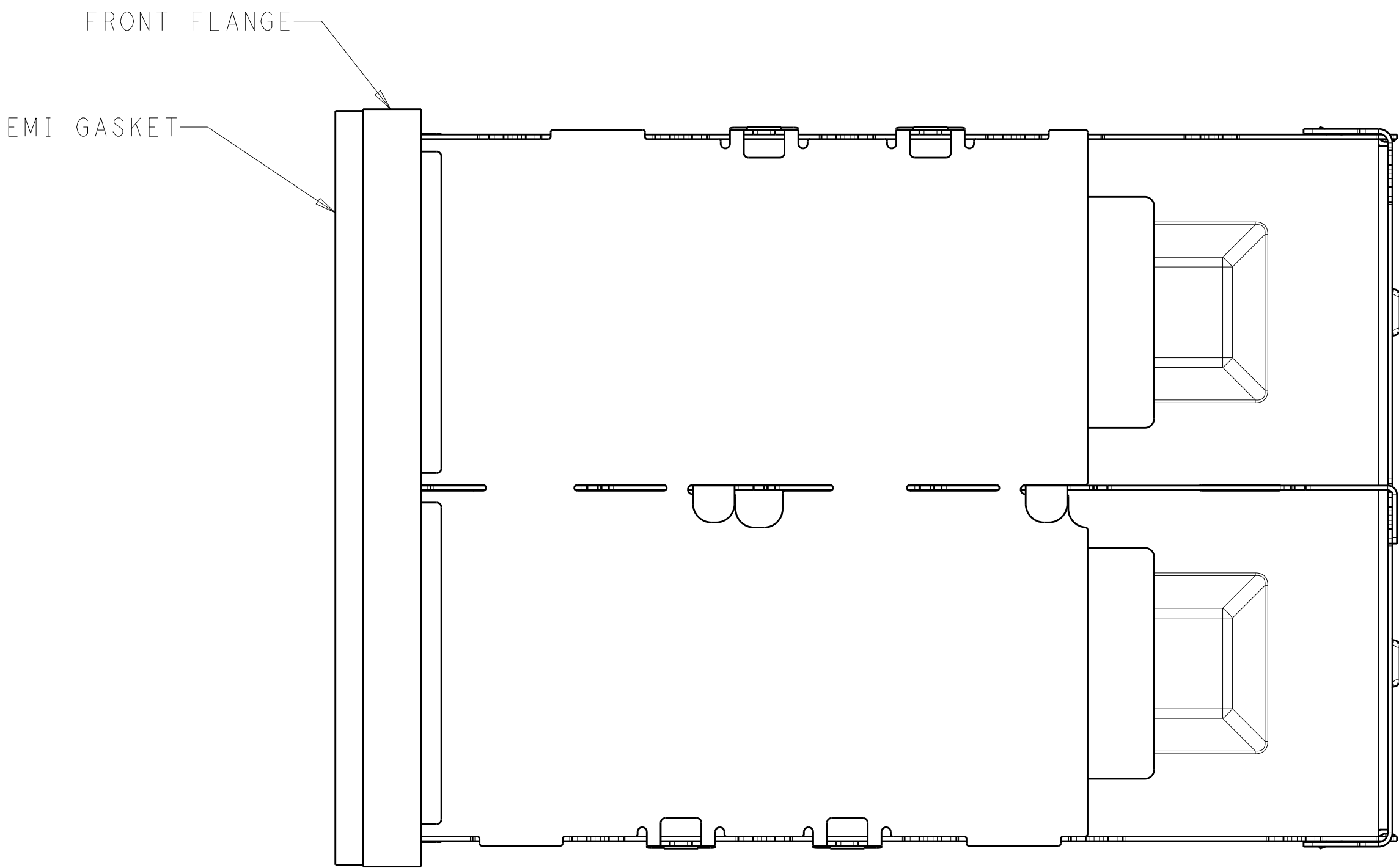

2274086-1
PART
NUMBER

THIS DRAWING IS A CONTROLLED DOCUMENT. DIMENSIONING AND TOLERANCING PER ASME Y14.5M-2009		DWN C. VALENTINE CHK E. BRIANT APVD E. BRIANT	27JUN2013 27JUN2013 27JUN2013	NAME		
DIMENSIONS: mm		TOLERANCES UNLESS OTHERWISE SPECIFIED:		PRODUCT SPEC		
0 PLC 1 PLC 2 PLC 3 PLC 4 PLC		± ±0.5 ±0.13 ± ±		APPLICATION SPEC		
ANGLES FINISH		± ±		114-32023		
MATERIAL		WEIGHT		A100779C=2274086		
CUSTOMER DRAWING		SCALE 4:1		SHEET 1 OF 4		



TE Connectivity

1X2 CAGE ASSEMBLY, BEHIND BEZEL,
CONDUCTIVE GASKET, zQSFP+

RESTRICTED TO
-
REV A

LOC		DIST		REVISIONS			
P	LTR	DESCRIPTION		DATE	DWN	APVD	
-		SEE SHEET 1		-	-	-	

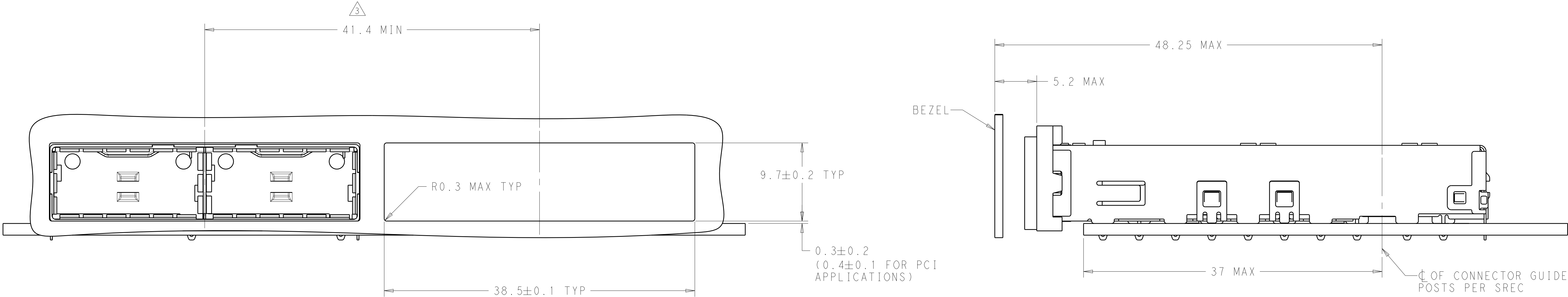

ONE-SIDED CONFIGURATION

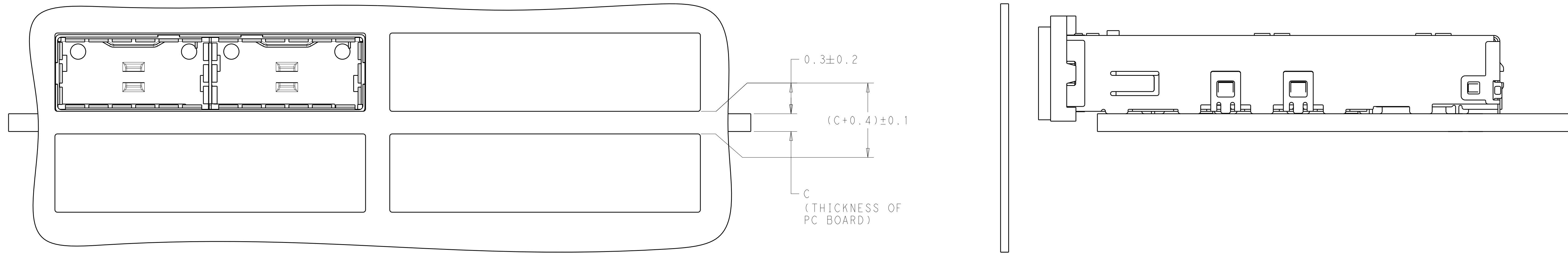

BELLY TO BELLY CONFIGURATION SIMILAR TO ONE SIDED EXCEPT WHERE NOTED

THIS DRAWING IS A CONTROLLED DOCUMENT. DIMENSIONING AND TOLERANCING PER ASME Y14.5M-2009		DWN C. VALENTINE 27JUN2013	TE Connectivity	
DIMENSIONS:		CHK E. BRIANT 27JUN2013	NAME	
mm		APVD E. BRIANT 27JUN2013	1X2 CAGE ASSEMBLY, BEHIND BEZEL, CONDUCTIVE GASKET, ZQSFP+	
TOLERANCES UNLESS OTHERWISE SPECIFIED:		PRODUCT SPEC	SIZE	
0 PLC ±.5		108-19428	A100779C=2274086	
1 PLC ±0.13		APPLICATION SPEC	SCALE	
2 PLC ±.		114-32023	4:1	
3 PLC ±.		WEIGHT	SHEET	
4 PLC ±.		CUSTOMER DRAWING	2 OF 4	
ANGLES			REV	
FINISH			A	

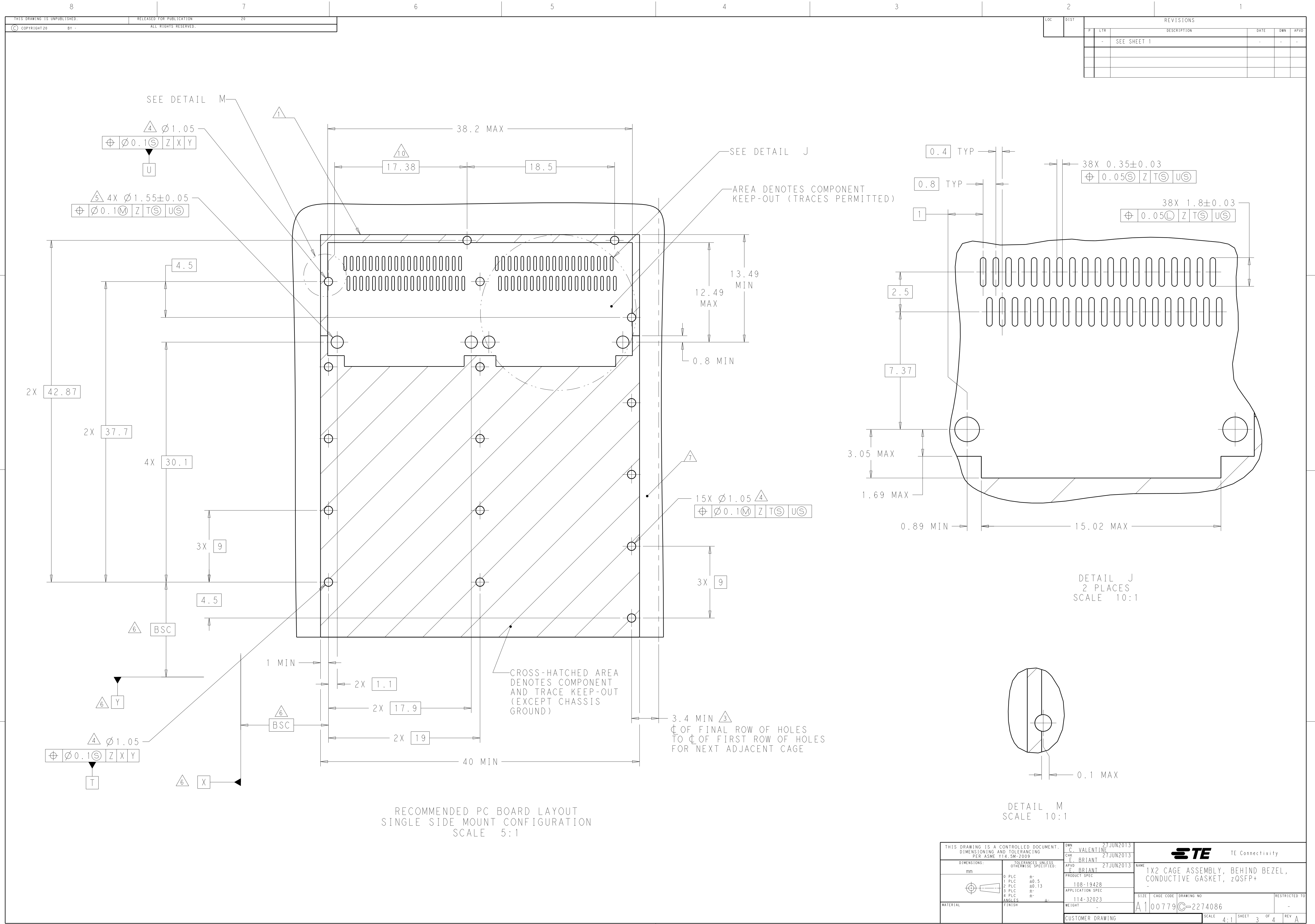

LOC		DIST		REVISIONS			
P	LTR	DESCRIPTION		DATE	DWN	APVD	
-	-	SEE SHEET 1		-	-	-	

THIS DRAWING IS A CONTROLLED DOCUMENT. DIMENSIONING AND TOLERANCING PER ASME Y14.5M-2009		DWN C. VALENTINE CHK E. BRIANT APVD F. BRIANT	27JUN2013 27JUN2013 27JUN2013	TE Connectivity	
DIMENSIONS: mm		TOLERANCES UNLESS OTHERWISE SPECIFIED:		NAME 1X2 CAGE ASSEMBLY, BEHIND BEZEL, CONDUCTIVE GASKET, zQSFP+	
0 PLC 1 PLC 2 PLC 3 PLC 4 PLC		± ±0.5 ±0.13 ± ±		PRODUCT SPEC 108-19428	
MATERIAL		FINISH		APPLICATION SPEC 114-32023	
				SIZE A100779	
				CAGE CODE C=2274086	
				RESTRICTED TO -	
				SCALE 4:1	
				SHEET 3 OF 4	
				REV A	

LOC		DIST		REVISIONS			
P	LTR	DESCRIPTION		DATE	DWN	APVD	
-	-	SEE SHEET 1		-	-	-	

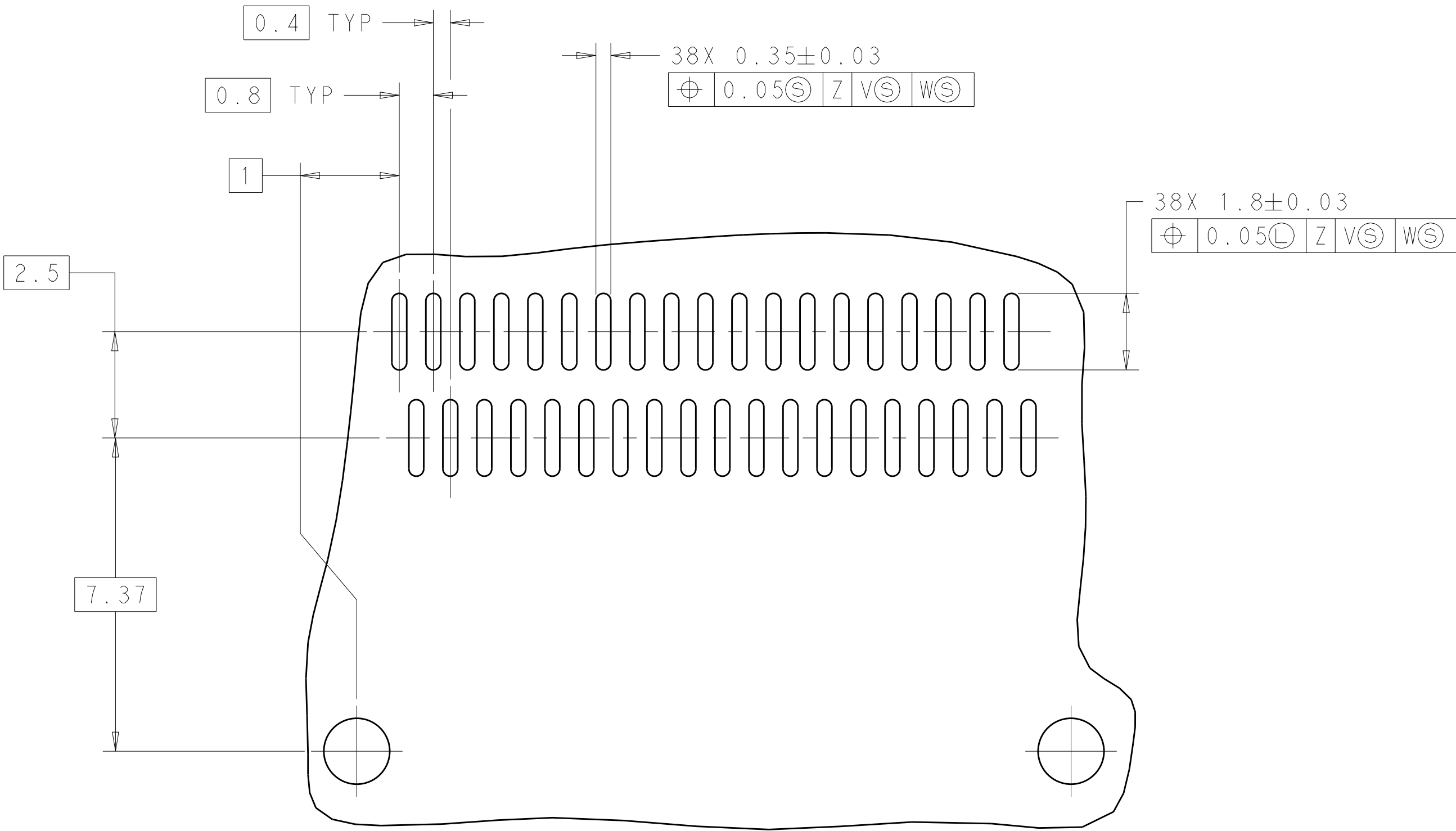
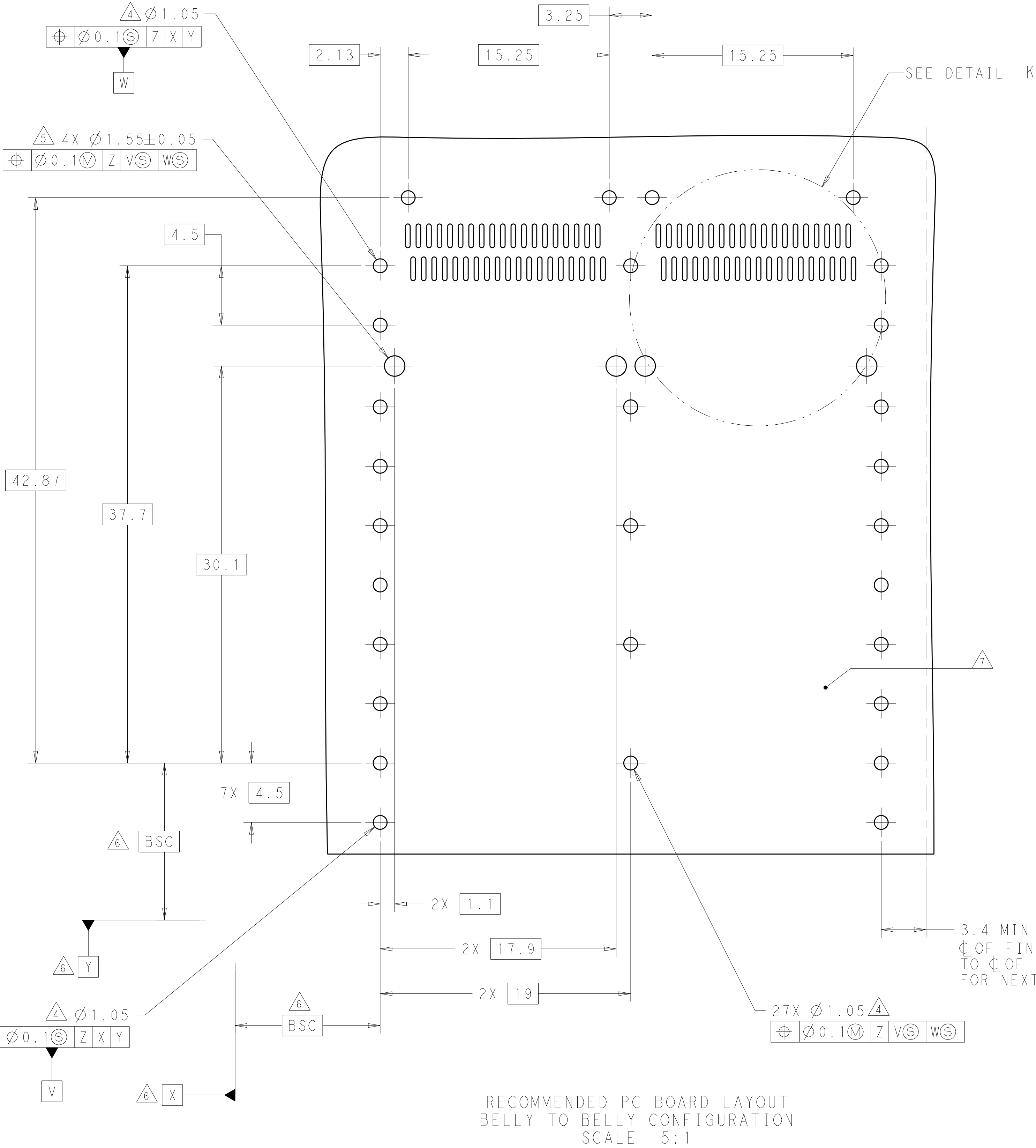

THIS DRAWING IS A CONTROLLED DOCUMENT. DIMENSIONING AND TOLERANCING PER ASME Y14.5M-2009		DWN C. VALENTINE CHK E. BRIANT APVD E. BRIANT	27JUN2013 27JUN2013 27JUN2013	NAME 1X2 CAGE ASSEMBLY, BEHIND BEZEL, CONDUCTIVE GASKET, zQSFp+	
DIMENSIONS: mm		TOLERANCES UNLESS OTHERWISE SPECIFIED:		SIZE A1	
0 PLC 1 PLC 2 PLC 3 PLC 4 PLC ANGLES FINISH		± ±0.5 ±0.13 ± ± ±		CAGE CODE 108-19428	
MATERIAL		APPLICATION SPEC 114-32023		DRAWING NO. C=2274086	
		WEIGHT -		RESTRICTED TO -	
		CUSTOMER DRAWING		SCALE 4:1	
				SHEET 4 OF 4	
				REV A	