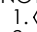

REVISION CG

NOTES:

1.  REPRESENTS A CRITICAL DIMENSION.
2. MEASURED AT BEND RADIUS, NOT AT END OF PIN.
3. TUBE ONLY -05 THROUGH -50 POSITIONS.
4. GOLD PLATING TO BE ON POST, TIN PLATING ON TAIL.
5. PARTS MAY BE CUT TO POSITION.
6. MINIMUM PUSHOUT FORCE: 1.0 LB.
7. SURFACE MOUNT TAILS TO BE SHEARED TO DIMENSION ON STYLE -05 ONLY.
8. DUE TO THE HIGH AMOUNT OF INSERTION FORCE NEEDED, THE -LC OPTION IS NOT COMPATIBLE WITH AUTO PLACEMENT. SAMTEC RECOMMENDS MANUAL PLACEMENT FOR ALL ASSEMBLIES WITH THE -LC, -EC, -EBC AND -EPC OPTIONS.

DO NOT
SCALE FROM
THIS PRINT

TMMH-1XX-XX-XX-DV-XXX-XX

No OF POS
-02 THRU -50
(PER ROW)

LEAD STYLE

-01: .126 [3.20]
(USE T-1S13-07-XX-2)
-04: .075 [1.91]
(USE T-1S13-04-XX-2)
-05: .065 [1.65] MIN
(USE T-1S13-20-XX-2)

PLATING

-L: 15μ" LIGHT SELECTIVE GOLD IN CONTACT AREA, MATTE TIN ON TAIL
-F: 3μ" FLASH GOLD IN CONTACT AREA, MATTE TIN ON TAIL
-S: 30μ" SELECTIVE GOLD IN CONTACT AREA, MATTE TIN ON TAIL
-G: 20μ" GOLD IN CONTACT AREA, 3μ" MIN GOLD ON TAIL
-T: MATTE TIN ON CONTACT AND TAIL
-H: 30μ" HEAVY GOLD IN CONTACT AREA, 3μ" MIN GOLD ON TAIL
-TM: MATTE TIN CONTACT AND TAIL
-LM: 15μ" LIGHT SELECTIVE GOLD IN CONTACT AREA, MATTE TIN ON TAIL
-SM: 30μ" SELECTIVE GOLD IN CONTACT AREA, MATTE TIN ON TAIL
-FM: 3μ" FLASH SELECTIVE GOLD IN CONTACT AREA, MATTE TIN ON TAIL

OPTION

-TR: TAPE & REEL PACKAGING
(36 POS MAX CONTACT SAMTEC FOR LARGER POSITIONS)

OPTIONS **

-M: PICK & PLACE PAD (USE PPP-10)
(SEE FIG 3; 5 POS MIN)
-ES: END SHROUDS (SEE FIG 4, SHT 2, 9 POS MIN)
-EC: LOCKING CLIP (SEE FIG 6, SHT 3, 9 POS MIN, DO NOT USE WITH
-A OR -LC, SEE NOTE 8)
-EP: GUIDE POST (SEE FIG 9, SHT 4, 9 POS MIN)
-EL: BOARD LOCK (SEE FIG 5, SHT 3, 9 POS MIN)
-LC: FLEX MOLD LOCKING CLIP (USE LC-09-TM, SEE FIG 2, SHEET 2,
5 POS MIN, SEE NOTE 8)
-A: ALIGNMENT PIN (USE TMMH-50-D-A-XX, SEE FIG 2, SHEET 2
3 POS MIN)
-EBC: BOARD LOCK WITH LOCKING CLIP (SEE FIG 8 SHT 4, 9 POS MIN
NOT AVAILABLE WITH -A OR -LC, SEE NOTE 8)
-EPC: GUIDE POST WITH LOCKING CLIP (SEE FIG 7, SHT 3, 9 POS MIN
NOT AVAILABLE WITH -A OR -LC, SEE NOTE 8)
-XXX: POLARIZATION (SPECIFY POS -XXX TO BE OMITTED)

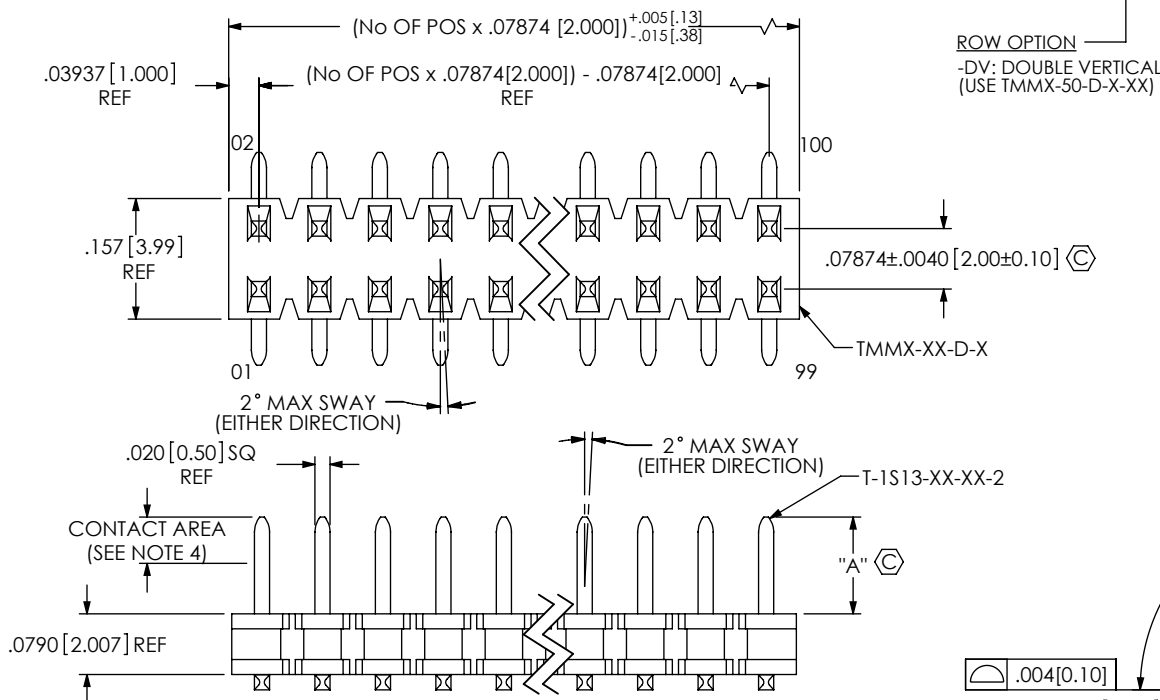

ROW OPTION

-DV: DOUBLE VERTICAL
(USE TMMX-50-D-X-XX)

** ALL OPTIONS EXCEPT THE -EX / -A / -LC OPTIONS
USE THE TMMC-50-D-X-XX
-EX / -A / -LC OPTIONS USE THE TMMH-50-D-XX-XX

TABLE 1

| STYLE | "A" | "B" | TERMINAL | "L" |
|-------|------------|------------|----------------|------------|
| -01 | .126[3.20] | .101[2.57] | T-1S13-07-XX-2 | .302[7.67] |
| -04 | .075[1.91] | .050[1.27] | T-1S13-04-XX-2 | .255[6.48] |
| -05 | .065[1.65] | .040[1.02] | T-1S13-20-XX-2 | .323[8.20] |

FIG 1
(TMMH-150-XX-XX-DV SHOWN)

CRITICAL DIMENSION INSPECTION INSTRUCTION TABLE

| ASSEMBLY OPERATION | IN-PROCESS INSPECTION |
|--------------------|-----------------------|
| FILL | C1 |
| REPRESS | C2 |

UNLESS OTHERWISE SPECIFIED,
DIMENSIONS ARE IN INCHES.

TOLERANCES ARE:

DECIMALS ANGLES
.XX: ±.01[0.3]
.XXX: ±.005[0.13]
.XXXX: ±.0020[0.051]

PROPRIETARY NOTE

THIS DOCUMENT CONTAINS CONFIDENTIAL AND
PROPRIETARY INFORMATION AND ALL DESIGN,
MANUFACTURING, REPRODUCTION, USE, PATENT RIGHTS
AND SALES RIGHTS ARE EXPRESSLY RESERVED BY SAMTEC,
INC. THIS DOCUMENT SHALL NOT BE DISCLOSED, IN WHOLE
OR PART, TO ANY UNAUTHORIZED PERSON OR ENTITY NOR
REPRODUCED, TRANSFERRED OR INCORPORATED IN ANY
OTHER PROJECT IN ANY MANNER WITHOUT THE EXPRESS
WRITTEN CONSENT OF SAMTEC, INC.

MATERIAL:
BODIES:
LCP, UL 94 VO
COLOR: BLACK
TERMINAL:
PHOSPHOR BRONZE, ALLOY

MAX. CUT FLASH: .020 [.51]

DO NOT SCALE DRAWING

SHEET SCALE: 1:1

C:\EnterpriseVault\DWG\MISC\MKTG\TMMH-1XX-XX-XX-DV-XXX-XX-MKT.SLDDRW

samtec

520 PARK EAST BLVD, NEW ALBANY, IN 47150
PHONE: 812-944-6733 FAX: 812-948-5047
e-Mail: info@SAMTEC.com code 53322

DESCRIPTION:

2MM X 2MM TERMINAL STRIP ASSEMBLY

DWG. NO.

TMMH-1XX-XX-XX-DV-XXX-XX-ASM

BY: PURVIS

10/08/1996

SHEET 1 OF 5

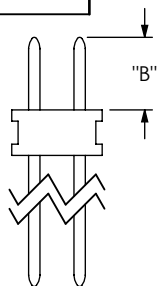

IN-PROCESS 1

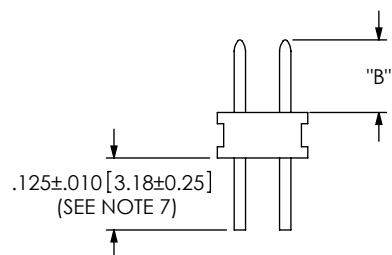

IN-PROCESS
FOR STYLE -05

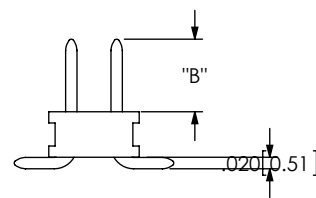

IN-PROCESS 3

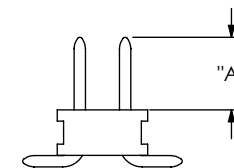

IN-PROCESS 4

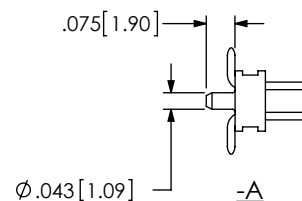
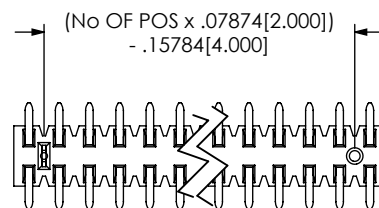
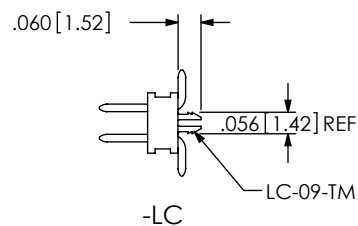

FIG 2
(DIFFERENT AS SHOWN,
OTHERWISE SAME AS FIG 1)

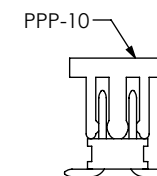
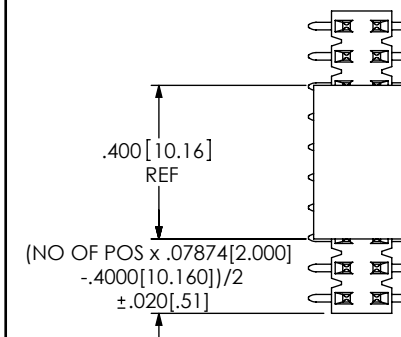
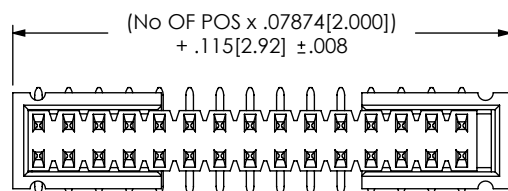

FIG 3
-M
(DIFFERENT AS SHOWN,
OTHERWISE SAME AS FIG 1)



| STYLE | "C" | "D" | SHROUD |
|-------|------------|------------|------------|
| -01 | .202[5.13] | .230[5.84] | TMMH-ES-01 |
| -04 | .149[3.78] | .177[4.50] | TMMH-ES-04 |
| -05 | .149[3.78] | .177[4.50] | TMMH-ES-04 |

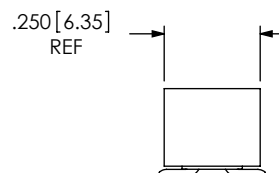
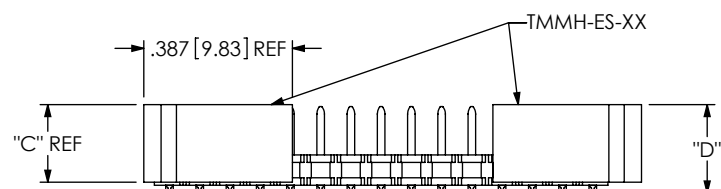

FIG 4
-ES
(DIFFERENT AS SHOWN,
OTHERWISE SAME AS FIG 1)

PROPRIETARY NOTE
THIS DOCUMENT CONTAINS CONFIDENTIAL AND PROPRIETARY INFORMATION AND ALL DESIGN, MANUFACTURING, REPRODUCTION, USE, PATENT RIGHTS AND SALES RIGHTS ARE EXPRESSLY RESERVED BY SAMTEC, INC. THIS DOCUMENT SHALL NOT BE DISCLOSED, IN WHOLE OR PART, TO ANY UNAUTHORIZED PERSON OR ENTITY NOR REPRODUCED, TRANSFERRED OR INCORPORATED IN ANY OTHER PROJECT IN ANY MANNER WITHOUT THE EXPRESS WRITTEN CONSENT OF SAMTEC, INC.

DO NOT SCALE DRAWING

samtec

520 PARK EAST BLVD, NEW ALBANY, IN 47150
PHONE: 812-944-6733 FAX: 812-948-5047
e-Mail: info@SAMTEC.com code 55322

DESCRIPTION:
2MM X 2MM TERMINAL STRIP ASSEMBLY

DWG. NO.
TMMH-1XX-XX-XX-DV-XXX-XX-ASM

BY: PURVIS 10/08/1996 SHEET 2 OF 5

| STYLE | "E" | "F" | SHROUD |
|-------|------------|------------|------------|
| -01 | .202[5.13] | .230[5.84] | TMMH-EL-01 |
| -04 | .149[3.78] | .177[4.50] | TMMH-EL-04 |
| -05 | .149[3.78] | .177[4.50] | TMMH-EL-04 |

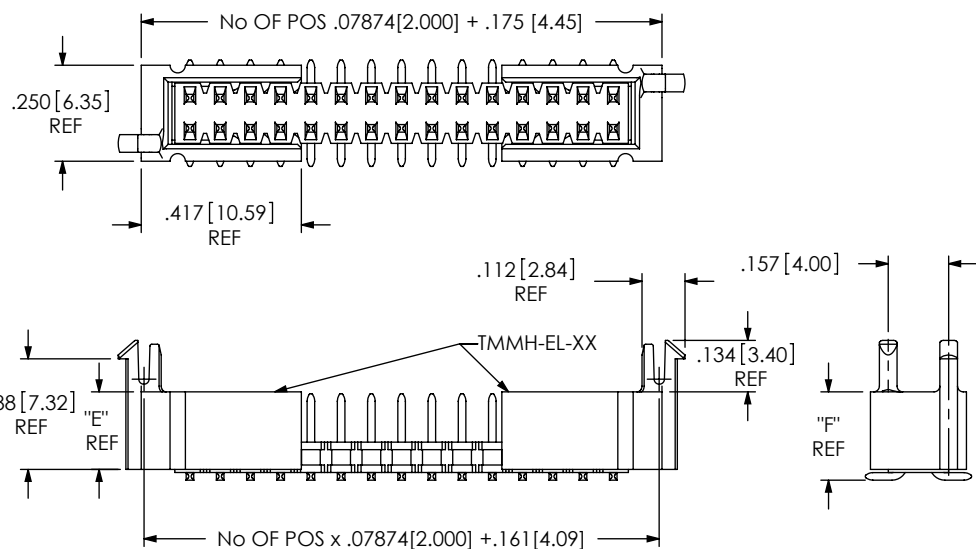

FIG 5
-EL

(DIFFERENT AS SHOWN,
OTHERWISE SAME AS FIG 1)

| STYLE | "J" | "K" | SHROUD |
|-------|------------|------------|------------|
| -01 | .202[5.13] | .230[5.84] | TMMH-EC-01 |
| -04 | .149[3.78] | .177[4.50] | TMMH-EC-04 |
| -05 | .149[3.78] | .177[4.50] | TMMH-EC-04 |

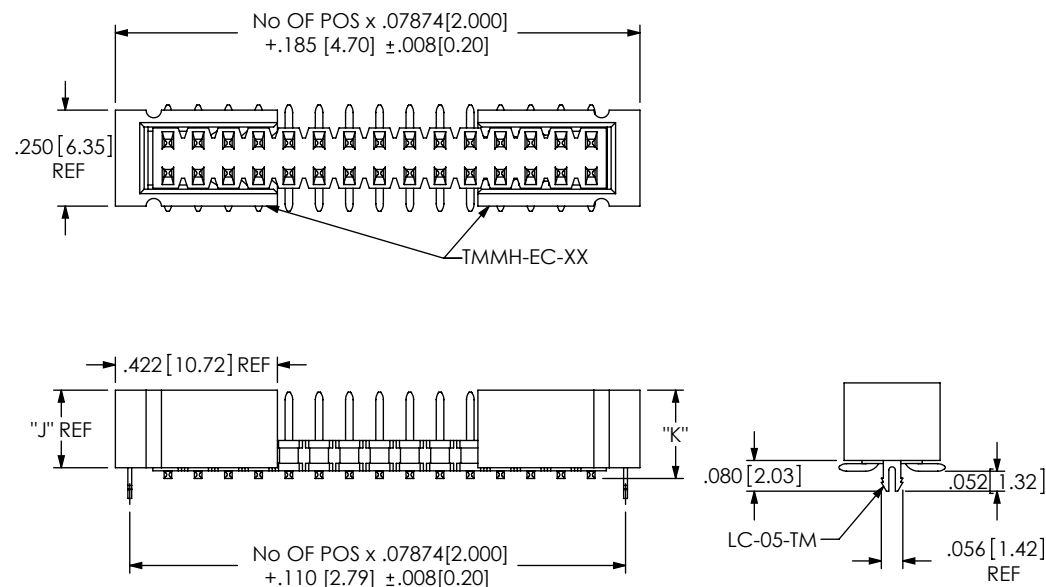

FIG 6
-EC

(DIFFERENT AS SHOWN,
OTHERWISE SAME AS FIG 1)

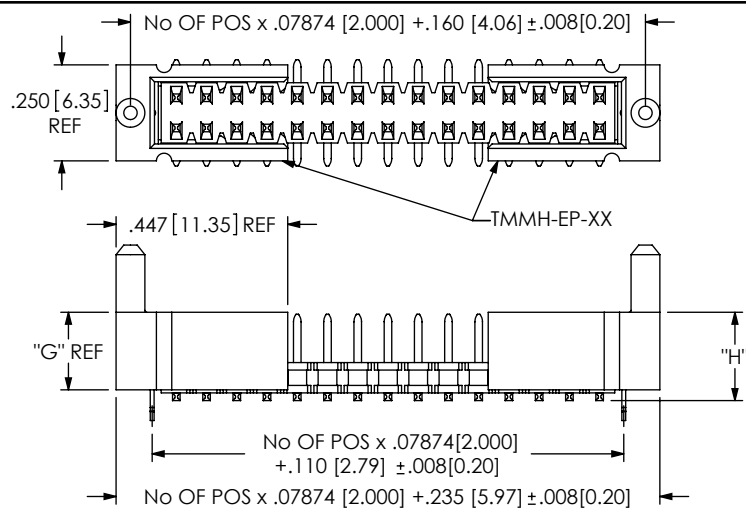
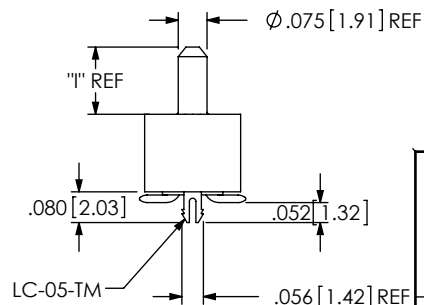

FIG 7
-EPC

(DIFFERENT AS SHOWN,
OTHERWISE SAME AS FIG 1)

| STYLE | "G" | "H" | "I" | SHROUD |
|-------|------------|------------|------------|------------|
| -01 | .202[5.13] | .230[5.84] | .175[4.45] | TMMH-EP-01 |
| -04 | .149[3.78] | .177[4.50] | .119[3.02] | TMMH-EP-04 |
| -05 | .149[3.78] | .177[4.50] | .119[3.02] | TMMH-EP-04 |



PROPRIETARY NOTE
THIS DOCUMENT CONTAINS CONFIDENTIAL AND PROPRIETARY INFORMATION AND ALL DESIGN, MANUFACTURING, REPRODUCTION, USE, PATENT RIGHTS AND SALES RIGHTS ARE EXPRESSLY RESERVED BY SAMTEC, INC. THIS DOCUMENT SHALL NOT BE DISCLOSED, IN WHOLE OR PART, TO ANY UNAUTHORIZED PERSON OR ENTITY NOR REPRODUCED, TRANSFERRED OR INCORPORATED IN ANY OTHER PROJECT IN ANY MANNER WITHOUT THE EXPRESS WRITTEN CONSENT OF SAMTEC, INC.

SHEET SCALE: 2:1

samtec

520 PARK EAST BLVD, NEW ALBANY, IN 47150
PHONE: 812-944-6733 FAX: 812-948-5047
e-Mail: info@SAMTEC.com code 55322

DESCRIPTION:
2MM X 2MM TERMINAL STRIP ASSEMBLY

DWG. NO.
TMMH-1XX-XX-XX-DV-XXX-XX-ASM

BY: PURVIS 10/08/1996 SHEET 3 OF 5

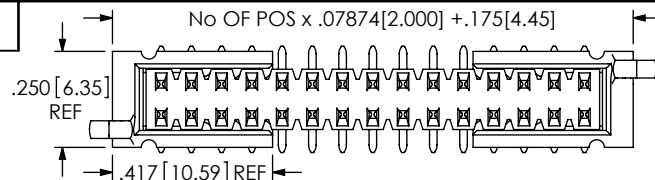

| STYLE | "E" | "F" | SHROUD |
|-------|------------|------------|------------|
| -01 | .202[5.13] | .230[5.84] | TMMH-EL-01 |
| -04 | .149[3.78] | .177[4.50] | TMMH-EL-04 |
| -05 | .149[3.78] | .177[4.50] | TMMH-EL-04 |

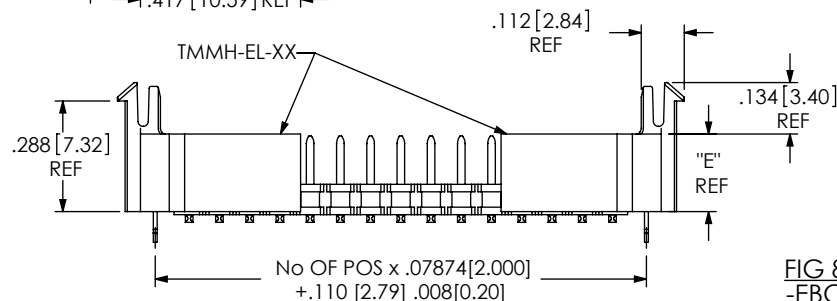
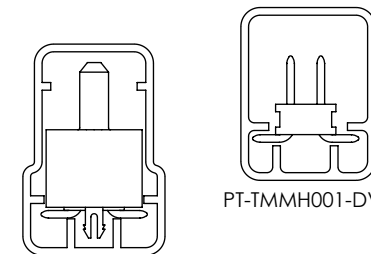
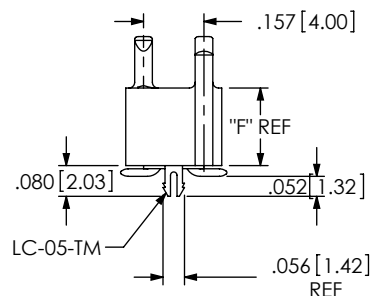
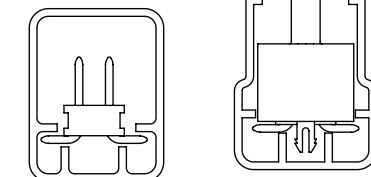

FIG 8
-EBC
(DIFFERENT AS SHOWN,
OTHERWISE SAME AS FIG 1)



PT-TMMH001-DV-P

PT-TMMH002-DV-EX-P



PT-TMMH001-DV-P PT-TMMH002-DV-EX-P

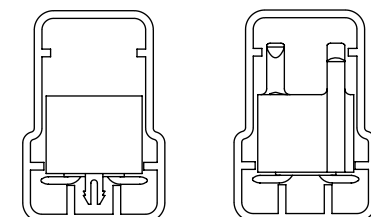

PT-TMMH002-DV-EX-P PT-TMMH002-DV-EX-P

PACKAGING VIEW

| | | |
|---|--------------------|-------|
| NONE, -A, -LC -M, -A-M -LC-M | PT-TMMH001-DV-P | TP-09 |
| -EL-LC -EPC-M -EP-LC -ES, -EC -ES-A, -ES-LC -EL, -EL-M, -EL-A -EP, -EPC, -EBC, -EP-A-M -EP-A, -EC-M -ES-M, -ES-A-M -ES-LC-M | PT-TMMH002-DV-EX-P | TP-03 |

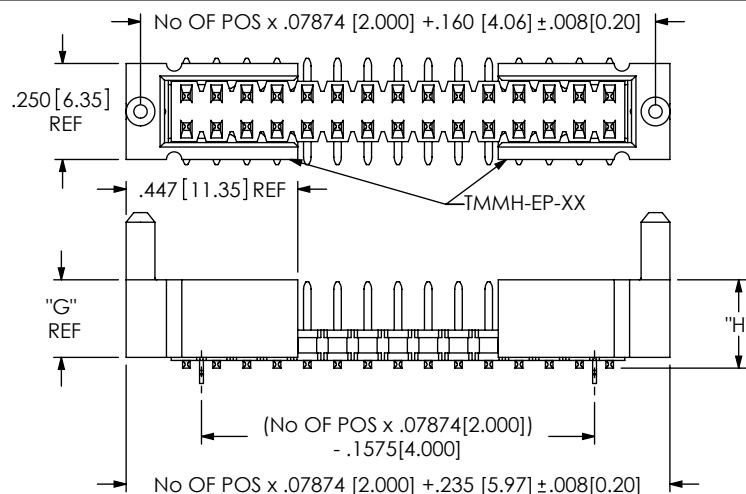

| STYLE | "G" | "H" | "I" | SHROUD |
|-------|------------|------------|------------|------------|
| -01 | .202[5.13] | .230[5.84] | .175[4.45] | TMMH-EP-01 |
| -04 | .149[3.78] | .177[4.50] | .119[3.02] | TMMH-EP-04 |
| -05 | .149[3.78] | .177[4.50] | .119[3.02] | TMMH-EP-04 |

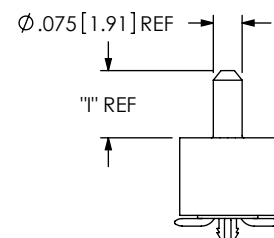

FIG 9
-EP-LC
(DIFFERENT AS SHOWN,
OTHERWISE SAME AS FIG 2)

| STYLE | "G" | "H" | "I" | SHROUD |
|-------|------------|------------|------------|------------|
| -01 | .202[5.13] | .230[5.84] | .175[4.45] | TMMH-EP-01 |
| -04 | .149[3.78] | .177[4.50] | .119[3.02] | TMMH-EP-04 |
| -05 | .149[3.78] | .177[4.50] | .119[3.02] | TMMH-EP-04 |

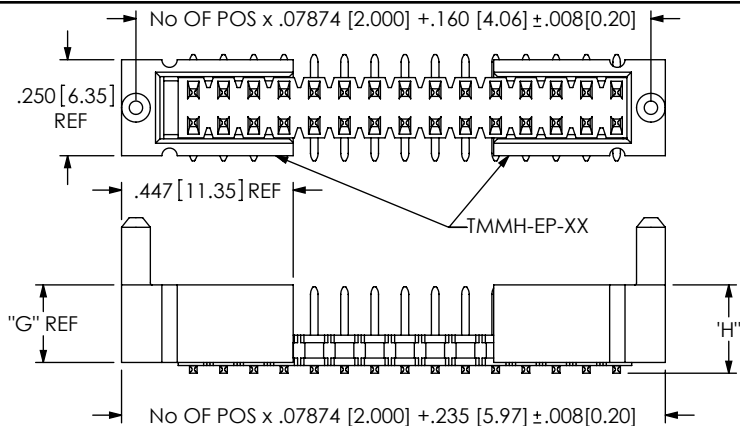
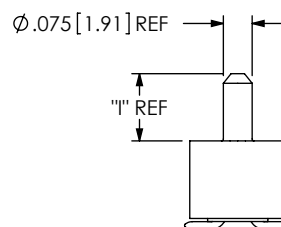

FIG 10
-EP
(DIFFERENT AS SHOWN,
OTHERWISE SAME AS FIG 1)

C:\EnterpriseVault\DWG\MISC\MKTG\TMMH-1XX-XX-XX-DV-XXX-XX-MKT.SLDDRW

* PROPRIETARY NOTE *

THIS DOCUMENT CONTAINS CONFIDENTIAL AND PROPRIETARY INFORMATION AND ALL DESIGN, MANUFACTURING, REPRODUCTION, USE, PATENT RIGHTS AND SALES RIGHTS ARE EXPRESSLY RESERVED BY SAMTEC, INC. THIS DOCUMENT SHALL NOT BE DISCLOSED, IN WHOLE OR PART, TO ANY UNAUTHORIZED PERSON OR ENTITY NOR REPRODUCED, TRANSFERRED OR INCORPORATED IN ANY OTHER PROJECT IN ANY MANNER WITHOUT THE EXPRESS WRITTEN CONSENT OF SAMTEC, INC.

SHEET SCALE: 2:1

samtec

520 PARK EAST BLVD, NEW ALBANY, IN 47150
PHONE: 812-944-6733 FAX: 812-948-5047
e-Mail: info@SAMTEC.com code 55322

DESCRIPTION:
2MM X 2MM TERMINAL STRIP ASSEMBLY

DWG. NO.
TMMH-1XX-XX-XX-DV-XXX-XX-ASM

BY: PURVIS 10/08/1996 SHEET 4 OF 5

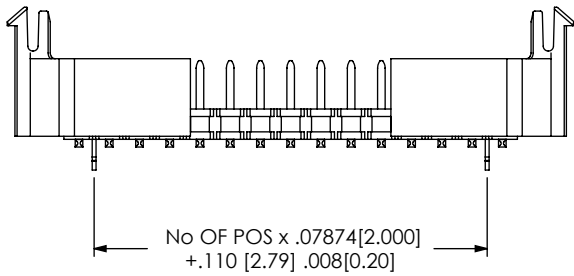

FIG 11
-EL-LC
(DIFFERENT AS SHOWN,
OTHERWISE SAME AS FIG 8)

* PROPRIETARY NOTE *

THIS DOCUMENT CONTAINS CONFIDENTIAL AND PROPRIETARY INFORMATION AND ALL DESIGN, MANUFACTURING, REPRODUCTION, USE, PATENT RIGHTS AND SALES RIGHTS ARE EXPRESSLY RESERVED BY SAMTEC, INC. THIS DOCUMENT SHALL NOT BE DISCLOSED, IN WHOLE OR PART, TO ANY UNAUTHORIZED PERSON OR ENTITY NOR REPRODUCED, TRANSFERRED OR INCORPORATED IN ANY OTHER PROJECT IN ANY MANNER WITHOUT THE EXPRESS WRITTEN CONSENT OF SAMTEC, INC.

samtec

520 PARK EAST BLVD, NEW ALBANY, IN 47150
PHONE: 812-944-6733 FAX: 812-948-5047
e-Mail info@SAMTEC.com code 55322

SHEET SCALE: 2:1

DESCRIPTION:
2MM X 2MM TERMINAL STRIP ASSEMBLY

DWG. NO.
TMMH-1XX-XX-XX-DV-XXX-XX-ASM

BY: PURVIS 10/08/1996 SHEET 5 OF 5