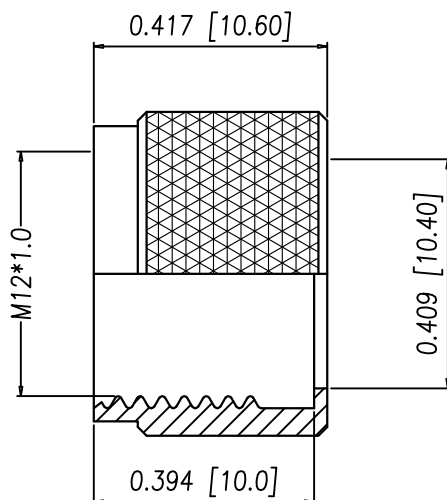
NUT

## NOTE:

## MATERIAL

HOUSING:

CONTACT:

NUT:

O-RING:

SHELL:

## FINISH

CONTACT:

NUT:

SHELL:

## ELECTRICAL

RATED CURRENT:

RATED VOLTAGE:

WATER PROOF:

WIRE AWG:

## ENVIRONMENT

OPERATION TEMPERATURE:

PA66 UL94V-0, BLACK

BRASS

BRASS

EPDM

BRASS

10u" GOLD PLATED

OVER NICKEL

NICKEL PLATED

BRIGHT TIN PLATED

16A

63V

IP67

14 AWG MAX

-40°C TO +85°C

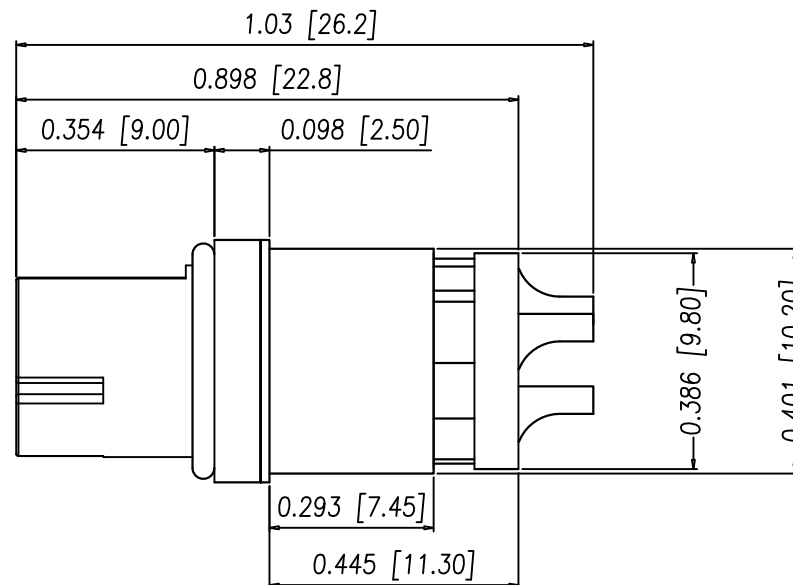
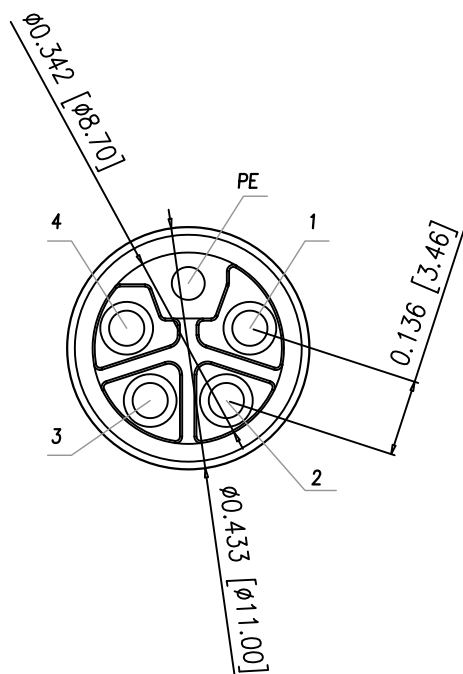

858-LP5-203RLSY

3 = BRASS/TIN (B/T) SHELL & NUT  
 S = STAINLESS STEEL (SS) SHELL & NUT  
 T = B/T SHELL & SS NUT

1 = GOLD FLASH  
 4 = 10u" GOLD

RoHS COMPLIANT

UNITS = INCHES [MM]

DO NOT SCALE FROM DRAWING



THESE DRAWINGS AND SPECIFICATIONS ARE THE PROPERTY OF NorComp AND SHALL NOT BE REPRODUCED, COPIED OR USED AS THE BASIS FOR THE MANUFACTURE OR SALE OF APPARATUS WITHOUT WRITTEN PERMISSION.

DRAWN:

J. KADEL

DATE:

08/01/2018

NorComp

SCALE:

NTS

SHEET

OF

1

1

REV

5

DWG NO.

858-LP5-203RLS4