

NOTES:
1. ALL PARTS TO BE BULK PACKED.
2. SEE DRAWING HPMISTD FOR HOLE PATTERN.

ASSY P/N	CONTACT QTY.	"X" DIM.
7280-2PG-300	2 #20	0.653 [16.6mm]
7280-3PG-300	3 #20	0.670 [17.0mm]
7280-4PG-300	4 #20	0.670 [17.0mm]
7280-5PG-300	5 #20	0.670 [17.0mm]
7280-6PG-300	6 #20	0.670 [17.0mm]
7280-7PG-300	7 #20	0.673 [17.1mm]
7280-8PG-300	8 #20	0.673 [17.1mm]

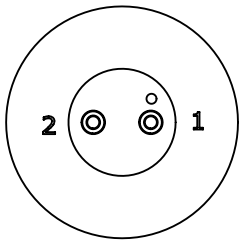

WIRING END
ASSY: 7280-2PG-300

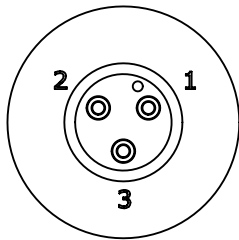

WIRING END
ASSY: 7280-3PG-300

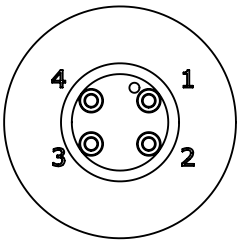

WIRING END
ASSY: 7280-4PG-300

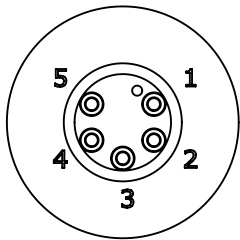

WIRING END
ASSY: 7280-5PG-300

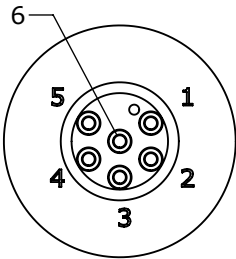

WIRING END
ASSY: 7280-6PG-300

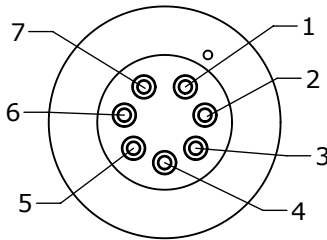

WIRING END
ASSY: 7280-7PG-300

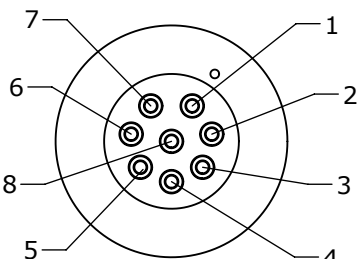

WIRING END
ASSY: 7280-8PG-300

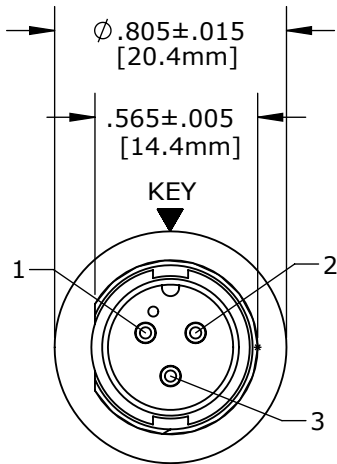

MATING FACE
ASSY: 7280-3PG-300 SHOWN

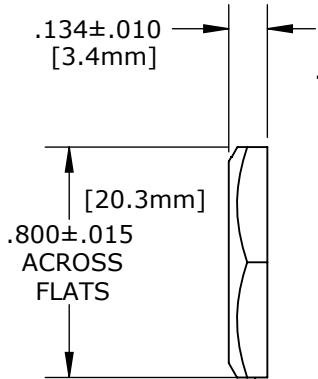

HEX NUT
MAT'L: NYLON, BLACK

.050 REF.
[1.3mm]

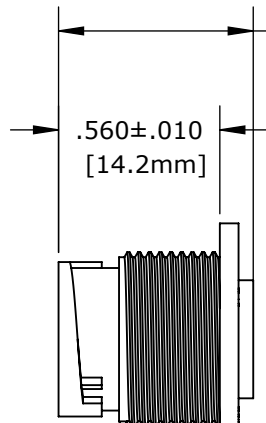

GASKET
MAT'L: RUBBER, BLACK

"X" DIM. ±.015
SEE CHART

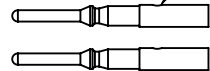

(2-8)-#20 PIN CONTACTS
CRIMP TAIL
MAT'L: GOLD PLATED
COPPER ALLOY

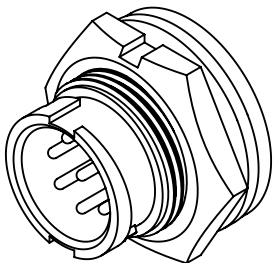

SHOWN ASSEMBLED KIT
FOR CUSTOMER REFERENCE ONLY

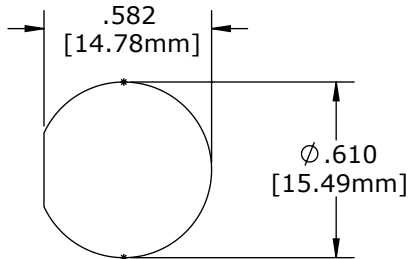

RECOMMENDED
PANEL CUT-OUT
TOLERANCE: ±.003

DIMENSIONS IN BRACKET [] ARE METRIC.

CUSTOMER APPROVAL	
THIS DOCUMENT CONTAINS CONFIDENTIAL INFORMATION PROPRIETARY TO CONXALL CORPORATION. ANY REPRODUCTION, DISCLOSURE, OR USE OF THIS DOCUMENT /INFORMATION IS EXPRESSLY PROHIBITED UNLESS AUTHORIZED IN WRITING BY CONXALL CORPORATION.	
APPROVED BY:	_____
DATE:	_____

RoHS COMPLIANT

A	AN	08-09-11	DRAWING CREATED PER DOR 11-E149SL
REV.	INIT.	DATE	DESCRIPTION
	AN	08-08-11	ORIG. DRAWN BY: DATE: 08-08-11
ALL INFORMATION ILLUSTRATED IS THE PROPERTY OF CONXALL CORPORATION. UNAUTHORIZED DUPLICATION OR DISTRIBUTION OF THIS DOCUMENT IS PROHIBITED.			conxall 601 E. WILDWOOD VILLA PARK, IL 60181
CHECKED BY:			
ALL UNITS ARE IN FEET, INCHES, FRACTION OF INCHES AND DECIMALS.			TITLE: PANEL MOUNT ASSEMBLY (2-8) #20 PIN CONTACTS MINI-CON-X
APPROVED BY:			CUSTOMER: STANDARD PRODUCT
SCALE	SIZE	SHEET	
NTS	B	1 OF 1	
FILE:	DIRECTORY:	PART NUMBER:	REV
7280-XPG-300	SLW	7280-XPG-300	A